



SJPC 24-32
REQUEST FOR SEALED BID PROPOSALS
CRANE INSPECTIONS, MAINTENANCE, AND REPAIRS
BALZANO AND BROADWAY MARINE TERMINALS

SCOPE OF WORK AND EXHIBITS

SOUTH JERSEY PORT CORPORATION
2 Aquarium Drive, Suite 100
Camden, NJ 08103

SJPC 24-32
REQUEST FOR SEALED BID PROPOSALS
CRANE INSPECTIONS, MAINTENANCE, AND REPAIRS
BALZANO AND BROADWAY MARINE TERMINALS

SCOPE OF WORK AND EXHIBITS

Background

The South Jersey Port Corporation (SJPC - Owner), owns and operates two Kocks gantry cranes located at their two terminals in Camden, New Jersey. The cranes are used predominately for the transfer of bulk cargo and scrap metal between ship and shore. Both cranes are vital to the port's operation and receive regular inspections and routine preventative maintenance.

Balzano Marine Terminal Crane No 73904

This rail mounted diesel powered crane was installed at Berth 4 in 1982. Recent operator safety inspections revealed movement in the boom hinges and the upper, middle, and lower forestay pins. The boom hinge and fore stay pins, sleeves, and bushings were evaluated and found to need replacement. The original equipment manufacturer, Kocks Kranbau, Germany, will provide the replacement parts and oversee the installation.

Broadway Crane No 71038

This rail mounted electric powered crane was installed in 2005 at Pier 1A to handle bulk cement slag imports. The slew bearings above the trolley house allow the trolley house to rotate 360 degrees. These slew bearings are deteriorated and the planetary gear which is used to rotate the trolley house is missing teeth.

To make repairs, the whole structure of the trolley machine house will be supported with controlled lifting and lowering, to make space for replacing the slewing bearings and planetary gear. The original equipment manufacturer, Kocks Kranbau, Germany, will provide the replacement parts and oversee the installation.

Contract

The contract resulting from this solicitation will consist of two parts.

First, the construction services to perform the two specific projects above, which will occur over an approximately 4-to-6 week period beginning on or about March 31, 2025, and,

Second, ongoing annual crane inspection, maintenance and repair services, which shall be for a one-year term with two optional one-year extensions. Renewal will be at the option of the SJPC / Owner.

Only one contract will be issued to one firm. The basis of selection will be on the lowest qualified bid total for the work on the two repair projects (Line 14 of the Bid Form).

Project Schedule

Exhibits E and F show the draft schedules for the two repair projects, each lasting approximately two weeks. Work six 10-hour days per week, Monday through Saturday. No work planned for Sundays or holidays. Work is scheduled over an approximately 4-to-6 week period beginning on or about March 31, 2025.

Sequence of Work

Exhibits G and H are Responsibility Matrices for the two repair projects, listing all of the steps in order for each project. All work will be performed under the direction of Kocks' lead technician, who will be on-site during the two projects.

At this time, it has not been determined which crane repair project will be the first. That determination will be made by SJPC based on forecast shipping schedules as the work start date approaches.

Bid Form Description of Payment Items

The descriptions of work to be included with each bid form payment item are as follows:

Item 1 - Mobilization (Broadway Marine Terminal)

The mobilization at the Broadway Marine Terminal shall include all costs to transport the necessary tools, materials and equipment, etc. (excluding the high reach crane) to the port terminal and the subsequent demobilization from the port upon completion of all repair work and commissioning of the crane for service. Payment for Item 1 shall be on a lump sum basis.

Item 2 - Rental of High Reach Crane (Broadway Marine Terminal)

The rental of the high reach crane shall include transport to the port, crane erection, placement of counterweights, crane operators and support personnel, fuel and maintenance for the period of time the crane is in service to support the Kocks harbor crane repair work. Dismantling and removal from the site is also included. Payment for Item 2 shall be on a lump sum basis.

Item 3 – Labor for Slew Bearings and Planetary Gear Replacement (Broadway Marine Terminal)

Include all technical and support labor, and supervision to perform all services to replace the slew bearings and planetary gear on the Kocks crane at the Broadway Marine Terminal. Full description of services shall include, but not be limited to, the work breakdown provided in the responsibility matrix (Exhibit H). Kocks, Kranbau, Germany personnel will oversee the repair work and perform final commissioning acceptance of the repair work. Payment for Item 3 shall be based on the hourly rates for the actual labor used on a not to exceed basis.

Item 4 – Tools, Equipment & Materials for Slew Bearings and Planetary Gear Replacement (Broadway Marine Terminal)

Include all tools, equipment, and materials to perform all services to replace the slew bearings and planetary gear on the Kocks crane at the Broadway Marine Terminal. Full description of services shall include, but not be limited to, the work breakdown provided in the responsibility matrix (Exhibit H). Kock, Kranbau, Germany personnel will oversee the repair work and perform final commissioning acceptance of the repair work. Payment for Item 4 shall be on a lump sum basis.

Item 5 – Total Cost for Broadway Project Repairs

Total cost shall be the sum of Items 1 through 4.

Item 6 - Mobilization (Balzano Marine Terminal)

The mobilization at the Broadway Marine Terminal shall include all costs to transport the necessary tools, materials and equipment, etc. (excluding the high reach crane) to the port terminal and the subsequent demobilization from the port upon completion of all repair work and commissioning of the crane for service. Payment for Item 6 shall be a lump sum.

Item 7 - Rental of High Reach Crane (Balzano Marine Terminal)

The rental of the high reach crane shall include transport to the port, crane erection, placement of counterweights, crane operators and support personnel, fuel and maintenance for the period of time the crane is in service to support the Kocks harbor crane repair work. Dismantling and removal from the site is also included. Payment for Item 7 shall be on a lump sum basis.

Item 8 – Construction of Personnel Scaffolding

Provide all material and installation of personnel scaffolding to access the hinges and stay pins. Upon completion of all repairs to the Kock crane, remove the scaffolding. Payment for Item 8 shall be on a lump sum basis.

Item 9 – Labor for Boom Hinge and Fore Stay Pins Replacement (Balzano Marine Terminal)

Include all technical and support labor, and supervision to perform all services to replace the boom hinge and forestay pins on the Kocks crane at the Broadway Marine Terminal. The full description of services shall include, but not be limited to, the work

breakdown provided in the responsibility matrix (Exhibit G). Kocks, Kranbau, Germany personnel will oversee the repair work and perform final commissioning acceptance of the repair work. Payment for Item 9 shall be based on the hourly rates for the actual labor used on a not to exceed basis.

Item 10 – Tools, Equipment & Materials for Boom Hinge and Stay Pins Replacement (Balzano Marine Terminal)

Include all tools, equipment, and materials to perform all services to replace the boom hinge and stay pins on the Kocks crane at the Broadway Marine Terminal. The full description of services shall include, but not be limited to, the work breakdown provided in the responsibility matrix (Exhibit G). Kocks, Kranbau, Germany personnel will oversee the repair work and perform final commissioning acceptance of the repair work. Payment for Item 10 shall be on a lump sum basis.

Item 11 – Total Cost for Balzano Project Repairs
Total cost shall be the sum of Items 6 through 10.

Item 12 – Owner’s Allowance for Unforeseen Work on Replacement Projects
This is an allowance item to cover any unforeseen conditions identified during the repair work, if and were directed by the Owner.

Item 13 - Owner’s Allowance for Special Environmental Demolition and Disposal of Asbestos, Oils, or Lead
This is an allowance item to cover any special environmental demolition and disposal of hazardous materials, asbestos, oils, or lead that may be encountered during the repair work, if and were directed by the Owner.

Item 14 - Total Cost for Broadway Project Repairs
Total cost shall be the sum of Items 5, 11, 12, and 13.

Item 15 – Annual Inspection at Broadway
This item is for an annual crane inspection to include all electrical and electronics systems, cooling system, cables and sheaves, motors, moving parts, etc., with an inspection report at the conclusion of the inspection. Payment for Item 15 shall be on a lump sum basis.

Item 16 – Annual Inspection at Balzano
This item is for an annual crane inspection to include all electrical and electronics systems, cooling system, cables and sheaves, motors, moving parts, etc. with an inspection report at the conclusion of the inspection. Payment for Item 16 shall be on a lump sum basis.

Item 17 – Owner’s Allowance for Maintenance and Emergency Repairs
This is an allowance item for maintenance and emergency repair work if and where directed by the Owner.

Item 18 - Total Cost for Annual Inspections, Maintenance, and Repair Services
Total cost shall be the sum of Items 15 through 17.

Item 19 - Total Contract Amount
The sum of Item 14 and 18

Items 20 through 23
Under Items 20, 21, 22, and 23, provide the billing rates for mechanic, electrician, welder, and laborers, for an 8-hour day.

Item 24
Under Item 24, provide the standby per hour rate.

Prevailing Wage – All labor shall be paid at prevailing wages per New Jersey law.
The prevailing wage rate determination is attached as Exhibit “I”.

Certified Payroll – Be advised that certified payrolls must be submitted with the payment applications on this project.

List of Exhibits
Exhibit A - Balzano - Photo of pin locations
Exhibit B - Balzano - Names of hinges and pins
Exhibit C - Balzano Crane No 73904 scaffolding locations
Exhibit D - Broadway Crane No. 71038
Exhibit E - Balzano Draft Schedule
Exhibit F - Broadway Draft Schedule
Exhibit G - Balzano Responsibility Matrix
Exhibit H - Broadway Responsibility Matrix
Exhibit I - Prevailing Wage Rates

Exhibit A



**Balzano Marine Terminal
Kocks Crane Number 73904**

LOAD ON ROPES	SPEED
SKIP PAN OPERATION	135 FPM
CONTAINER OPERATION	120 FPM
4 ROPE BUCKET OPERATI IN	200 FPM
MAGNET OPERATION	210 FPM
HEAVY LIFT OPERATION	80 FPM

Exhibit B

**Tie Link
Upper Pin**

**Tie Link
Articulation Pin**

**Tie Link
Water Side Pin**

**Tie Link
Lower Pin**

**Boom Hinge
Pins on each side**

**KOCKS CRANE NO. 73904
Balzano Marine Terminal**

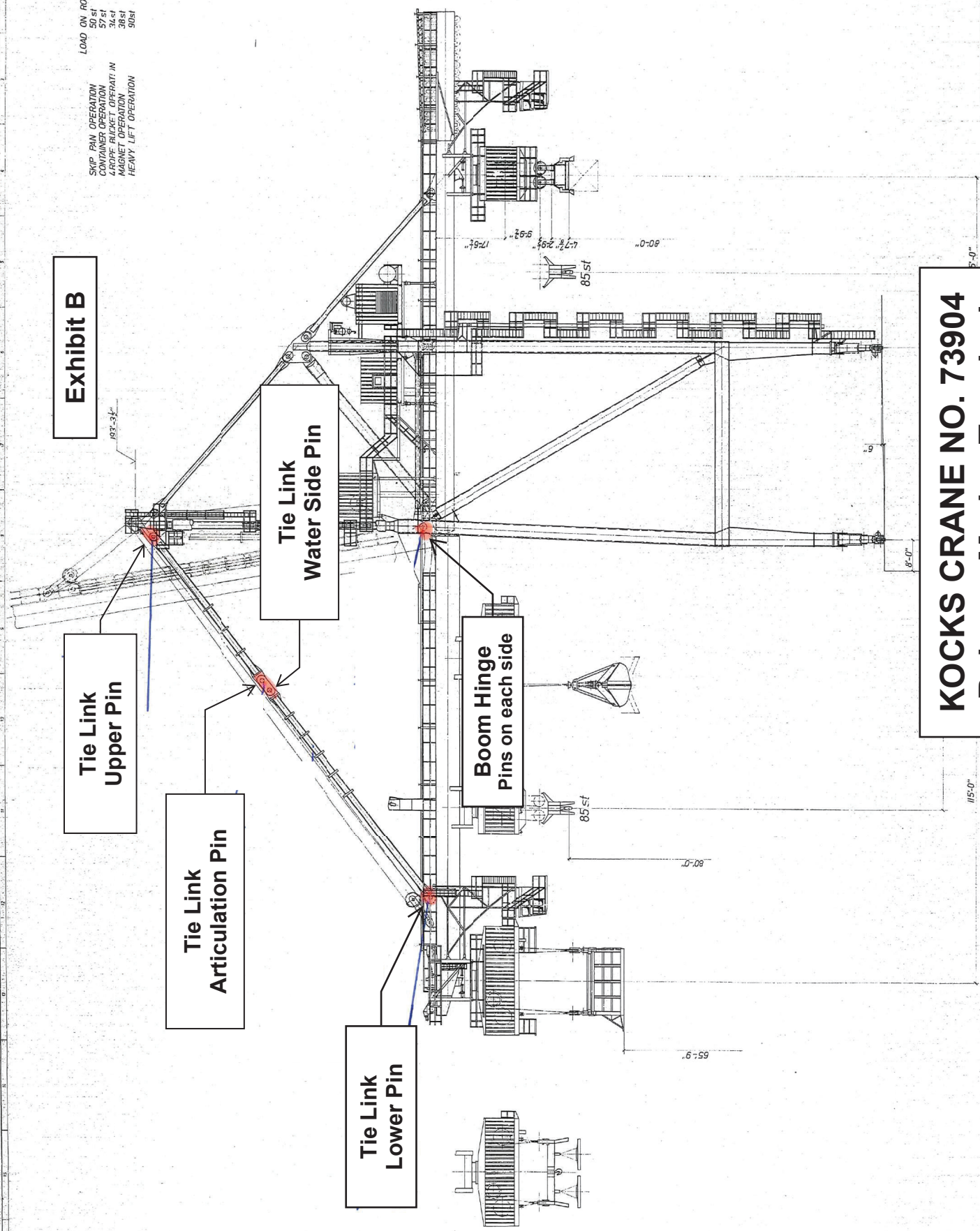

Exhibit C

LOAD ON ROPES	SPEED
50 st	105 FPM
57 st	120 FPM
34.5 st	230 FPM
38 st	210 FPM
50 st	80 FPM

SKIP PAN OPERATION	CONTAINER OPERATION
4 ROPE BUCKET OPERAT: IN	MAGNET OPERATION
HEAVY LIFT OPERATION	

Scaffolding Fore Stay Pins

Scaffolding Fore Stay Pins

Scaffolding Boom Hinge Pins One on each side

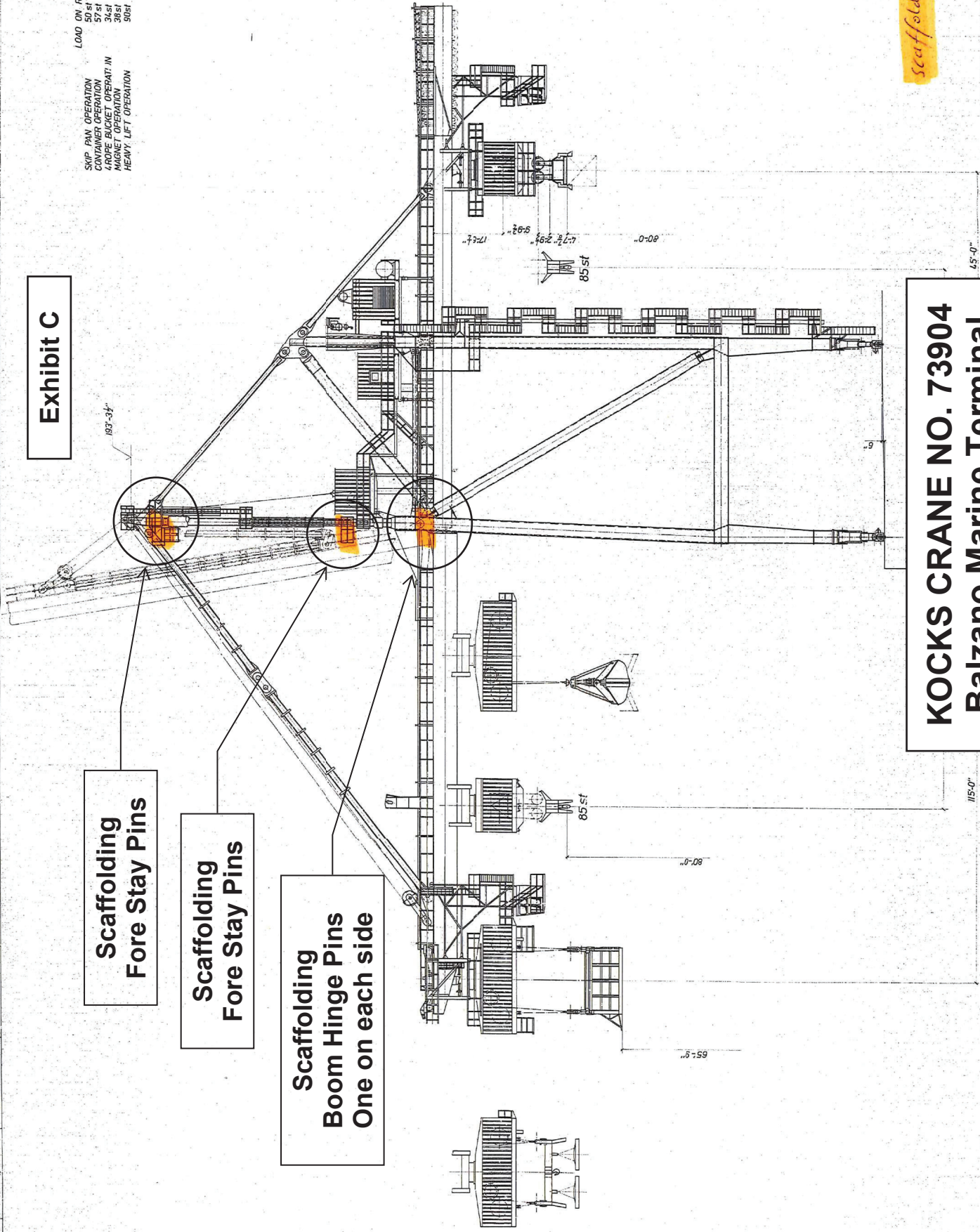

scaffolding

**KOCKS CRANE NO. 73904
Balzano Marine Terminal**

Submittal	KOCKS	1:00	A
DATE	01-05-02		
MULTI-PURPOSE-CRANE			

See Notes on Drawing for Details. Engineer's Access under Scaffolding. See Notes on Drawing for Details. Engineer's Access under Scaffolding.

Exhibit D

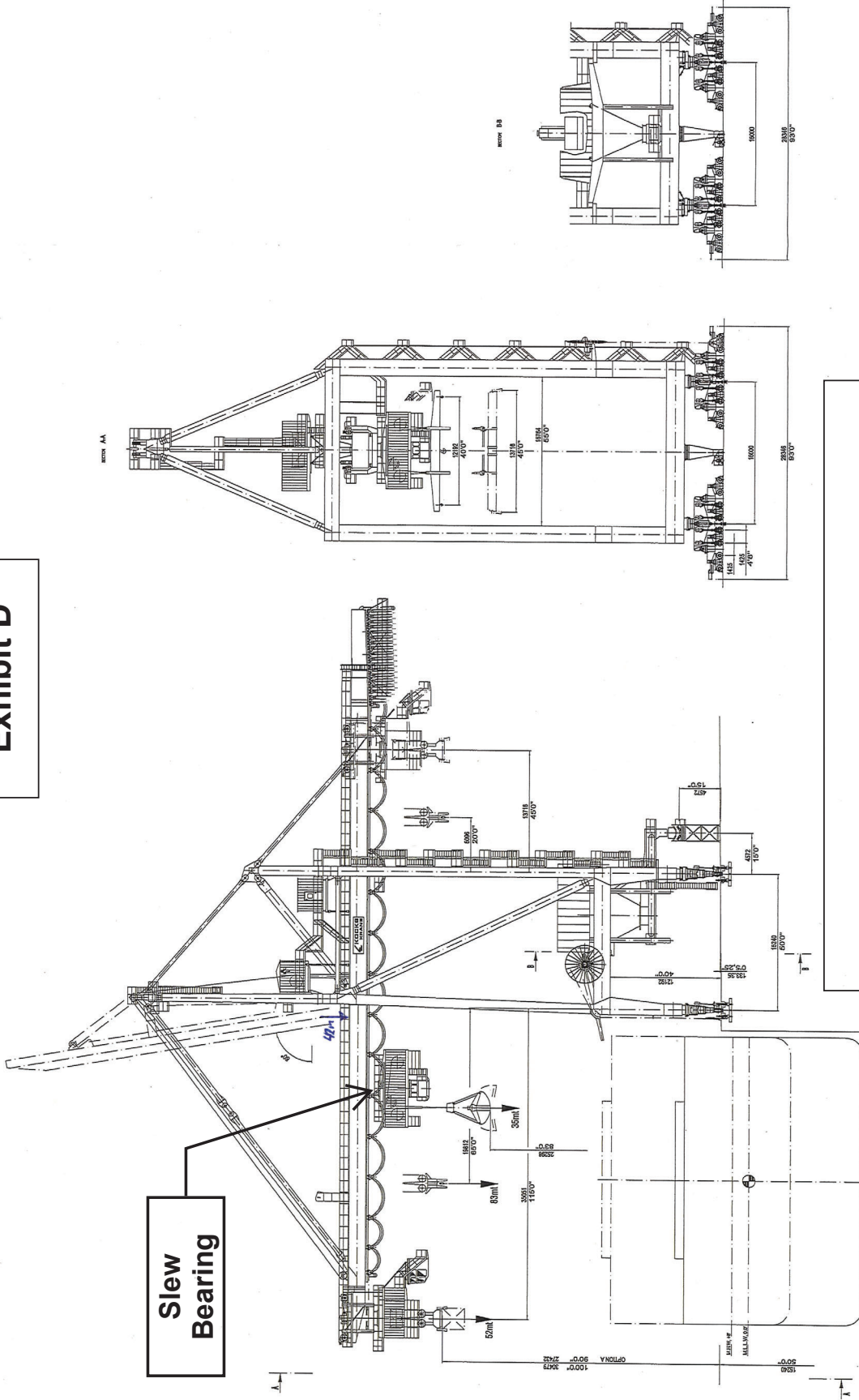

Slew Bearing

KOCKS CRANE NO. 71038
Broadway Marine Terminal

KOCKS CRANE NO. 71038		Scale: 1:500
MULTI-PURPOSE QUANTY CRANE		
BREMEN		
Project No.	Proj. No. 71038	Rev. 1
Drawn	01.06.2005	
Checked		
Approved		
Author		
Editor		
Reviewer		
Project Manager		

THIS DRAWING IS THE PROPERTY OF KOCKS & CO. GMBH. IT IS NOT TO BE REPRODUCED, COPIED, OR TRANSMITTED IN ANY FORM OR BY ANY MEANS, ELECTRONIC OR MECHANICAL, WITHOUT THE WRITTEN PERMISSION OF KOCKS & CO. GMBH. THE INFORMATION CONTAINED HEREIN IS NOT TO BE USED FOR ANY OTHER PURPOSES THAN THOSE SPECIFIED IN THIS DRAWING. THE USER OF THIS DRAWING IS RESPONSIBLE FOR OBTAINING ALL NECESSARY PERMITS AND APPROVALS FROM THE LOCAL AUTHORITIES. KOCKS & CO. GMBH ASSUMES NO LIABILITY FOR DAMAGES OF ANY KIND, INCLUDING CONSEQUENTIAL DAMAGES, ARISING FROM THE USE OF THIS DRAWING.

Exhibit E DRAFT SCHEDULE

BALZANO CRANE No. 73904 - Replacing boom hinge points and fore stay pins

Project 62 2024 0298:

	Wee	KW 1							KW 2							KW 3							
		M	T	W	T	F	S	S	M	T	W	T	F	S	S	M	T	W	T	F	S	S	
1	Decommissioning of crane 73904	X	X	X	X	X	X	X	X	X	X	X	X	X	X								
2	Moving crane to the assembly site / scaffolding at attach both sides of the boom - done by SJP	X																					
3	Site accommodation / placing tools and materials on the boom		X																				
4	Welding of mounting brackets at boom and install hydraulic jacks			X	X																		
5	Dismantling the Hinge Points - mounting new Axle / Bushing / Cover Plates (side by side)				X	X		X	X														
6	Remove all Mounting Brackets - test run of boom hoist mechanism and trolley running behaviour								X														
7	Scaffolding at pylon and in the area tie rod lock - done by SJP															X							
8	Tie rod lock secure and catch and dismantle first bolt and bush / measure bore										X	X											
9	Mounting new bushes and bolt - same procedure for the 2nd bolt and 3rd bolt at boom										X	X											
10	Pull boom and secure tie rod lock - mounting new bush and bolt at pylon												X	X									
11	Lubrication, dismantle scaffolding and test run														X	X							
12	Clearing the site and departure																X						
	Notice: To fits the bushes of the tie rod / forstay it is necessary to cooled them with nitrogen. The nitrogen required for this is provided by the customer.																						

Remarks: We proceed from the fact that the holes must not be reworked. If the holes lined and spindle work may be required, it is extended by approx. 2 days

EXHIBIT F DRAFT SCHEDULE

Broadway Crane No. 71038 - Replacing slewing bearing at crane

Project 62 2024 0131:

Week	KW 1							KW 2							KW 3						
	M	T	W	T	F	S	S	M	T	W	D	F	S	S	M	T	W	D	F	S	S
1	X	X	X	X	X	X	X	X	X	X	X	X	X	X	X	X	X	X	X	X	X
2	X																				
3	X	X																			
4				X																	
5					X																
6						X															
7																X					
8															X	X					
9																	X	X			
10																			X		
11																				X	

EXHIBIT G
RESPONSIBILITY MATRIX
KOCKS CRANE 73904
BOOM HINGES & FORE STAY PINS REPLACEMENT
BALZANO MARINE TERMINAL

Item	Description of Work	Kocks	Support Contractor	SJPC
	FORE STAY PINS			
1	Provide, assemble, install the scaffolding in four locations (See attached drawing for scaffolding locations)		X	
2	Welding auxiliary eyes at the tie rod / tie rod lock and support them with chain hoists		X	
3	Remove the lower bolt from water side tie rod linkage.		X	
4	Dismantle old bushing, clean holes and bearings.		X	
5	Kocks to check holes for wear. If wear is found additional labor may apply to make repairs.	X	X	
6	Mounting of new bushings and axles.		X	
7	Pull boom and fit the lower and upper tie rod lock with new axles and bushings.		X	
8	Remove the pylon and the lower axles from the tie rod.		X	
9	Remove old bushings and clean holes and bearings.		X	
10	Kocks to check holes for wear. If wear is found additional labor may apply to make repairs.	X	X	
11	Remount pylon and lower pin of the tie rod with new bushings and axles.		X	
12	Lubricate and test run.		X	X
13	Removal of the auxiliary eyes and clean up.		X	X
	HINGE POINTS			
14	Installation of jacks to remove load from hinge points.	X	X	
15	Dismantle hinge points, mount new axles / bushings / cover plates and fastening materials.		X	
16	Remove mounting brackets, repair damaged paint areas and test-run boom hoist and trolley running behavior.		X	
17	Functionality test of the crane. Test run of the boom hoist mechanism and the trolley running behavior.		X	X
	GENERAL			
18	Provide a high reach crane to support the work (Note C)		X	
19	Provide nitrogen for fitting the bushings of the tie rod / forestay if it is necessary to cool them with nitrogen.		X	
20	Provide oxygen for oxygen lances in needed during pin removal.		X	
21	Provide mechanics, welder, laborer(s) as needed		X	
22	Provide port yard equipment to transport stored Kocks materials to the crane location			X
23	Provide office & change room for Kocks personnel			X
24	Provide crane operator for testing and commissioning			X
Notes a) All work will be performed under the direction of Kocks' lead technician. b) Scaffolding requirements by Kocks. c) High reach crane size (capacity, height & reach of crane) To Be Determined				

EXHIBIT H
RESPONSIBILITY MATRIX
KOCKS CRANE 71038
SLEWING BEARING & PLANETARY GEAR REPLACEMENT
BROADWAY MARINE TERMINAL

Item	Description of Work	Kocks	Support Contractor	SJPC
1	Disconnect all electrical wires and label them for later reconnection		X	X
2	Installation / welding of necessary lifting eyes and supporting slideway		X	
3	Disconnecting of the drive unit		X	
4	Dismantle the planet gear		X	
5	Dismantle the screws of the slewing ring and secure the rotating part		X	
6	Dismantle old slewing ring and cleaning the surface for the new slewing ring		X	
7	Mounting and aligning the new slewing bearing and bolt with defined torque		X	
8	Screw test to determine required torques on slew bearing.	X		
9	Mounting and aligning the new planet gear		X	
10	Connecting of the drive unit		X	
11	Dismantle the supporting slideway		X	
12	Reconnect all wiring		X	X
13	Lubrication and test run of the slewing bearing		X	X
14	Site removal / waste removal		X	X
	GENERAL			
15	Provide a high reach crane to support the work. (Note B)		X	
16	Provide 2 mechanics, 1 welder, laborer(s) as needed		X	
17	Provide electrician as needed.		X	
	Provide port yard equipment to transport stored Kocks materials to the crane location			X
	Provide office & change room for Kocks personnel			X
	Provide crane operator for testing and commissioning			X
	Provide grease and oil for the planetary gear.			X

Notes: a) All work will be performed under the direction of Kocks' lead technician.

b) The crane required for the slewing bearing replacement must have a minimum hook height of approximately 55 meters (180 FEET, approx. 15 meters higher than the upper edge of the boom), and be able to carry a load of 5 tons.

c) No scaffolding is required at this crane



Exhibit I

STATE OF NEW JERSEY
Department of Labor and Workforce Development
Division of Wage and Hour Compliance - Public Contracts Section
PO Box 389
Trenton, NJ 08625-0389

PREVAILING WAGE RATE DETERMINATION

The New Jersey Prevailing Wage Act (N.J.S.A. 34:11-56.25 et seq.) requires that the Department of Labor and Workforce Development establish and enforce a prevailing wage level for workers engaged in public works in order to safeguard their efficiency and general well being and to protect them as well as their employers from the effects of serious and unfair competition.

Prevailing wage rates are wage and fringe benefit rates based on the collective bargaining agreements established for a particular craft or trade in the locality in which the public work is performed. In New Jersey, these rates vary by county and by the type of work performed.

Applicable prevailing wage rates are those wages and fringe benefits in effect on the date the contract is awarded. All pre-determined rate increases listed at the time the contract is awarded must also be paid, beginning on the dates specified. Rates that have expired will remain in effect until new rates are posted.

Prevailing Wage Rate

The prevailing wage rate for each craft will list the effective date of the rate and the following information:

W = Wage Rate per Hour **B** = Fringe Benefit Rate per Hour* **T** = Total Rate per Hour

* Fringe benefits are an integral part of the prevailing wage rate. Employers not providing such benefits must pay the fringe benefit amount directly to the employee each payday. Employers providing benefits worth less than the fringe benefit amount must pay the balance directly to the employee each payday.

Unless otherwise stated in the Prevailing Wage Rate Determination, the fringe benefit rate for overtime hours remains at the straight time rate.

When the Overtime Notes in the Prevailing Wage Rate Determination state that the overtime rates are "inclusive of benefits," the benefit rate is increased by the same factor as the wage rate (i.e. multiplied by 1.5 for time and one-half, multiplied by 2 for double time, etc.).

Apprentice Rate Schedule

An "apprentice" is an individual who is registered with the United States Department of Labor - Office of Apprenticeship and enrolled in a certified apprenticeship program during the period in which they are working on the public works project.

The apprentice wage rate is a percentage of the journeyman wage rate, unless otherwise indicated. The apprentice benefit rate is the full journeyman benefit rate, unless otherwise indicated.

If there is no apprentice rate schedule listed, the individual must be paid at least the journeyman rate even if that individual is in a certified apprentice program for that trade.

If there is no ratio of apprentices to journeymen listed for a particular craft, then the ratio shall be one (1) apprentice to every four (4) journeymen.

Comments/Notes

For each craft listed there will be comments/notes that cover the definition of the regular workday, shift differentials, overtime, recognized holidays, and any other relevant information.

Public Works Contractor Registration

The Public Works Contractor Registration Act (N.J.S.A. 34:11-56.48, et seq.) requires that **all** contractors, subcontractors, or lower tier subcontractors who are working on or who bid on public works projects register with the Department of Labor and Workforce Development. Applications are available at www.nj.gov/labor (click on Wage & Hour and then go to Registration & Permits).

Pursuant to N.J.S.A. 34:11-56.51:

No contractor shall bid on any contract for public work as defined in section 2 of P.L.1963, c. 150 (C.34:11-56.26) unless the contractor is registered pursuant to this act. No contractor shall list a subcontractor in a bid proposal for the contract unless the subcontractor is registered pursuant to P.L.1999, c.238 (C.34:11-56.48 et seq.) at the time the bid is made. No contractor or subcontractor, including a subcontractor not listed in the bid proposal, shall engage in the performance of any public work subject to the contract, unless the contractor or subcontractor is registered pursuant to that act.

Snow Plowing

Snow plowing contracts are not subject to the New Jersey Prevailing Wage Act or the Public Works Contractor Registration Act.

**NEW JERSEY DEPARTMENT OF LABOR AND WORKFORCE DEVELOPMENT
PREVAILING WAGE RATE DETERMINATION**

County - CAMDEN

Craft: Air Conditioning & Refrigeration - Service and Repair

PREVAILING WAGE RATE

	03/01/24
Journeyman (Mechanic)	W45.23 B30.03 T75.26

Craft: Air Conditioning & Refrigeration - Service and Repair

APPRENTICE RATE SCHEDULE

INTERVAL	PERIOD AND RATES									
As Shown	1st Year	2nd Year	3rd Year	4th Year	5th Year	Wage = %	of Jnymn	Wage		
Wage and Bene	40%	50%	60%	70%	80%	Bene = %	of Jnymn	Bene		

Ratio of Apprentices to Journeymen - 1:4

Craft: Air Conditioning & Refrigeration - Service and Repair

COMMENTS/NOTES

THESE RATES MAY BE USED FOR THE FOLLOWING:

- Service/Repair/Maintenance Work to EXISTING facilities.
- Replacement or Installation of air conditioning and refrigeration equipment when the combined tonnage does not exceed 15 tons for refrigeration, or 25 tons for air conditioning.
- Replacement or Installation of "packaged" or "unitary" rooftop-type units when the combined tonnage of the units does not exceed 75 tons.

NOTE: These rates may NOT be used for any work in new construction (including work on new additions).

The regular workday shall consist of 8 hours, starting between 6:00 AM and 10:00 AM, Monday through Friday.

SHIFT DIFFERENTIALS:

- The second and third shifts shall be paid an additional 15% of the hourly rate.
- All shifts must run for a minimum of 5 consecutive days.

OVERTIME:

Hours worked in excess of 8 per day or before or after the regular workday, that are not shift work, and all hours on Saturday shall be paid at time and one-half the hourly rate, inclusive of benefits. All hours on Sunday and holidays shall be paid at double the hourly rate, inclusive of benefits.

RECOGNIZED HOLIDAYS: New Year's Day, Presidents' Day, Memorial Day, July 4th, Labor Day, Veterans' Day, Thanksgiving Day, Christmas Day.

**NEW JERSEY DEPARTMENT OF LABOR AND WORKFORCE DEVELOPMENT
PREVAILING WAGE RATE DETERMINATION**

County - CAMDEN

Craft: Boilermaker PREVAILING WAGE RATE

	01/12/24
Foreman	W54.11 B47.08 T101.19
General Foreman	W56.11 B48.14 T104.25
Journeyman	W49.11 B45.31 T94.42

Craft: Boilermaker APPRENTICE RATE SCHEDULE

INTERVAL	PERIOD AND RATES									
1000 Hours	65%	70%	75%	80%	85%	90%	95%			
Benefit =	38.33	39.30	40.32	41.31	42.32	43.32	44.30			

Ratio of Apprentices to Journeymen - *

* 1 apprentice will be allowed for the first 5 journeymen, 1 apprentice for the next 10 journeymen and 1 apprentice for each succeeding 20 journeymen up to a maximum of 5 apprentices per contractor on any one job.

Craft: Boilermaker COMMENTS/NOTES

HIGH WORK: All apprentices working on the erection, repair, or dismantling of smoke stacks, standpipes, or water towers shall be paid the Journeyman rate.

The regular workday shall consist of 8 hours, between 8:00 AM and 4:30 PM.

SHIFT DIFFERENTIALS:

- The second shift shall work 7 1/2 hours and receive 8 hours pay, at a rate equal to the regular hourly rate plus 10%.
- The third shift shall work 7 hours and receive 8 hours pay, at a rate equal to the regular hourly rate plus 20%.
- For "Municipal Water Works" projects only, the following shall apply: Two, four day, 10 hour shifts may be worked at straight time Monday through Thursday. The day shift shall work four days, at 10 hours, for 10 hours pay. The second shift shall work four days, at nine and a half hours, for 10 hours pay, plus 10% the hourly rate for new work and .25 cents on repair work. Friday may be used as a make-up day at straight time, due to weather conditions, holiday or any other circumstances beyond the employer's control.

OVERTIME:

- Hours in excess of 8 per day, Monday through Friday, and all hours on Saturdays shall be paid at time and one-half the hourly rate. All hours on Sundays and holidays (except Labor Day) shall be paid at double the hourly rate. All hours on Labor Day shall be paid at four times the hourly rate.
- If any other craft employed by the same contractor, or a subcontractor thereof, receives double time in lieu of time and one-half, then the Boilermaker shall receive double time in lieu of time and one-half.
- For "Municipal Water Works" projects only, the following shall apply: Four 10 hour days may be worked Monday through Thursday at straight time. Friday may be used as a make-up day for a day lost to inclement weather, holiday or other conditions beyond the control of the employer. Overtime shall be paid for any hours that exceed 10 hours per day or 40 hours per week.

**NEW JERSEY DEPARTMENT OF LABOR AND WORKFORCE DEVELOPMENT
PREVAILING WAGE RATE DETERMINATION**

County - CAMDEN

RECOGNIZED HOLIDAYS: New Year's Day, Washington's Birthday, Memorial Day, July 4th, Labor Day, Presidential Election Day, Veterans' Day, Thanksgiving Day, Christmas Day. Sunday holidays observed the following Monday.

**NEW JERSEY DEPARTMENT OF LABOR AND WORKFORCE DEVELOPMENT
PREVAILING WAGE RATE DETERMINATION**

County - CAMDEN

Craft: Boilermaker - Minor Repairs

PREVAILING WAGE RATE

	01/12/24
Foreman	W35.88 B17.89 T53.77
General Foreman	W36.38 B17.89 T54.27
Mechanic	W34.38 B17.89 T52.27

Craft: Boilermaker - Minor Repairs

COMMENTS/NOTES

NOTE: These rates apply to MINOR REPAIR WORK ONLY (repair work in the field for which the contract amount does not exceed \$125,000.00), for boilers that do not produce electric or are not used in the heating of petroleum products.

OVERTIME:

Hours in excess of 8 per day, Monday through Friday, and all hours on Saturdays shall be paid at time and one-half the hourly rate. All hours on Sundays and holidays (except Labor Day) shall be paid at double the hourly rate. All hours on Labor Day shall be paid at four times the hourly rate.

RECOGNIZED HOLIDAYS: New Year's Day, Washington's Birthday, Good Friday, Memorial Day, July 4th, Labor Day, Presidential Election Day, Thanksgiving Day, day after Thanksgiving, Christmas Day. Saturday holidays observed the preceding Friday, Sunday holidays observed the following Monday.

**NEW JERSEY DEPARTMENT OF LABOR AND WORKFORCE DEVELOPMENT
PREVAILING WAGE RATE DETERMINATION**

County - CAMDEN

Craft: Bricklayer, Stone Mason

PREVAILING WAGE RATE

	05/09/24
Deputy Foreman	W51.60 B37.68 T89.28
Foreman	W56.35 B37.68 T94.03
Journeyman	W48.60 B37.68 T86.28

Craft: Bricklayer, Stone Mason

APPRENTICE RATE SCHEDULE

INTERVAL	PERIOD AND RATES									
	40%	50%	55%	60%	65%	70%	75%	80%		
6 months										
Benefits	5.61	6.88	7.50	8.13	28.95	30.86	32.78	34.67		

Ratio of Apprentices to Journeymen - 1:5

Craft: Bricklayer, Stone Mason

COMMENTS/NOTES

The regular workday shall consist of 8 hours, between 6:00 AM and 4:30 PM.

SHIFT DIFFERENTIALS:

- When a 2 shift schedule (including a day shift) is established, the first, or day shift, shall be established on an 8 hour basis. The second shift shall be established on an 8 hour basis, and receive the regular rate plus 10%, inclusive of benefits.
- When a three shift schedule is established, the first shift shall be established on an 8 hour basis, the second shift on a 7.5 hour basis, and the third shift on a 7 hour basis. The first shift shall receive the regular hourly rate, the second shift shall receive the regular rate plus 10%, inclusive of benefits, and the third shift shall receive the regular rate plus 15%, inclusive of benefits.
- When there is no day shift, and a second or third shift is established, it shall be established on an 8 hour basis. The second shift shall receive the regular rate plus 10%, inclusive of benefits, and the third shift shall receive the regular rate plus 15%, inclusive of benefits.
- When an irregular shift must be established, this shift shall receive the regular rate plus 10%, inclusive of benefits.

OVERTIME:

- The first 2 hours in excess of 8 per day, or before or after the regular workday that are not shift work, Monday through Friday, shall be paid at time and one-half the regular rate, inclusive of benefits. Any additional overtime shall be paid at double the regular rate, inclusive of benefits. The first 10 hours on Saturday shall be paid at time and one-half the regular rate, inclusive of benefits. Any additional overtime shall be paid at double the regular rate, inclusive of benefits. All hours on Sundays and holidays shall be paid at double the regular rate, inclusive of benefits.
- Saturday may be used as a make-up day for hours lost to inclement weather.
- When Bricklayers/Stone Masons work on Saturday with Laborers, and no other crafts are working on the project for the day, benefits may be paid at straight time. If other crafts are present, the applicable overtime rate for benefits shall be paid.

**NEW JERSEY DEPARTMENT OF LABOR AND WORKFORCE DEVELOPMENT
PREVAILING WAGE RATE DETERMINATION**

County - CAMDEN

RECOGNIZED HOLIDAYS: New Year's Day, President's Day, Memorial Day, July 4th, Labor Day, Veterans' Day, Thanksgiving Day, Christmas Day. Sunday holidays will be observed the following Monday.

**NEW JERSEY DEPARTMENT OF LABOR AND WORKFORCE DEVELOPMENT
PREVAILING WAGE RATE DETERMINATION**

County - CAMDEN

Craft: Carpenter PREVAILING WAGE RATE

	05/09/24
Foreman	W64.41 B38.73 T103.14
Journeyman	W56.01 B33.76 T89.77

Craft: Carpenter APPRENTICE RATE SCHEDULE

INTERVAL	PERIOD AND RATES									
Yearly	40%	55%	65%	80%	90%					
Benefit	59.25% of	Appren	tice	Wage	for all	intervals	+ \$0.57			

Ratio of Apprentices to Journeymen - 1:3

For Solar installation- all work on solar projects that fall under the jurisdiction of the carpenters, and does not require an electrician, the ratio of Apprentices to Journeymen shall be 1:1.

Craft: Carpenter COMMENTS/NOTES

APPRENTICE RATE SCHEDULE FOR THOSE APPRENTICES REGISTERED AS OF 5-1-19:

INTERVAL PERIOD AND RATES
 Yearly 40% 55% 65% 80%
 Benefits 59.25% of apprentice wage rate for all intervals + \$0.57

FOREMAN REQUIREMENTS:

- When there are 2 or more Carpenters on a job, 1 shall be designated as a Foreman.
- When there are 21 or more Carpenters on a job, 2 shall be designated as Foremen.

The regular workday shall consist of 8 hours, starting between 6:00 AM and 9:00 AM.

SHIFT DIFFERENTIALS:

- When a 2 shift schedule (including a day shift) is established, the day shift shall be established on an 8 hour basis. The second shift shall be established on an 8 hour basis, and receive the regular rate plus 10%, inclusive of benefits.
- When a three shift schedule is established, the first shift shall be established on an 8 hour basis, the second shift on a 7.5 hour basis, and the third shift on a 7 hour basis. The first shift shall receive the regular hourly rate, the second shift shall receive the regular rate plus 10% and the third shift shall receive the regular rate plus 15%, inclusive of benefits.
- When there is no day shift, and a second or third shift is established, it shall be established on an 8 hour basis. The second shift shall receive the regular rate plus 10% and the third shift shall receive the regular rate plus 15%, inclusive of benefits.
- When an irregular shift must be established, this shift shall receive the regular rate plus 15%, inclusive of benefits.
- All time worked before and after a regularly established shift shall be paid at the applicable overtime rate. When a portion of the regularly established shift works into Saturday, Sunday or a holiday, that time worked shall be paid at the established shift rate.

OVERTIME:

**NEW JERSEY DEPARTMENT OF LABOR AND WORKFORCE DEVELOPMENT
PREVAILING WAGE RATE DETERMINATION**

County - CAMDEN

- All hours in excess of 8 per day, or before or after an established shift that are not shift work, and all hours on Saturdays shall be paid at time and one-half the hourly rate, inclusive of benefits. All hours on Sundays and holidays shall be paid at double the hourly rate, inclusive of benefits.
- Four 10-hour days may be worked, Monday to Thursday, at straight time. Friday may be used as a make-up day for a day lost due to inclement weather. If Friday is not a make-up day, all hours on Friday shall be paid at time and one-half the hourly rate, inclusive of benefits.

RECOGNIZED HOLIDAYS: New Year's Day, Presidents' Day, Memorial Day, July 4th, Labor Day, Veterans' Day, Thanksgiving Day, Christmas Day. Sunday holidays observed the following Monday. Veterans' Day may be substituted for the day after Thanksgiving.

**NEW JERSEY DEPARTMENT OF LABOR AND WORKFORCE DEVELOPMENT
PREVAILING WAGE RATE DETERMINATION**

County - CAMDEN

Craft: Carpenter - Resilient Flooring

PREVAILING WAGE RATE

	05/01/24
Foreman	W64.41 B38.64 T103.05
Journeyman	W56.01 B33.67 T89.68

Craft: Carpenter - Resilient Flooring

APPRENTICE RATE SCHEDULE

INTERVAL	PERIOD AND RATES									
Yearly	40%	55%	65%	80%	90%					
Benefit	59.25% of	Appren	tice	Wage	for all	intervals	+ \$0.48			

Ratio of Apprentices to Journeymen - *

* Ratio is 1 apprentice to 2 journeymen. No more than 3 apprentices may be on any 1 project.

Craft: Carpenter - Resilient Flooring

COMMENTS/NOTES

APPRENTICE RATE SCHEDULE FOR THOSE APPRENTICES REGISTERED AS OF 5-1-19:

INTERVAL PERIOD AND RATES
 Yearly 40% 55% 65% 80%
 Benefits 59.25% of apprentice wage rate for all intervals + \$0.48.

FOREMAN REQUIREMENTS:

- On any job where there are 4 or more Carpenters of Resilient Flooring, 1 must be designated a Foreman.

FOR SYNTHETIC TURF INSTALLATION ONLY:

- The rate shall be 90% of the wage and benefit rate.

The regular workday consists of 8 hours, starting between 6:00 AM and 9:00 AM.

SHIFT DIFFERENTIALS:

- When a 2 shift schedule (including a day shift) is established, the day shift, shall be established on an 8 hour basis. The second shift shall be established on an 8 hour basis, and receive the regular wage rate plus 10%.
- When a three shift schedule is established, the first shift shall be established on an 8 hour basis, the second shift on a 7.5 hour basis, and the third shift on a 7 hour basis. The first shift shall receive the regular wage rate, the second shift shall receive the regular wage rate plus 10% and the third shift shall receive the regular wage rate plus 15%.
- When there is no day shift, and a second or third shift is established, it shall be established on an 8 hour basis. The second shift shall receive the regular wage rate plus 10% and the third shift shall receive the regular wage rate plus 15%.
- When an irregular shift must be established, this shift shall receive the regular rate plus 15%, inclusive of benefits.

OVERTIME:

- Hours in excess of 8 per day or 40 per week, or before or after the regular workday, Monday through Friday, shall be paid at time and one-half the wage rate. Saturday may be used as a make-up day, at straight time, up to 8 hours, for hours lost to reasons beyond the control of the employer, up to a total of 40 hours per week; hours in excess of 8 on Saturday shall then be paid at time and one-half the wage rate. If Saturday is not a make-up day, all hours on Saturday shall be paid at

**NEW JERSEY DEPARTMENT OF LABOR AND WORKFORCE DEVELOPMENT
PREVAILING WAGE RATE DETERMINATION**

County - CAMDEN

time and one-half the wage rate. All hours on Sundays and holidays shall be paid at double the wage rate.

- Four 10-hour days may be worked, Monday to Thursday, at straight time. Friday may be used as a make-up day for hours lost to reasons beyond the control of the employer. If Friday is not a make-up day, all hours on Friday shall be paid at time and one-half the wage rate.

RECOGNIZED HOLIDAYS: New Year's Day, Presidents' Day, Memorial Day, July 4th, Labor Day, Veterans' Day, Thanksgiving Day, Christmas Day. Sunday holidays will be observed the following Monday. Veterans' Day may be substituted for the day after Thanksgiving.

**NEW JERSEY DEPARTMENT OF LABOR AND WORKFORCE DEVELOPMENT
PREVAILING WAGE RATE DETERMINATION**

County - CAMDEN

Craft: Carpenter-Residential Construction

PREVAILING WAGE RATE

	05/09/24
Foreman	W54.29 B11.99 T66.28
Journeyman	W47.21 B11.14 T58.35

Craft: Carpenter-Residential Construction

APPRENTICE RATE SCHEDULE

INTERVAL	PERIOD AND RATES									
Yearly	40%	55%	65%	80%						
Benefit	12% of	Appren	tice	wage rate	for all	intervals	+ \$5.48			

Ratio of Apprentices to Journeymen - 1:3

Craft: Carpenter-Residential Construction

COMMENTS/NOTES

FOREMAN REQUIREMENTS:

- When there are 2 or more Carpenters on a job, 1 shall be designated as a Foreman.
- When there are 21 or more Carpenters on a job, 2 shall be designated as Foremen.

The regular workday shall consist of 8 hours, starting between 6:00 AM and 9:00 AM.

RESIDENTIAL CONSTRUCTION:

All residential construction (excluding commercial buildings and institutional housing), no more than four (4) floors in height above grade consisting of those projects involving the construction, alteration, or repair of town houses or row houses, single family homes, mobile homes, multi-family homes, mixed-use buildings that include commercial space on the first floor or below grade, and apartment buildings.

SHIFT DIFFERENTIALS:

- When a 2 shift schedule (including a day shift) is established, the day shift shall be established on an 8 hour basis. The second shift shall be established on an 8 hour basis, and receive the regular rate plus 10%, inclusive of benefits.
- When a three shift schedule is established, the first shift shall be established on an 8 hour basis, the second shift on a 7.5 hour basis, and the third shift on a 7 hour basis. The first shift shall receive the regular hourly rate, the second shift shall receive the regular rate plus 10% and the third shift shall receive the regular rate plus 15%, inclusive of benefits.
- When there is no day shift, and a second or third shift is established, it shall be established on an 8 hour basis. The second shift shall receive the regular rate plus 10% and the third shift shall receive the regular rate plus 15%, inclusive of benefits.
- When an irregular shift must be established, this shift shall receive the regular rate plus 15%, inclusive of benefits.

OVERTIME:

- All hours in excess of 8 per day, or before or after an established shift that are not shift work, and all hours on Saturdays shall be paid at time and one-half the hourly rate, inclusive of benefits. All hours on Sundays and holidays shall be paid at double the hourly rate, inclusive of benefits.
- Four 10-hour days may be worked, Monday to Thursday, at straight time. Friday may be used as a make-up day for a

**NEW JERSEY DEPARTMENT OF LABOR AND WORKFORCE DEVELOPMENT
PREVAILING WAGE RATE DETERMINATION**

County - CAMDEN

day lost due to inclement weather. If Friday is not a make-up day, all hours on Friday shall be paid at time and one-half the hourly rate, inclusive of benefits.

RECOGNIZED HOLIDAYS: New Year's Day, Presidents' Day, Memorial Day, July 4th, Labor Day, Veterans' Day, Thanksgiving Day, Christmas Day. Sunday holidays observed the following Monday. Veterans' Day may be substituted for the day after Thanksgiving.

NEW JERSEY DEPARTMENT OF LABOR AND WORKFORCE DEVELOPMENT
PREVAILING WAGE RATE DETERMINATION

County - CAMDEN

Craft: Cement Mason

PREVAILING WAGE RATE

See " Bricklayer, Stone Mason" Rates

Craft: Cement Mason

COMMENTS/NOTES

***See " Bricklayer, Stone Mason" Rates

**NEW JERSEY DEPARTMENT OF LABOR AND WORKFORCE DEVELOPMENT
PREVAILING WAGE RATE DETERMINATION**

County - CAMDEN

Craft: Commercial Painter

PREVAILING WAGE RATE

	05/29/24
Foreman	W48.90 B30.71 T79.61
General Foreman	W53.34 B30.71 T84.05
Journeyman	W44.45 B30.71 T75.16

Craft: Commercial Painter

APPRENTICE RATE SCHEDULE

INTERVAL	PERIOD AND RATES									
6 Months	40%	45%	55%	65%	70%	75%	80%	80%		
Benefits	9.40	9.40	11.90	11.90	13.00	13.00	15.90	15.90		

Ratio of Apprentices to Journeymen - 1:4

Craft: Commercial Painter

COMMENTS/NOTES

* Commercial Painters perform work on all commercial structures such as offices, schools, hotels, shopping malls, restaurants, condominiums, etc.

Spraying, sandblasting, lead abatement work on commercial buildings, work performed above 3 stories or 30 feet in height, or using swing scaffolds requires an additional 10% of the wage rate.

FOREMEN REQUIREMENTS:

- When there are 4 or more Painters on a job, 1 shall be designated a Foreman.
- When there are 15 or more Painters on a job, 1 shall be designated a General Foreman.

The regular workday shall consist of 8 hours between 7:00 AM and 5:30 PM.

SHIFT DIFFERENTIALS:

- The second shift shall receive an additional 10% of the hourly rate, per hour, and the third shift shall receive an additional 15% of the hourly rate, per hour.

OVERTIME:

- Hours in excess of 8 per day, or before or after the regular workday, Monday through Friday, and all hours on Saturdays shall be paid at time and one-half the regular rate. All hours on Sundays and holidays shall be paid at double the regular rate.
- Saturday or Sunday may be used to make up a day lost to inclement weather, at straight time.
- Four 10-hour days may be worked, at straight time, Monday through Friday.

RECOGNIZED HOLIDAYS: New Year's Day, President's Day, Memorial Day, July 4th, Labor Day, General Election Day,

**NEW JERSEY DEPARTMENT OF LABOR AND WORKFORCE DEVELOPMENT
PREVAILING WAGE RATE DETERMINATION**

County - CAMDEN

Veterans' Day, Thanksgiving Day, Christmas Day.

**NEW JERSEY DEPARTMENT OF LABOR AND WORKFORCE DEVELOPMENT
PREVAILING WAGE RATE DETERMINATION**

County - CAMDEN

Craft: Diver PREVAILING WAGE RATE

	05/01/24
Diver	W59.38 B43.62 T103.00
Tender	W47.50 B43.62 T91.12

Craft: Diver APPRENTICE RATE SCHEDULE

INTERVAL	PERIOD AND RATES									
	70%	75%	80%	85%						
1500 hours										
Benefits	31.35	32.41	33.47	34.54						

Ratio of Apprentices to Journeymen - 1:4

Craft: Diver COMMENTS/NOTES

NOTE: All dive crews must consist of a Tender, a Diver, and a Standby Diver (Standby Diver is the same rate as a Diver).

- Diver- will perform all Dive related tasks at hand.
- Tender- will provide Tending support to the in water Diver and who may also be designated as a Standby Diver .

Diving in Contaminated Water (including, but not limited to, radioactively contaminated water, sewer effluent combined sanitary and storm sewers, or any environment known to be harmful to those with skin contact): Shall receive an additional 20% of the hourly rate.

OVERTIME:

- The first 2 hours in excess of 8 per day (9th and 10th hours), Monday through Friday, and the first 8 hours on Saturdays shall be paid at time and one-half the hourly rate. Hours in excess of 10 per day, Monday through Friday, hours in excess of 8 per day on Saturdays, and all hours on Sundays and holidays shall be paid at double the hourly rate.
- Employees may work four 10-hour days, Monday through Thursday, at straight time, with Friday used as a make-up day for a day lost to inclement weather. If Friday is not a make-up day, the first 10 hours on Friday shall be paid at time and one-half the hourly rate. Hours in excess of 10 per day shall be paid at double the hourly rate.

RECOGNIZED HOLIDAYS: New Year's Day, President's Day, Memorial Day, July 4th, Labor Day, Thanksgiving Day, Christmas Day. Saturday holidays will be observed the preceeding Friday and Sunday holidays will be observed the following Monday.

**NEW JERSEY DEPARTMENT OF LABOR AND WORKFORCE DEVELOPMENT
PREVAILING WAGE RATE DETERMINATION**

County - CAMDEN

Craft: Dockbuilder/Pile Driver

PREVAILING WAGE RATE

	05/01/24
Foreman	W57.00 B43.62 T100.62
Journeyman	W47.50 B43.62 T91.12

Craft: Dockbuilder/Pile Driver

APPRENTICE RATE SCHEDULE

INTERVAL	PERIOD AND RATES									
1500 hours	40%	50%	65%	80%						
Benefits	25.26	27.39	30.39	33.53						

Ratio of Apprentices to Journeymen - 1:3

Craft: Dockbuilder/Pile Driver

COMMENTS/NOTES

NOTE: The following shall be required for type of work indicated-

- There shall be one foreman and four journeymen on all land pile driving rigs. As part of the crew, one may be an apprentice.
- There shall be one foreman and two journeymen on self-contained hydraulic driving rigs. As part of the crew, one may be an apprentice.
- There shall be one foreman and two journeymen when driving sheeting with an excavator. As part of the crew, one may be an apprentice.
- When utilizing a drill rig to install Auger cast piles there shall be one foreman and two journeymen. As part of the crew, one may be an apprentice.
- There shall be one journeyman on drilled or bored soldier piles.
- There shall be not less than one journeyman per rig on all drilled shaft and caissons.
- There shall be not less than one journeyman per rig on all earth retention tie-back and anchors.

Creosote Handling:

- May 1st to Sept. 30th: + \$0.50 above hourly rate
- Oct. 1st to April 30th: + \$0.25 above hourly rate

Hazardous Material Work:

- On hazardous material work on a state or federally designated hazardous work site where the worker is required to wear Level A, B or C personal protection, the worker shall receive an additional 20% of the hourly rate, per hour.
- A Dockbuilder/Pile Driver working on a hazardous waste removal project, or site requiring hazardous waste related certification, but who is not working in a zone requiring level A, B or C personal protection, shall receive the hourly rate plus an additional \$1.00 per hour. This type of work does not include the handling of creosote or CCA materials; coated materials such as bitumastic, or galvanized; painted materials or any products designed to be used in the industry.

FOREMAN REQUIREMENTS:

- When there are 3 or more Dockbuilders/Pile Drivers on a job, 1 shall be designated as a Foreman.

SHIFT WORK:

**NEW JERSEY DEPARTMENT OF LABOR AND WORKFORCE DEVELOPMENT
PREVAILING WAGE RATE DETERMINATION**

County - CAMDEN

- Shift work pertains to both land and water work.
- When a 2 shift schedule (including a day shift) is established, the first shift shall start between 5:00 am and 8:00 am and work for 7 and one-half hours and receive 8 hours pay. The second shift shall start when the first shift ends and shall work for 7 and one-half hours and receive 8 hours pay.
- When a three shift schedule is established, all shifts shall work 7 and one-half hours and receive 8 hours pay.
- When there is no day shift, and a second or third shift is established, a worker shall be paid at time and one-half of the hourly rate.

OVERTIME:

- The first 2 hours in excess of 8 per day (9th and 10th hours), Monday through Friday, and the first 8 hours on Saturdays shall be paid at time and one-half the hourly rate. Hours in excess of 10 per day, Monday through Friday, hours in excess of 8 per day on Saturdays, and all hours on Sundays and holidays shall be paid at double the hourly rate.
- Employees may work four 10-hour days, Monday through Thursday, at straight time, with Friday used as a make-up day for a day lost to inclement weather. If Friday is not a make-up day, the first 10 hours on Friday shall be paid at time and one-half the hourly rate. Hours in excess of 10 per day shall be paid at double the hourly rate.

RECOGNIZED HOLIDAYS: New Year's Day, President's Day, Memorial Day, July 4th, Labor Day, Thanksgiving Day, Christmas Day. Saturday holidays will be observed the preceeding Friday and Sunday holidays will be observed the following Monday.

**NEW JERSEY DEPARTMENT OF LABOR AND WORKFORCE DEVELOPMENT
PREVAILING WAGE RATE DETERMINATION**

County - CAMDEN

Craft: Drywall Finisher

PREVAILING WAGE RATE

	05/29/24
Foreman	W47.75 B31.11 T78.86
General Foreman	W49.92 B31.11 T81.03
Journeyman	W43.41 B31.11 T74.52

Craft: Drywall Finisher

APPRENTICE RATE SCHEDULE

INTERVAL	PERIOD AND RATES									
	40%	50%		60%	70%		80%	90%		
6 Months										
Benefits	Intervals	1 to 2 =	11.90	Intervals	3 to 4 =	15.03	Intervals	5 to 6 =	18.84	

Ratio of Apprentices to Journeymen - 1:4

Craft: Drywall Finisher

COMMENTS/NOTES

The regular workday shall consist of 8 hours between 7:00 AM and 5:30 PM.

SHIFT DIFFERENTIALS:

- The second shift shall receive an additional 10% of the hourly rate, per hour, and the third shift shall receive an additional 15% of the hourly rate, per hour.
- When 3 shifts are worked, the second shift shall receive 8 hours pay for 7.5 hours of work, and the third shift shall receive 8 hours pay for 7 hours of work.
- Shift work must run for a minimum of 5 consecutive workdays.

OVERTIME:

- Hours in excess of 8 per day, Monday through Friday, and all hours on Saturdays shall be paid at time and one-half the regular rate, inclusive of benefits. All hours on Sundays and holidays shall be paid at double the regular rate, inclusive of benefits.
- Saturday or Sunday may be used to make up a day lost to inclement weather, at straight time.

RECOGNIZED HOLIDAYS: New Year's Day, Memorial Day, July 4th, Labor Day, Presidential Election Day, Veterans' Day, Thanksgiving Day, Christmas Day. Saturday holiday observed the preceding Friday. Sunday holiday observed the following Monday.

**NEW JERSEY DEPARTMENT OF LABOR AND WORKFORCE DEVELOPMENT
PREVAILING WAGE RATE DETERMINATION**

County - CAMDEN

Craft: Electrician

PREVAILING WAGE RATE

	10/03/24
Asst. General Foreman	W66.06 B58.03 T124.09
Foreman	W61.66 B54.61 T116.27
General Foreman	W71.57 B62.33 T133.90
Journeyman, Cable Splicer	W55.05 B49.47 T104.52
Lead Foreman	W63.31 B55.90 T119.21
Working Foreman, Welder, Crane Operator (all types)	W57.80 B51.61 T109.41

Craft: Electrician

APPRENTICE RATE SCHEDULE

<u>INTERVAL</u>	<u>PERIOD AND RATES</u>									
Yearly	16.30	20.70	23.40	27.63	31.87					
Benefits	8.14	9.39	10.15	11.36	12.56					

Ratio of Apprentices to Journeymen - 2:3

Craft: Electrician

COMMENTS/NOTES

THESE RATES ALSO APPLY TO THE FOLLOWING:

- All fire and burglar alarm work.
- All fiber optic work.
- Teledata work in new construction (including additions).
- Teledata work involving 16 or more instruments or voice/data lines.
- All camera installations.

Height Work: 40 feet above ground/floor: +10% of the wage and benefit amount.

FOREMAN REQUIREMENTS (number of Electricians on site):

(2 to 10) - a Working Foreman; (11 to 22) - a Foreman; (23 to 44) - a Lead Foreman; (35 to 48) - an Assistant General Foreman; (49 or more) - a General Foreman.

**NEW JERSEY DEPARTMENT OF LABOR AND WORKFORCE DEVELOPMENT
PREVAILING WAGE RATE DETERMINATION**

County - CAMDEN

The regular workday consists of 8 hours, between 7:00 AM and 4:30 PM.

SHIFT DIFFERENTIALS:

- Shift work must run for a minimum of 5 consecutive workdays
- 2nd Shift (4:30 PM to 12:30 AM): 8 hrs. pay for 7.5 hrs. work + an additional 10% of the wage rate, inclusive of benefits.
- 3rd Shift (12:30 AM to 8:00 AM): 8 hrs. pay for 7 hrs. work + an additional 15% of the wage rate, inclusive of benefits.

OVERTIME:

The first 4 hours in excess of 8 per day, or before or after the regular workday, Monday through Friday, and the first 8 hours on Saturdays, shall be paid at time and one-half the regular rate, inclusive of benefits. Hours in excess of 12 per day, Monday through Friday, in excess of 8 on Saturdays, and all hours on Sundays and holidays shall be paid at double the regular rate, inclusive of benefits.

RECOGNIZED HOLIDAYS: New Year's Day, Memorial Day, July 4th, Labor Day, Presidential Election Day, Veterans' Day, Thanksgiving Day, Christmas Day. Sunday holidays will be observed the following Monday.

**NEW JERSEY DEPARTMENT OF LABOR AND WORKFORCE DEVELOPMENT
PREVAILING WAGE RATE DETERMINATION**

County - CAMDEN

Craft: Electrician - Teledata (15 Voice/Data Lines & Less)

PREVAILING WAGE RATE

	09/18/24
Master Technician/Gen. Foreman (31+ Workers on Job)	W52.80 B39.65 T92.45
Senior Technician/Lead Foreman (21-30 Workers on Job)	W48.25 B38.15 T86.40
Technician A/Foreman (11-20 Workers on Job)	W46.14 B37.46 T83.60
Technician B/Working Foreman (4-10 Workers on Job)	W44.89 B36.05 T80.94
Technician C/Journeyman (1-3 Workers on Job)	W41.00 B33.77 T74.77

Craft: Electrician - Teledata (15 Voice/Data Lines & Less)

APPRENTICE RATE SCHEDULE

INTERVAL	PERIOD AND RATES									
6 Months	17.26	17.26	20.54	20.54	25.48	25.48	30.02	30.02		
Benefits	9.85	9.85	10.82	10.82	12.77	12.77	15.12	15.12		

Ratio of Apprentices to Journeymen - 2:3

Craft: Electrician - Teledata (15 Voice/Data Lines & Less)

COMMENTS/NOTES

NOTES: These rates are for service, maintenance, moves and/or changes affecting 15 voice/data lines or less. These rates may NOT be used for any new construction or fiber optic work.

FOREMAN REQUIREMENTS:

The number of workers on the jobsite is the determining factor for which Foreman category applies.

HIGH WORK: Any work performed 40 feet above ground or floor: +10% of the wage and benefit amount.

SHIFT DIFFERENTIAL:

- 2nd Shift (4:30 PM to 12:30 AM) - 8 hrs. pay for 7.5 hrs. work + an additional 10% of the wage rate, inclusive of benefits.

- 3rd Shift (12:30 AM to 8:00 AM) - 8 hrs. pay for 7 hrs. work + an additional 15% of the wage rate, inclusive of benefits.

OVERTIME:

Hours in excess of 8 per day, Monday through Friday, and all hours on Saturdays shall be paid at time and one-half the regular rate, inclusive of benefits. All hours on Sundays and holidays shall be paid at double the regular rate, inclusive of benefits.

**NEW JERSEY DEPARTMENT OF LABOR AND WORKFORCE DEVELOPMENT
PREVAILING WAGE RATE DETERMINATION**

County - CAMDEN

RECOGNIZED HOLIDAYS: New Year's Day, Memorial Day, July 4th, Labor Day, Presidential Election Day, Veterans Day, Thanksgiving Day, Christmas Day. Sunday holidays will be observed the following Monday.

NEW JERSEY DEPARTMENT OF LABOR AND WORKFORCE DEVELOPMENT
PREVAILING WAGE RATE DETERMINATION

County - CAMDEN

Craft: Electrician - Teledata (16 Instruments & More)

PREVAILING WAGE RATE

See "Electrician" Rates

Craft: Electrician - Teledata (16 Instruments & More)

COMMENTS/NOTES

See ELECTRICIAN Rates

**NEW JERSEY DEPARTMENT OF LABOR AND WORKFORCE DEVELOPMENT
PREVAILING WAGE RATE DETERMINATION**

County - CAMDEN

Craft: Electrician- Outside Commercial

PREVAILING WAGE RATE

	10/03/24
Assistant General Foreman	W66.06 B57.98 T124.04
Foreman	W61.66 B54.53 T116.19
General Foreman	W71.57 B62.32 T133.89
Groundhand, Truck Driver, Conduit Installer (1 year or more experience)	W27.53 B27.74 T55.27
Groundhand, Truck Driver, Conduit Installer (2 years or more experience)	W38.54 B36.38 T74.92
Groundhand, Truck Driver, Conduit Installer (3 years or more experience)	W46.79 B42.27 T89.06
Groundhand, Truck Driver, Conduit Installer (less than 1 year exp.)	W22.02 B1.54 T23.56
Journeyman Lineman	W55.05 B49.33 T104.38
Lead Foreman	W63.31 B55.82 T119.13
Working Foreman	W57.80 B51.49 T109.29

Craft: Electrician- Outside Commercial

APPRENTICE RATE SCHEDULE

INTERVAL	PERIOD AND RATES									
6 Months	25.52	27.63	29.75	31.87	33.99	36.11	38.22			
Benefits	10.55	11.17	11.77	12.40	13.01	13.63	14.25			

Craft: Electrician- Outside Commercial

COMMENTS/NOTES

**NEW JERSEY DEPARTMENT OF LABOR AND WORKFORCE DEVELOPMENT
PREVAILING WAGE RATE DETERMINATION**

County - CAMDEN

* FOR UTILITY WORK PLEASE SEE STATEWIDE RATES

FOREMAN REQUIREMENTS (number of Electricians on site):

(1 to 10)- one Working Foreman.

(11 to 20)- one Working Foreman and one Foreman.

(21 to 30)- one Working Foreman, one Foreman and one Lead Foreman.

(31 to 40) - one Working Foreman, two (2) Foremen and one Lead Foreman.

(41 to 50)- one Working Foreman, four (4) Foremen, one Assistant General Foreman (runs 5 foremen), and one General Foreman.

(51 to 60)- one Working Foreman, five (5) Foremen, one Assistant General Foreman (runs 5 foremen), and one General Foreman

(runs one foreman).

(61 to 70)- one Working Foreman, six (6) Foremen, one Assistant General Foreman (runs 5 foremen), and one General Foreman

(runs two foremen).

(71 to 80)- one Working Foreman, seven (7) Foremen, two (2) Assistant General Foremen and one General Foreman.

(81 to 90)- one Working Foreman, eight (8) Foremen, two (2) Assistant General Foremen, and one General Foreman.

(91 to 100)- one Working Foreman, nine (9) Foremen, two (2) Assistant General Foremen and one General Foreman.

The regular workday consists of 8 hours, between 7:00 AM and 4:30 PM.

SHIFT DIFFERENTIALS:

Shift work must run for a minimum of 5 consecutive workdays.

2nd Shift (4:30 PM to 12:30 AM): 8 hrs. pay for 7.5 hrs. work + an additional 10% of the wage rate, inclusive of benefits.

3rd Shift (12:30 AM to 8:00 AM): 8 hrs. pay for 7 hrs. work + an additional 15% of the wage rate, inclusive of benefits.

OVERTIME:

All hours in excess of 8 per day, Monday through Friday, that are not shift work, and all hours on Saturday shall be paid at time and one-half the regular rate, inclusive of benefits. All hours on Sundays and Holidays shall be paid at double the regular rate, inclusive of benefits.

RECOGNIZED HOLIDAYS:

New Year's Day, Memorial Day, July 4th, Labor Day, Presidential Election Day, Veterans' Day, Thanksgiving Day, Christmas Day. Sunday holidays will be observed the following Monday.

**NEW JERSEY DEPARTMENT OF LABOR AND WORKFORCE DEVELOPMENT
PREVAILING WAGE RATE DETERMINATION**

County - CAMDEN

Craft: Electrician-Utility Work (North)

PREVAILING WAGE RATE

Rates are located in the "Statewide" rate package

Craft: Electrician-Utility Work (North)

APPRENTICE RATE SCHEDULE

INTERVAL	PERIOD AND RATES									
* 6 Months	60%	65%	70%	75%	80%	85%	90%			
Benefits	69% of	Appren	tice	Wage	Rate	for all	intervals			

Craft: Electrician-Utility Work (North)

COMMENTS/NOTES

Electrician-Utility Work (North) rates are located in the "Statewide" rate package.

* The apprentice wage rate is paid at the percentage of the Journeyman Lineman wage rate located in the "Statewide" rate package.

**NEW JERSEY DEPARTMENT OF LABOR AND WORKFORCE DEVELOPMENT
PREVAILING WAGE RATE DETERMINATION**

County - CAMDEN

Craft: Electrician-Utility Work (South)

PREVAILING WAGE RATE

Rates are located in the "Statewide" rate package

Craft: Electrician-Utility Work (South)

APPRENTICE RATE SCHEDULE

INTERVAL	PERIOD AND RATES									
6 Months	33.69	36.50	39.31	42.11	44.92	47.73	50.54			
Benefits	29.97	31.72	33.46	35.21	36.96	38.71	40.45			

Craft: Electrician-Utility Work (South)

COMMENTS/NOTES

Electrician-Utility Work (South) rates are located in the "Statewide" rate package.

**NEW JERSEY DEPARTMENT OF LABOR AND WORKFORCE DEVELOPMENT
PREVAILING WAGE RATE DETERMINATION**

County - CAMDEN

Craft: Elevator Constructor

PREVAILING WAGE RATE

	01/01/25
Helper-Over 5 Years	W50.30 B44.05 T94.35
Helper-Under 5 Years	W50.30 B43.05 T93.35
Mechanic (Journeyman) over 5 years	W71.85 B45.78 T117.63
Mechanic (Journeyman) under 5 years	W71.85 B44.37 T116.22
Mechanic in Charge (Foreman) over 5 years	W80.83 B46.50 T127.33
Mechanic in Charge (Foreman) under 5 years	W80.83 B44.88 T125.71
Probationary Helper (1st 6 months)	W35.93 B42.19 T78.12

Craft: Elevator Constructor

APPRENTICE RATE SCHEDULE

INTERVAL	PERIOD AND RATES									
Yearly	55%	65%	70%	80%						
Benefits	full	journeyma	benefit	rate for	all	intervals				

Ratio of Apprentices to Journeymen - *

* Total number of helpers and apprentices shall not exceed the number of mechanics on the job , except where 2 teams are working, 1 additional helper or apprentice may be employed for first 2 teams and an extra helper or apprentice for each additional 3 teams. Further, the employer may use as many helpers or apprentices as needed, under the direction of a mechanic in wrecking old plants, handling and hoisting material, and on foundation work. When replacing cables on existing elevators, employer may use 2 helpers or apprentices to 1 mechanic.

Craft: Elevator Constructor

COMMENTS/NOTES

SHIFT DIFFERENTIALS:

- 2nd Shift (4:30 PM to 12:30 AM) shall be established on the basis of 7.5 hours of work for 8 hours of pay, plus an additional 10% per hour.
- 3rd Shift (12:30 AM to 8:00 AM) shall be established on the basis of 7 hours of work for 8 hours of pay, plus an additional 15% per hour.

**NEW JERSEY DEPARTMENT OF LABOR AND WORKFORCE DEVELOPMENT
PREVAILING WAGE RATE DETERMINATION**

County - CAMDEN

OVERTIME:

- Hours in excess of 8 per day, Monday through Friday, and all hours on Saturdays, Sundays, and holidays shall be paid at double the hourly rate.
- Four 10-hour days may be worked, Monday to Thursday or Tuesday to Friday, at straight time. When working a 4-10 hour day schedule, all hours worked on a day other than the days established for the 4-10 hour schedule shall be paid at double the hourly rate.

RECOGNIZED HOLIDAYS: New Year's Day, Memorial Day, July 4th, Labor Day, Veterans' Day, Thanksgiving Day and day after, Christmas Day. Saturday holidays observed the preceding Friday, Sunday holidays observed the following Monday.

**NEW JERSEY DEPARTMENT OF LABOR AND WORKFORCE DEVELOPMENT
PREVAILING WAGE RATE DETERMINATION**

County - CAMDEN

Craft: Glazier PREVAILING WAGE RATE

	05/09/24
Foreman	W52.00 B37.50 T89.50
Journeyman	W48.00 B37.50 T85.50

Craft: Glazier APPRENTICE RATE SCHEDULE

INTERVAL	PERIOD AND RATES									
Yearly	22.56	24.00	26.88	30.24						
Benefits	19.79	22.54	23.99	26.61						

Ratio of Apprentices to Journeymen - 1:3

Craft: Glazier COMMENTS/NOTES

HIGH WORK (30 feet above ground /floor or using a swing stage): +\$1.00/hr

FOREMAN REQUIREMENT:

- When 4 or more Glaziers are working on a job that runs for 10 days or more, 1 shall be designated a Foreman.

The regular workday shall be 8 hours, between 6:00 AM and 4:30 PM.

SHIFT DIFFERENTIALS:

- Second and Third shift shall receive the regular hourly rate, plus 15% per hour.

OVERTIME:

- The first 2 hours in excess of 8 per day (9th and 10th hours), or outside the regular workday, Monday through Friday, that are not shift work, and the first 8 hours on Saturdays shall be paid at time and one-half the regular rate. All other daily overtime, and all hours on Sundays and holidays shall be paid at double the regular rate.

- Four 10-hour days may be worked at straight time, Monday through Friday. The 11th and 12th hours on the 4 days worked, and the first 12 hours on the fifth day shall be paid at time and one-half the regular rate. All other daily overtime, and all hours on Saturdays, Sundays, and holidays shall be paid at double the regular rate.

- Benefits on overtime hours are as follows:

Time and one-half = \$46.36/hr.

Double time = \$55.22/hr.

RECOGNIZED HOLIDAYS: New Year's Day, Memorial Day, July 4th, Thanksgiving Day, Christmas Day.

**NEW JERSEY DEPARTMENT OF LABOR AND WORKFORCE DEVELOPMENT
PREVAILING WAGE RATE DETERMINATION**

County - CAMDEN

Craft: Heat & Frost Insulator

PREVAILING WAGE RATE

	05/01/24
Foreman (11-20 workers)	W65.30 B46.03 T111.33
Foreman (1-5 workers)	W62.34 B46.03 T108.37
Foreman (21-49 workers)	W68.27 B46.03 T114.30
Foreman (50+ workers)	W71.25 B46.03 T117.28
Foreman (6-10 workers)	W63.53 B46.03 T109.56
Journeyman	W59.37 B46.03 T105.40

Craft: Heat & Frost Insulator

APPRENTICE RATE SCHEDULE

INTERVAL	PERIOD AND RATES									
1000 Hours	40%	45%	48%	50%	55%	60%	65%	70%	75%	80%
Benefits	35.54	35.54	Intervals	3 to 10 =	39.79					

Ratio of Apprentices to Journeymen - 1:4

Craft: Heat & Frost Insulator

COMMENTS/NOTES

FOREMAN REQUIREMENTS:

- Foremen shall be designated based upon the number of Heat & Frost Insulators on the job, with the rates as shown above.
- If there is only 1 Heat & Frost Insulator on the job, he or she must be designated a Foreman.

The regular workday shall be 8 hours between 7:00 AM and 5:30 PM.

SHIFT DIFFERENTIALS:

- Shift work must run for a minimum of 3 consecutive workdays, with a minimum of 2 consecutive shifts each day.
- 2nd Shift shall be between the hours of 4:00 PM and 12:00 AM.
- 3rd Shift shall be between the hours of 12:00 AM and 8:00 AM.
- All shift work shall be paid an additional 15% of the regular rate, inclusive of benefits.

**NEW JERSEY DEPARTMENT OF LABOR AND WORKFORCE DEVELOPMENT
PREVAILING WAGE RATE DETERMINATION**

County - CAMDEN

OVERTIME:

- The 2 hours immediately before or after the regular workday, and the first 10 hours on Saturdays shall be paid at time and one-half the regular rate, inclusive of benefits. All hours in excess of 10 per day, Monday through Saturday, and all hours on Sundays and holidays (except Labor Day), shall be paid at double the regular rate, inclusive of benefits. All hours on Labor Day shall be paid at triple the regular rate, inclusive of benefits.
- Four 10-hour days may be worked, Monday through Thursday, at straight time, with Friday used as a make-up day for a day lost to inclement weather. If Friday is not a make-up day, all hours on Friday shall be paid at time and one-half the regular rate, inclusive of benefits.

RECOGNIZED HOLIDAYS: New Year's Day, Memorial Day, July 4th, Labor Day, Thanksgiving Day, Christmas Day. Sunday holidays observed the following Monday.

**NEW JERSEY DEPARTMENT OF LABOR AND WORKFORCE DEVELOPMENT
PREVAILING WAGE RATE DETERMINATION**

County - CAMDEN

Craft: Heat & Frost Insulator - Asbestos Worker

PREVAILING WAGE RATE

	05/01/24
Material Handler - 1st Level	W32.62 B23.87 T56.49
Material Handler - 2nd Level	W47.46 B23.77 T71.23
Mechanic (Journeyman)	W59.37 B46.03 T105.40

Craft: Heat & Frost Insulator - Asbestos Worker

APPRENTICE RATE SCHEDULE

INTERVAL	PERIOD AND RATES									
	SEE	Heat &	Frost	Insulator						

Craft: Heat & Frost Insulator - Asbestos Worker

COMMENTS/NOTES

NOTE: These rates apply ONLY to the REMOVAL of insulation containing asbestos from mechanical systems, including containment erection and demolition, and the placing of material in appropriate containers.

JOB TITLES:

- Mechanic: 8,000 hours or more of asbestos removal experience
- Material Handler - 2nd Level: 3,000 hours or more (up to 8,000 hours) of asbestos removal experience
- Material Handler - 1st Level: up to 3,000 hours of asbestos removal experience

RATIOS:

- The first worker on the project must be a Mechanic.
- Ratio of Material Handlers to Mechanics is 5:1 (5 Handlers to 1 Mechanic), with a minimum of two of the Handlers being 2nd Level Handlers.

SHIFT DIFFERENTIALS:

- 2nd Shift shall work 7.5 hours and receive 8 hours pay, plus \$0.25 per hour.
- 3rd Shift shall work 7 hours and receive 8 hours pay, plus \$0.50 per hour.

OVERTIME:

- Hours in excess of 40 per week, and all hours on Saturdays shall be paid at time and one-half the regular rate, inclusive of benefits.
- All hours on Sundays and holidays (except Labor Day) shall be paid at double the regular rate, inclusive of benefits.
- All hours on Labor Day shall be paid at triple the regular rate, inclusive of benefits.

RECOGNIZED HOLIDAYS: New Year's Day, Memorial Day, July 4th, Labor Day, Thanksgiving Day, Christmas Day. Sunday holidays observed the following Monday.

**NEW JERSEY DEPARTMENT OF LABOR AND WORKFORCE DEVELOPMENT
PREVAILING WAGE RATE DETERMINATION**

County - CAMDEN

Craft: Industrial Painter- Bridges

PREVAILING WAGE RATE

	02/07/25	02/01/26
Foreman	W64.80 B37.40 T102.20	W0.00 B0.00 T104.20
General Foreman	W67.30 B37.40 T104.70	W0.00 B0.00 T106.70
Journeyman	W59.80 B37.40 T97.20	W0.00 B0.00 T99.20

Craft: Industrial Painter- Bridges

APPRENTICE RATE SCHEDULE

INTERVAL	PERIOD AND RATES									
	50%	70%	90%							
6 Months										
Benefits	14.62	21.61	28.11							

Ratio of Apprentices to Journeymen - 1:3

Craft: Industrial Painter- Bridges

COMMENTS/NOTES

* Industrial Painters perform work on all industrial structures, such as bridges.

These rates apply to: All bridges that span waterways, roadways, railways and canyons. All tunnels, overpasses, viaducts and all appurtenances.

FOREMEN REQUIREMENTS:

- When there are 4 or more Painters on a job, 1 shall be designated a Foreman.
- When there are 15 or more Painters on a job, 1 shall be designated a General Foreman.

The regular workday shall consist of 8 hours between 7:00 AM and 5:30 PM.

SHIFT DIFFERENTIALS:

- The second shift shall receive an additional 10% of the hourly rate, per hour, and the third shift shall receive an additional 15% of the hourly rate, per hour.

OVERTIME:

- Hours in excess of 8 per day, Monday through Friday, and all hours on Saturdays and Sundays shall be paid at time and one-half the regular rate. All hours on holidays shall be paid at double the regular rate, except Veterans Day, which shall be paid at time and one-half the regular rate.
- During a regular work week schedule, Saturday may be used as a make-up day lost to inclement weather, paid at the regular rate.
- Four 10-hour days may be worked, at the regular rate, Monday through Thursday. When the four 10-hour day schedule is used, the 11th and 12th hours shall be paid at time and one-half the regular rate. After the 12th hour, a worker shall be paid at double the regular rate. Friday may be used as a make-up day lost to inclement weather, paid at the regular rate.

**NEW JERSEY DEPARTMENT OF LABOR AND WORKFORCE DEVELOPMENT
PREVAILING WAGE RATE DETERMINATION**

County - CAMDEN

RECOGNIZED HOLIDAYS: New Year's Day, President's Day, Memorial Day, July 4th, Labor Day, Presidential Election Day, Veterans Day, Thanksgiving Day, Christmas Day. Saturday holiday observed the preceding Friday. Sunday holiday observed the following Monday.

**NEW JERSEY DEPARTMENT OF LABOR AND WORKFORCE DEVELOPMENT
PREVAILING WAGE RATE DETERMINATION**

County - CAMDEN

Craft: Industrial Painter- Structural Steel

PREVAILING WAGE RATE

	02/07/25	02/01/26
Foreman	W53.54 B35.05 T88.59	W0.00 B0.00 T90.59
General Foreman	W56.04 B35.05 T91.09	W0.00 B0.00 T93.09
Journeyman	W48.54 B35.05 T83.59	W0.00 B0.00 T85.59

Craft: Industrial Painter- Structural Steel

APPRENTICE RATE SCHEDULE

INTERVAL	PERIOD AND RATES									
	SEE	INDUST	RIAL	PAINTER	BRIDGES					

Ratio of Apprentices to Journeymen - 1:3

Craft: Industrial Painter- Structural Steel

COMMENTS/NOTES

* Industrial Painters perform work on all industrial structures, such as water tanks, waste water facilities, refineries, any structural steel work, etc.

These rates apply to: All work in power plants (any aspect). On steeples, on dams, on hangers, transformers, substations, on all open steel, in refineries, tank farms, water/sewerage treatment facilities and on pipelines.

FOREMEN REQUIREMENTS:

- When there are 4 or more Painters on a job, 1 shall be designated a Foreman.
- When there are 15 or more Painters on a job, 1 shall be designated a General Foreman.

The regular workday shall consist of 8 hours between 7:00 AM and 5:30 PM.

SHIFT DIFFERENTIALS:

- The second shift shall receive an additional 10% of the hourly rate, per hour, and the third shift shall receive an additional 15% of the hourly rate, per hour.

OVERTIME:

- Hours in excess of 8 per day, Monday through Friday, and all hours on Saturdays and Sundays shall be paid at time and one-half the regular rate. All hours on holidays shall be paid at double the regular rate, except for Veterans Day, which shall be paid at time and one-half the regular rate.
- During the regular work week schedule, Saturday may be used to make-up a day lost to inclement weather, paid at the regular rate.
- Four 10-hour days may be worked, at the regular rate, Monday through Thursday. When the four 10-hour day schedule is used, the 11th and 12th hours shall be paid at time and one-half the regular rate. After the 12th hour, a worker shall be paid at double the regular rate. Friday may be used as a make-up day lost to inclement weather, paid at the regular rate.

**NEW JERSEY DEPARTMENT OF LABOR AND WORKFORCE DEVELOPMENT
PREVAILING WAGE RATE DETERMINATION**

County - CAMDEN

RECOGNIZED HOLIDAYS: New Year's Day, President's Day, Memorial Day, July 4th, Labor Day, Presidential Election Day, Veterans Day, Thanksgiving Day, Christmas Day. Saturday holiday observed the preceding Friday. Sunday holiday observed the following Monday.

**NEW JERSEY DEPARTMENT OF LABOR AND WORKFORCE DEVELOPMENT
PREVAILING WAGE RATE DETERMINATION**

County - CAMDEN

Craft: Industrial Painter- Water Tanks

PREVAILING WAGE RATE

	02/07/25	02/01/26
Foreman	W54.59 B34.70 T89.29	W0.00 B0.00 T91.29
General Foreman	W57.09 B34.70 T91.79	W0.00 B0.00 T93.79
Journeyman	W49.59 B34.70 T84.29	W0.00 B0.00 T86.29

Craft: Industrial Painter- Water Tanks

APPRENTICE RATE SCHEDULE

INTERVAL	PERIOD AND RATES									
	50%	70%	90%							
6 Months										
Benefits	14.62	21.61	28.11							

Ratio of Apprentices to Journeymen - 1:3

Craft: Industrial Painter- Water Tanks

COMMENTS/NOTES

* Industrial Painters perform work on all industrial structures, such as water tanks, waste water facilities, refineries, any structural steel work, etc.

These rates apply to: All new and repaint water tanks (interior and exterior).

FOREMEN REQUIREMENTS:

- When there are 4 or more Painters on a job, 1 shall be designated a Foreman.
- When there are 15 or more Painters on a job, 1 shall be designated a General Foreman.

The regular workday shall consist of 8 hours between 7:00 AM and 5:30 PM.

SHIFT DIFFERENTIALS:

- The second shift shall receive an additional 10% of the hourly rate, per hour, and the third shift shall receive an additional 15% of the hourly rate, per hour.

OVERTIME:

- Hours in excess of 8 per day, Monday through Friday, and all hours on Saturdays and Sundays shall be paid at time and one-half the regular rate. All hours on holidays shall be paid at double the regular rate, except Veterans Day, which shall be paid at time and one-half the regular rate.
- During a regular work week schedule, Saturday may be used to make-up a day lost to inclement weather, paid at the regular rate.
- Four 10-hour days may be worked, at the regular rate, Monday through Thursday. When the four 10-hour day schedule is used, the 11th and 12th hours shall be paid at time and one-half the regular rate. After the 12th hour, a worker shall be paid at double the regular rate. Friday may be used as a make-up day lost to inclement weather, paid at the regular rate.

**NEW JERSEY DEPARTMENT OF LABOR AND WORKFORCE DEVELOPMENT
PREVAILING WAGE RATE DETERMINATION**

County - CAMDEN

RECOGNIZED HOLIDAYS: New Year's Day, President's Day, Memorial Day, July 4th, Labor Day, Presidential Election Day, Veterans Day, Thanksgiving Day, Christmas Day. Saturday holiday observed the preceding Friday. Sunday holiday observed the following Monday.

**NEW JERSEY DEPARTMENT OF LABOR AND WORKFORCE DEVELOPMENT
PREVAILING WAGE RATE DETERMINATION**

County - CAMDEN

Craft: Ironworker

PREVAILING WAGE RATE

	07/12/24
Foreman- Fence and Guardrail	W55.91 B37.94 T93.85
Foreman-Rod/Mesh	W61.23 B38.72 T99.95
Foreman-Structural	W62.38 B38.72 T101.10
Journeyman- Fence and Guardrail	W51.77 B37.94 T89.71
Journeyman-Rod/Mesh	W53.24 B38.72 T91.96
Journeyman-Structural	W54.24 B38.72 T92.96

Craft: Ironworker

APPRENTICE RATE SCHEDULE

<u>INTERVAL</u>	<u>PERIOD AND RATES</u>									
Yearly	66%	79%	88%							

Ratio of Apprentices to Journeymen - *

* On all work EXCEPT Ornamental Iron and Bridge Cable Spinning Work 1:4; On Ornamental Iron and Bridge Cable Spinning Work 1:1.

Craft: Ironworker

COMMENTS/NOTES

ROD/MESH (REINFORCING): All work performed in connection with bending, burning, cutting, field fabrication, handling, hoisting, placing, racking, sorting, tying and welding of all materials, including composites used in reinforced concrete construction, all realigning of reinforcing steel and wire mesh and the placement of reinforcing dowels.

The installation, fabrication and distribution of all materials associated with post tensioning and pre-stressing procedures on reinforced concrete jobs.

All prefabricated mates, caissons, columns, beams and walls.

The installation of reinforcing dowels into pre-drilled holes by any means necessary, including epoxy, glue, compounds or tying.

STRUCTURAL: All work performed in connection with bending, burning, cutting, field fabrication, handling, hoisting, placing, racking, sorting, tying and welding of all materials, including composites and mass timbers used in structural frame construction, and realigning of structural framing members.

The installation, fabrication and distribution of all materials associated with structural framework, regardless of material composition, including mass timbers.

**NEW JERSEY DEPARTMENT OF LABOR AND WORKFORCE DEVELOPMENT
PREVAILING WAGE RATE DETERMINATION**

County - CAMDEN

All prefabricated columns, beams and walls.

When precast, prestressed or reinforced concrete structural members (beams, columns, girders, slabs, etc.) are used in construction of bridges, buildings and other structures, and power equipment such as cranes, derricks, jacks and/or rigging used, the work of loading, unloading, moving, and placing to complete erection.

Solar canopy erection, ground mounted installation and erection of photovoltaic array assemblies.

Unitized curtain wall systems, including erection and rigging of such, regardless of material composition.

Pre-engineered metal building systems.

Steel decking and siding for building structures and canopy systems.

Offshore wind erection, fabrication, and rigging of all related components.

FENCE AND GUARDRAIL: All work performed in connection with bending, burning, cutting, field fabrication, handling, hoisting, placing, racking, digging and anchoring, sorting, tying, welding and installation of all materials, including composites, security style fencing, regardless of materials used.

Installation, fabrication and distribution of all materials associated with Fence and Guardrail work scope, regardless of material composition.

All prefabricated fencing, permanent, temporary or otherwise.

Note: For work on hazardous waste sites, workers shall receive an additional \$3.00 per hour.

The regular workday shall consist of 8 hours between 6:00 AM and 5:00 PM.

SHIFT DIFFERENTIALS:

- Second shift shall receive an additional 10% per hour.
- Third shift shall receive an additional 15% per hour.
- An irregular shift (shift starting after 6:00 PM) shall receive an additional 15% per hour.

OVERTIME:

- Time and one-half the wage rate for hours in excess of 8 per day, or before or after the regular workday, Monday through Friday, and for all hours on Saturdays. Double the wage rate for all hours on Sundays and holidays.
- Employees may work four 10-hour days, Monday to Thursday, at straight time. Friday may be used as a make-up day for a day lost to inclement weather. If Friday is not a make-up day, all hours worked on Friday shall be paid at time and one-half the wage rate.
- Benefits on overtime hours shall be paid at the following rates:
 - For Rod/Mesh and Structural-
 - When wages are time and one-half, benefits = \$44.58.
 - When wages are double, benefits = \$50.44.
 - For Fence and Guardrail-
 - When wages are time and one-half, benefits = \$43.41.
 - When wages are double, benefits = \$48.88.

RECOGNIZED HOLIDAYS: New Year's Day, Memorial Day, July 4th, Labor Day, General and Presidential Election Day, Veterans Day, Thanksgiving Day, Christmas Day. Sunday holidays observed the following Monday.

**NEW JERSEY DEPARTMENT OF LABOR AND WORKFORCE DEVELOPMENT
PREVAILING WAGE RATE DETERMINATION**

County - CAMDEN

Craft: Laborer - Asbestos & Hazardous Waste Removal

PREVAILING WAGE RATE

	08/21/24
Foreman	W45.88 B26.21 T72.09
Journeyman (Handler)	W40.78 B26.21 T66.99

Craft: Laborer - Asbestos & Hazardous Waste Removal

APPRENTICE RATE SCHEDULE

INTERVAL	PERIOD AND RATES									
Yearly	24.47	28.55	32.62	36.70						
Benefits	22.31	for	all	intervals						

Ratio of Apprentices to Journeymen - *

* Ratio of apprentices to journeymen shall not be more than one apprentice for the first journeyman and no more than one (1) apprentice for each additional three (3) journeymen.

Craft: Laborer - Asbestos & Hazardous Waste Removal

COMMENTS/NOTES

NOTE: These rates apply to work in connection with Asbestos, Radiation, Hazardous Waste, Lead, Chemical, Biological, Mold Remediation and Abatement.

The regular workday shall be 8 hours.

OVERTIME:

- Hours in excess of 8 per day, Monday through Saturday, and all hours on Sunday and holidays shall be paid at time and one-half the regular rate.
- Benefits on ALL overtime hours shall be paid at straight time.

RECOGNIZED HOLIDAYS: New Year's Day, President's Day, Easter, Memorial Day, July 4th, Labor Day, Veterans Day, Thanksgiving Day, Christmas Day. (Holidays start at 12:00 am).

**NEW JERSEY DEPARTMENT OF LABOR AND WORKFORCE DEVELOPMENT
PREVAILING WAGE RATE DETERMINATION**

County - CAMDEN

Craft: Laborer - Building

PREVAILING WAGE RATE

	08/28/24
Class A Journeyman	W39.25 B33.17 T72.42
Class B Journeyman	W38.25 B33.17 T71.42
Class C Journeyman	W32.51 B33.17 T65.68
Foreman	W44.16 B33.17 T77.33
General Foreman	W49.06 B33.17 T82.23

Craft: Laborer - Building

APPRENTICE RATE SCHEDULE

INTERVAL	PERIOD AND RATES									
	60%	70%	80%	90%	of Class B	wage rate				
6 Months										
Benefit	29.92	29.92	29.92	29.92						

Ratio of Apprentices to Journeymen - *

* Ratio of apprentices to journeymen shall not be more than one apprentice for the first journeyman and no more than one (1) apprentice for each additional three (3) journeymen.

Craft: Laborer - Building

COMMENTS/NOTES

CLASS A: Specialist laborer including mason tender or concrete pour crew; scaffold builder (scaffolds up to 14 feet in height); operator of forklifts, Bobcats (or equivalent machinery), jack hammers, tampers, motorized tampers and compactors, vibrators, street cleaning machines, hydro demolition equipment, riding motor buggies, conveyors, burners; and nozzle men on gunite work.

CLASS B: Basic laborer - includes all laborer work not listed in Class A or Class C.

CLASS C: Janitorial-type light clean-up work associated with the TURNOVER of a project, or part of a project, to the owner. All other clean-up work is Class B.

The regular workday shall be 8 hours between 6:00 AM and 6:00 PM.

SHIFT DIFFERENTIALS:

- Shift work must run for a minimum of 5 consecutive workdays.
- When a 2-shift schedule is worked, including a day shift, both shifts shall be established on the basis of 8 hours pay for 8 hours worked. The second shift shall receive the regular rate plus an additional 10%.
- When a 3-shift schedule is worked, the day shift shall be established on the basis of 8 hours pay for 8 hours worked, the second shift shall be established on the basis of 8 hours pay for 7.5 hours worked, and the third shift shall be established

**NEW JERSEY DEPARTMENT OF LABOR AND WORKFORCE DEVELOPMENT
PREVAILING WAGE RATE DETERMINATION**

County - CAMDEN

on the basis of 8 hours pay for 7 hours worked. The day shift shall receive the regular rate, the second shift shall receive the regular rate plus an additional 10%, and the third shift shall receive the regular rate plus an additional 15%.

- When a second or third shift is worked with no day shift, the second or third shift shall be established on the basis of 8 hours pay for 8 hours worked. The second shift shall receive the regular rate plus an additional 10%, and the third shift shall receive the regular rate plus an additional 15%.

- When an irregular shift must be established this shift shall receive the regular rate plus an additional 10%.

OVERTIME:

- Hours in excess of 8 per day, or outside the regular workday that are not shift work, Monday through Friday, and all hours on Saturdays shall be paid at time and one-half the regular rate. Saturday may be used as a make-up day (paid at straight time) for a day lost to inclement weather, or for a holiday that is observed during the work week, Monday through Friday. All hours on Sundays and holidays shall be paid at double the regular rate.

- Four 10-hour days may be worked Monday to Thursday, at straight time, with Friday used a make-up day for a day lost to inclement weather. If Friday is not a make-up day, all hours on Friday shall be paid at time and one-half the regular rate.

- Benefits on ALL overtime hours shall be paid at time and one-half.

RECOGNIZED HOLIDAYS: New Year's Day, Presidents' Day, Memorial Day, July 4th, Labor Day, Veterans Day, Thanksgiving Day, Christmas Day. Sunday holidays observed the following Monday.

**NEW JERSEY DEPARTMENT OF LABOR AND WORKFORCE DEVELOPMENT
PREVAILING WAGE RATE DETERMINATION**

County - CAMDEN

Craft: Laborer - Heavy & General

PREVAILING WAGE RATE

Rates are located in the
"Statewide" rate package

Craft: Laborer - Heavy & General

APPRENTICE RATE SCHEDULE

INTERVAL	PERIOD AND RATES									
1000 Hours	60%	70%	80%	90%						
Benefit	25.08	for	all	intervals						

Ratio of Apprentices to Journeymen - *

* No more than 1 apprentice for the first journeyman and no more than 1 apprentice for each additional 3 journeymen.

As of 3-1-25, benefits shall be 26.13.

As of 3-1-26, benefits shall be 27.13.

Craft: Laborer - Heavy & General

COMMENTS/NOTES

Heavy & General Laborer rates are located in the "Statewide" rate package.

**NEW JERSEY DEPARTMENT OF LABOR AND WORKFORCE DEVELOPMENT
PREVAILING WAGE RATE DETERMINATION**

County - CAMDEN

Craft: Laborer-Residential and Modular Construction

PREVAILING WAGE RATE

	04/01/23
* Skilled Tradesman (only applies to Modular Construction)	W27.90 B5.45 T33.35
Foreman (person directing crew, regardless of his skill classification)	W31.90 B5.45 T37.35
Laborer (for single family and stand-alone duplex owned by single owner)	W17.85 B2.95 T20.80
Residential and Modular Construction Laborer	W23.90 B5.45 T29.35

Craft: Laborer-Residential and Modular Construction

APPRENTICE RATE SCHEDULE

INTERVAL	PERIOD AND RATES									
	As shown	800 hours	600 hours	600 hours						
wage & benefits	70%	80%	90%							

Ratio of Apprentices to Journeymen-

One (1) apprentice shall be allowed for the first journeyman on site and no more than one (1) additional apprentice for each additional three (3) journeymen on site.

Craft: Laborer-Residential and Modular Construction

COMMENTS/NOTES

* SKILLED TRADESMAN- any worker doing work not typically done by a Building Laborer. Some examples are installing interior doors, sheet rock, hooking up appliances, installing light fixtures, installing railing systems, etc. Please note where local building codes require that certain work be performed under the supervision of a licensed tradesman (i.e. Plumber, Electrician, etc.) Laborers shall work under such supervision.

RESIDENTIAL CONSTRUCTION- All residential construction (not commercial), single-family, stand-alone duplex houses, townhouses and multi-family buildings of not more than four (4) floors. Each housing unit must be fully and independently functional; each housing unit must have its own kitchen and bathroom. The definition includes all incidental items such as site work, parking areas, utilities, streets and sidewalks. Please note the construction must be Residential in nature. A First Floor at or below grade may contain commercial space not to exceed 50% square footage of the floor; at least 50% of the First Floor must contain living accommodations or related nonresidential uses (e.g. laundry space, recreation/hobby rooms, and/or corridor space). Basement stories below grade used for storage, parking, mechanical systems/equipment, etc., are considered basement stories which are not used in determining the building's height. An attic is an unfinished space located immediately below the roof. Such space is not used in determining a building's height even if used for storage purposes. In addition, barracks and dormitories are not considered residential projects.

MODULAR RESIDENTIAL CONSTRUCTION- all aspects of modular residential construction (not commercial) at the site of installation of structures of no more than four (4) stories, including all excavation and site preparation, footings and

**NEW JERSEY DEPARTMENT OF LABOR AND WORKFORCE DEVELOPMENT
PREVAILING WAGE RATE DETERMINATION**

County - CAMDEN

foundation systems whether poured on-site or prefabricated, all underground waterproofing, underground utilities, concrete slabs, sidewalks, driveways, paving, hardscape and landscaping. Please note the construction must be Residential as defined above. All work performed by the Set Crew (the crew of workers who set the modular boxes on the foundation), including the rigging, setting, attaching and assembly of all modules and structural members, preparation of the foundation to accept modules, such as sill plates, connection of all in-module and under-module connections including, but not limited to, plumbing, electrical, HVAC, fire suppression, CATS, telephone, television/internet, and fiber optic, the building or installation of any porches or decks regardless of material or method of construction, the on-site installation of, or completion of any roof system, doors, windows and fenestrations, including flashing, gutter and soffit systems, waterproofing, insulation and interior and exterior trim work, and painting. Please note that modular construction does not include on-site stick built construction, tip up construction or panel built construction.

The regular workday shall be 8 hours between 6:00 AM and 6:00 PM.

OVERTIME:

Hours worked in excess of 8 per day/40 per week, Monday through Saturday, and all hours worked on Sunday and holidays shall be paid at time and one-half the hourly rate.

RECOGNIZED HOILDAYS:

New Year's Day, Martin Luther King Day, Memorial Day, July 4th, Labor Day, Thanksgiving Day and Christmas Day.

**NEW JERSEY DEPARTMENT OF LABOR AND WORKFORCE DEVELOPMENT
PREVAILING WAGE RATE DETERMINATION**

County - CAMDEN

Craft: Millwright PREVAILING WAGE RATE

	05/01/24
Foreman	W66.04 B39.75 T105.79
Journeyman	W57.43 B34.65 T92.08

Craft: Millwright APPRENTICE RATE SCHEDULE

INTERVAL	PERIOD AND RATES									
6 Months	40%	55%	65%	80%	90%					
Benefits	59.25% of	Appren	tice	Wage	Rate	for all	intervals	+ \$0.62		

Ratio of Apprentices to Journeymen - 1:3

Craft: Millwright COMMENTS/NOTES

FOREMAN REQUIREMENTS:

- When there are 2 or more Millwrights on a job, 1 shall be designated as a Foreman.

The regular workday shall consist of 8 hours, starting between 6:00 AM and 9:00 AM.

SHIFT DIFFERENTIALS:

- When a 2 shift schedule (including a day shift) is established, the day shift shall be established on an 8 hour basis. The second shift shall be established on an 8 hour basis, and receive the regular rate plus 15%, inclusive of benefits.
- When a three shift schedule is established, the first shift shall be established on an 8 hour basis, the second shift on a 7.5 hour basis, and the third shift on a 7 hour basis. The first shift shall receive the regular hourly rate, the second shift shall receive the regular rate plus 15% and the third shift shall receive the regular rate plus 20%, inclusive of benefits.
- When there is no day shift, and a second or third shift is established, it shall be established on an 8 hour basis. The second shift shall receive the regular rate plus 15% and the third shift shall receive the regular rate plus 20%, inclusive of benefits.
- When an irregular shift must be established, this shift shall receive the regular rate plus 15%, inclusive of benefits.

OVERTIME:

- All hours in excess of 8 per day, or before or after an established shift that are not shift work, and all hours on Saturdays shall be paid at time and one-half the hourly rate, inclusive of benefits. All hours on Sundays and holidays shall be paid at double the hourly rate, inclusive of benefits.
- Four 10-hour days may be worked, Monday to Thursday, at straight time. Friday may be used as a make-up day for a day lost due to inclement weather. If Friday is not a make-up day, all hours on Friday shall be paid at time and one-half the hourly rate, inclusive of benefits.

RECOGNIZED HOLIDAYS: New Year's Day, Presidents' Day, Memorial Day, July 4th, Labor Day, Veterans' Day, Thanksgiving Day, Christmas Day. Sunday holidays will be observed the following Monday. Veterans' Day may be substituted for the day after Thanksgiving.

**NEW JERSEY DEPARTMENT OF LABOR AND WORKFORCE DEVELOPMENT
PREVAILING WAGE RATE DETERMINATION**

County - CAMDEN

Craft: **Operating Engineer** **PREVAILING WAGE RATE**

Rates are located in the
"Statewide" rate package

Craft: **Operating Engineer** **APPRENTICE RATE SCHEDULE**

INTERVAL	PERIOD AND RATES									
Yearly	60%	70%	80%	90%						

Ratio of Apprentices to Journeymen - *

* 1 apprentice for each piece of heavy equipment. At least 10 pieces of heavy equipment or a minimum of 5 Operating Engineers must be on site.

Craft: **Operating Engineer** **COMMENTS/NOTES**

Operating Engineer rates are located in the "Statewide" rate package.

**NEW JERSEY DEPARTMENT OF LABOR AND WORKFORCE DEVELOPMENT
PREVAILING WAGE RATE DETERMINATION**

County - CAMDEN

Craft: Operating Engineer - Field Engineer

PREVAILING WAGE RATE

Rates are located in the
"Statewide" rate package

Craft: Operating Engineer - Field Engineer

APPRENTICE RATE SCHEDULE

INTERVAL	PERIOD AND RATES									
Yearly	70%	75%	of Rod/	Chainman	Wage					
Yearly			80%	90%	Transit/	Instrument	man	Wage		

Ratio of Apprentices to Journeymen - *

* No more than 1 Field Engineer Apprentice per Survey Crew.

Craft: Operating Engineer - Field Engineer

COMMENTS/NOTES

Operating Engineer - Field Engineer rates are located in the "Statewide" rate package.

**NEW JERSEY DEPARTMENT OF LABOR AND WORKFORCE DEVELOPMENT
PREVAILING WAGE RATE DETERMINATION**

County - CAMDEN

Craft: Painter - Line Striping

PREVAILING WAGE RATE

	12/03/24
Apprentice (1st year)	W31.33 B16.18 T47.51
Apprentice (2nd year)	W35.74 B27.13 T62.87
Foreman (Charge Person)	W45.12 B27.91 T73.03
Journeyman 1 (at least 1 year of working exp. as a journeyman)	W40.35 B27.91 T68.26
Journeyman 2 (at least 2 years of working exp. as a journeyman)	W44.12 B27.91 T72.03

Craft: Painter - Line Striping

APPRENTICE RATE SCHEDULE

INTERVAL	PERIOD AND RATES									

Ratio of Apprentices to Journeymen - 1:1

Craft: Painter - Line Striping

COMMENTS/NOTES

OVERTIME:

Hours in excess of 8 per day, Monday through Saturday, and all hours on Sundays and holidays shall be paid at time and one-half the hourly rate.

RECOGNIZED HOLIDAYS: New Year's Day, Presidents' Day, Memorial Day, July 4th, Labor Day, Veterans Day, Thanksgiving Day and Christmas Day. Veterans Day may be substituted for the day after Thanksgiving.

**NEW JERSEY DEPARTMENT OF LABOR AND WORKFORCE DEVELOPMENT
PREVAILING WAGE RATE DETERMINATION**

County - CAMDEN

Craft: Paperhanger PREVAILING WAGE RATE

	05/29/24
Foreman	W53.79 B30.71 T84.50
Journeyman	W48.90 B30.71 T79.61

Craft: Paperhanger APPRENTICE RATE SCHEDULE

INTERVAL	PERIOD AND RATES									
	SEE	COMME R	CIAL	PAINTER						

Craft: Paperhanger COMMENTS/NOTES

FOREMEN REQUIREMENTS:

- When there are 4 or more Paperhangers on a job, 1 shall be designated a Foreman.

The regular workday shall consist of 8 hours between 7:00 AM and 5:30 PM.

SHIFT DIFFERENTIALS:

- The second shift shall receive an additional 10% of the hourly rate, per hour, and the third shift shall receive an additional 15% of the hourly rate, per hour.

OVERTIME:

- Hours in excess of 8 per day, Monday through Friday, and all hours on Saturdays shall be paid at time and one-half the regular rate. All hours on Sundays and holidays shall be paid at double the regular rate.
- Saturday or Sunday may be used to make up a day lost to inclement weather, at straight time.
- Four 10-hour days may be worked, at straight time, Monday through Friday.

RECOGNIZED HOLIDAYS: New Year's Day, President's Day, Memorial Day, July 4th, Labor Day, General Election Day, Veterans Day, Thanksgiving Day, Christmas Day

**NEW JERSEY DEPARTMENT OF LABOR AND WORKFORCE DEVELOPMENT
PREVAILING WAGE RATE DETERMINATION**

County - CAMDEN

Craft: Pipefitter **PREVAILING WAGE RATE**

See "Plumber" Rates

Craft: Pipefitter **COMMENTS/NOTES**

*** See PLUMBER Rates***

NEW JERSEY DEPARTMENT OF LABOR AND WORKFORCE DEVELOPMENT
PREVAILING WAGE RATE DETERMINATION

County - CAMDEN

Craft: Plasterer

PREVAILING WAGE RATE

See "Cement Mason" Rates

Craft: Plasterer

COMMENTS/NOTES

See CEMENT MASON Rates

**NEW JERSEY DEPARTMENT OF LABOR AND WORKFORCE DEVELOPMENT
PREVAILING WAGE RATE DETERMINATION**

County - CAMDEN

Craft: Plumber PREVAILING WAGE RATE

	05/01/24
Foreman	W58.16 B50.51 T108.67
Journeyman	W53.10 B50.51 T103.61

Craft: Plumber APPRENTICE RATE SCHEDULE

INTERVAL	PERIOD AND RATES									
6 Months	30%	35%	45%	50%	55%	60%	65%	70%	75%	80%
Benefits	32.24	33.55	36.16	37.46	38.76	40.06	41.37	42.67	43.99	45.29

Ratio of Apprentices to Journeymen - 1:4

Craft: Plumber COMMENTS/NOTES

FOREMAN REQUIREMENTS:

- On any job having 2 or more Journeyman Plumbers, 1 must be designated a Foreman.
- There must be 1 additional Foreman for every 10 Plumbers on the job.

The regular workday is 8 hours, between 7:00 AM and 4:30 PM.

SHIFT DIFFERENTIALS:

- Shift work must run for a minimum of 5 consecutive workdays.
- When 2 shifts are worked, the second shift shall receive 8 hours pay for 8 hours of work.
- When 3 shifts are worked, the second shift shall receive 8 hours pay for 7.5 hours of work, and the third shift shall receive 8 hours pay for 7 hours of work.
- The rate of pay for all shift work shall be an additional 15% of the hourly rate, per hour.

OVERTIME:

The first 4 hours in excess of 8 per day, or before or after the regular workday that are not shift work, Monday through Friday, and the first 12 hours on Saturdays shall be paid at time and one-half the regular rate, inclusive of benefits. Hours in excess of 12 per day, and all hours on Sundays and holidays shall be paid at double the regular rate, inclusive of benefits.

RECOGNIZED HOLIDAYS: New Year's Day, Presidents' Day, Memorial Day, July 4th, Labor Day, Presidential Election Day, Veterans' Day, Thanksgiving Day, Christmas Day. Sunday holidays will be observed the following Monday.

**NEW JERSEY DEPARTMENT OF LABOR AND WORKFORCE DEVELOPMENT
PREVAILING WAGE RATE DETERMINATION**

County - CAMDEN

Craft: Roofer PREVAILING WAGE RATE

	05/29/24
Foreman (5 workers or less)	W46.13 B34.77 T80.90
Foreman (6 workers or more)	W46.63 B34.77 T81.40
Journeyman	W44.13 B34.77 T78.90

Craft: Roofer APPRENTICE RATE SCHEDULE

INTERVAL	PERIOD AND RATES									
Yearly	52%	55%	60%	75%						
Benefits	23.39	28.04	34.77	34.77						

Ratio of Apprentices to Journeymen - *

* 1:2, 2:4, 3:6, 4:8, 5:10, 6:12, 7:14

Craft: Roofer COMMENTS/NOTES

NOTE: Mopper, Operator of Felt Laying Machine or Slag Dispenser shall receive an additional \$.50 per hour.

FOREMAN REQUIREMENTS:

- There must be a Foreman on all jobs.
- Foreman rate depends on the number of Roofers on the job, as indicated.

The regular workday is 8 hours between 5:00 AM and 4:30 PM.

OVERTIME:

Hours in excess of 8 per day, or before or after the regular workday, Monday through Friday, and all hours on Saturdays, Sundays, and holidays shall be paid at time and one-half the wage rate.

RECOGNIZED HOLIDAYS: New Year's Day, Memorial Day, July 4th, Labor Day, Thanksgiving Day, Christmas Day. Sunday holidays will be observed the following Monday.

**NEW JERSEY DEPARTMENT OF LABOR AND WORKFORCE DEVELOPMENT
PREVAILING WAGE RATE DETERMINATION**

County - CAMDEN

Craft: Roofer - Shingle, Slate & Tile

PREVAILING WAGE RATE

	05/29/24
Foreman (3 workers or less)	W34.85 B22.20 T57.05
Foreman (4 workers or more)	W35.35 B22.20 T57.55
Helper	W17.18 B22.20 T39.38
Journeyman (shingle work)	W34.35 B22.20 T56.55

Craft: Roofer - Shingle, Slate & Tile

APPRENTICE RATE SCHEDULE

INTERVAL	PERIOD AND RATES									
Yearly	60%	70%	80%							
Benefits	22.20	22.20	22.20							

Ratio of Apprentices to Journeymen - *

* 1:2, 2:4, 3:6, 4:8, 5:10, 6:12, 7:14

Craft: Roofer - Shingle, Slate & Tile

COMMENTS/NOTES

NOTE: Above rates are for Shingle work only. Slate and Tile work rates are an additional \$3.00 per hour.

HELPER RATIO: 1 Helper to 1 Journeyman

FOREMAN REQUIREMENTS:

- There must be a Foreman on all jobs.
- Foreman rate depends on the number of Roofers on the job, as indicated.

OVERTIME:

Hours in excess of 8 per day, Monday through Friday, and all hours on Saturdays, Sundays, and holidays shall be paid at time and one-half the wage rate.

RECOGNIZED HOLIDAYS: New Year's Day, Memorial Day, July 4th, Labor Day, Thanksgiving Day, Christmas Day. Sunday holidays will be observed the following Monday.

**NEW JERSEY DEPARTMENT OF LABOR AND WORKFORCE DEVELOPMENT
PREVAILING WAGE RATE DETERMINATION**

County - CAMDEN

Craft: Sheet Metal Sign Installation

PREVAILING WAGE RATE

	07/31/24
Foreman	W34.32 B25.82 T60.14
Journeyman	W32.32 B25.82 T58.14

Craft: Sheet Metal Sign Installation

APPRENTICE RATE SCHEDULE

INTERVAL	PERIOD AND RATES									
1000 Hours	50%	55%	60%	65%	70%	75%	80%	90%		
Benefits	22.99	23.07	23.14	23.23	24.32	24.40	24.47	24.63		

Ratio of Apprentices to Journeymen - 1:2

Craft: Sheet Metal Sign Installation

COMMENTS/NOTES

HAZARDOUS DUTY:

Sign Installers working from a bosun's chair or outside swinging scaffold at a height of 60 feet or more: + \$5.00 per hour.

FOREMAN REQUIREMENTS:

When there are 3 or more Sign Installers on a job, one must be designated a Foreman.

The regular workday shall be 8 hours, between 8:00 AM and 5:00 PM.

OVERTIME:

Hours in excess of 8 per day, or outside the regular workday, Monday through Friday, and all hours on Saturdays and Sundays shall be paid at time and one-half the regular rate. All hours on holidays shall be paid at time and one-half the regular rate.

RECOGNIZED HOLIDAYS: New Year's Day, Presidents' Day, Good Friday, Memorial Day, July 4th, Labor Day, Veterans' Day, Thanksgiving Day, day after Thanksgiving, Christmas Day. Saturday holidays will be observed the preceding Friday, Sunday holidays will be observed the following Monday.

**NEW JERSEY DEPARTMENT OF LABOR AND WORKFORCE DEVELOPMENT
PREVAILING WAGE RATE DETERMINATION**

County - CAMDEN

Craft: Sheet Metal Worker

PREVAILING WAGE RATE

	05/09/24
Foreman	W63.37 B50.56 T113.93
General Foreman	W67.51 B50.56 T118.07
Journeyman	W59.22 B50.56 T109.78

Craft: Sheet Metal Worker

APPRENTICE RATE SCHEDULE

INTERVAL	PERIOD AND RATES									
	40%	45%	55%	60%	65%	70%	75%	85%		
6 Months										
Benefits	30.72	30.75	35.46	35.49	35.52	35.55	35.58	35.63		

Ratio of Apprentices to Journeymen - 1:4

Craft: Sheet Metal Worker

COMMENTS/NOTES

FOREMAN REQUIREMENTS:

- When there are 1 to 10 Sheet Metal Workers on a job, 1 must be designated a foreman.
- When there are 11 to 20 Sheet Metal Workers on a job, 1 must be designated a foreman, and 1 must be designated a general foreman.
- When there are 21 or more Sheet Metal Workers on a job, 2 must be designated foremen, and 1 must be designated a general foreman.

The regular workday is 8 hours, between 7:00 AM and 3:30 PM.

SHIFT DIFFERENTIALS:

- Shift work must run for a minimum of 5 consecutive workdays.
- When 2 shifts are worked, the second shift shall receive 8 hours pay for 8 hours of work.
- When 3 shifts are worked, the second shift shall receive 8 hours pay for 7.5 hours of work, and the third shift shall receive 8 hours pay for 7 hours of work.
- The rate of pay for all shift work shall be an additional 15% of the regular rate, per hour, inclusive of benefits.

OVERTIME:

The first 2 hours in excess of 8 per day, or before or after the regular workday that are not shift work, and the first 10 hours on Saturdays shall be paid at time and one-half the regular rate, inclusive of benefits. Hours in excess of 10 per day, and all hours on Sundays and holidays shall be paid at double the regular rate, inclusive of benefits.

RECOGNIZED HOLIDAYS: New Year's Day, Good Friday, Memorial Day, July 4th, Labor Day, General Election Day, Thanksgiving Day, Christmas Day. Sunday holidays observed the following Monday.

**NEW JERSEY DEPARTMENT OF LABOR AND WORKFORCE DEVELOPMENT
PREVAILING WAGE RATE DETERMINATION**

County - CAMDEN

Craft: Sprinkler Fitter PREVAILING WAGE RATE

	01/10/25
Foreman	W70.12 B34.25 T104.37
Journeyman	W66.22 B34.25 T100.47

Craft: Sprinkler Fitter APPRENTICE RATE SCHEDULE

INTERVAL	PERIOD AND RATES									
6 Months	19.87	21.19	23.18	26.49	29.80	36.42	43.05	46.36	49.67	52.98
Benefits	13.95	13.95	16.95	24.35	24.85	25.35	25.35	25.85	26.35	27.35

Ratio of Apprentices to Journeymen - 1:4

Craft: Sprinkler Fitter COMMENTS/NOTES

The regular workday shall be 8 hours, between 7:00 AM and 4:30 PM.

SHIFT DIFFERENTIALS:

- Second and third shifts shall receive an additional 15% of the hourly rate, per hour.

OVERTIME:

- Hours outside of the regular workday, and the first 2 hours in excess of 8 per day (9th and 10th hours), Monday through Friday, and the first 8 hours on Saturdays shall be paid at time and one-half the hourly rate. Hours in excess of 10 per day, Monday through Friday, hours in excess of 8 on Saturdays, and all hours on Sundays and holidays shall be paid at double the hourly rate.
- Employees may work four 10-hour days at straight time, Monday through Friday, between 7:00 AM and 6:30 PM. The first 2 hours in excess of 10 per day (11th and 12th hours), the first 10 hours on the fifth day, and the first 10 hours on Saturdays shall be paid at time and one-half the hourly rate. Hours in excess of 12 per day, Monday through Friday, and all hours on Sundays and holidays shall be paid at double the hourly rate.

RECOGNIZED HOLIDAYS: New Year's Day, Memorial Day, July 4th, Labor Day, Thanksgiving Day, the day after Thanksgiving, Christmas Day. Sunday holidays will be observed the following Monday.

**NEW JERSEY DEPARTMENT OF LABOR AND WORKFORCE DEVELOPMENT
PREVAILING WAGE RATE DETERMINATION**

County - CAMDEN

Craft: Tile Worker PREVAILING WAGE RATE

	06/03/24
Finisher	W43.64 B30.86 T74.50
Setter	W52.32 B36.25 T88.57

Craft: Tile Worker APPRENTICE RATE SCHEDULE

INTERVAL	PERIOD AND RATES									
750 Hours	40%	45%	50%	55%	60%	65%	70%	75%	80%	90%

Ratio of Apprentices to Journeymen - 1:4

Craft: Tile Worker COMMENTS/NOTES

NOTE: These rates also apply to Terrazzo and Marble work.

OVERTIME:

Hours in excess of 8 per day, Monday through Friday, and the first 10 hours on Saturdays shall be paid at time and one half the regular rate, inclusive of benefits. Hours in excess of 10 on Saturdays, and all hours on Sundays and holidays shall be paid at double the regular rate, inclusive of benefits.

RECOGNIZED HOLIDAYS:

New Year's Day, Presidents' Day, Memorial Day, July 4th, Labor Day, Veterans' Day, Thanksgiving Day and Christmas Day. Sunday holidays shall be observed the following Monday.

**NEW JERSEY DEPARTMENT OF LABOR AND WORKFORCE DEVELOPMENT
PREVAILING WAGE RATE DETERMINATION**

County - CAMDEN

Craft: Truck Driver

PREVAILING WAGE RATE

	05/01/24
Bucket, Tack Spreader trucks	W43.30 B32.37 T75.67
Concrete mobile unit; Seeding/Fertilizing/ Mulching truck	W43.30 B32.37 T75.67
Dump, Water, Form, Vacuum or Vac-All, Pick-up trucks	W43.30 B32.37 T75.67
Helper on Straight 3-axle truck; Mechanic's helper	W43.10 B32.37 T75.47
Mechanics	W43.80 B32.37 T76.17
Shop Steward	W44.65 B32.37 T77.02
Straight 3-axle truck	W43.30 B32.37 T75.67
Tow truck	W43.45 B32.37 T75.82
Tractor-Trailer (any), Fuel, Winch, Asphalt Oil Distributor trucks	W43.65 B32.37 T76.02

Craft: Truck Driver

COMMENTS/NOTES

HAZARDOUS WASTE WORK:

- On hazardous waste removal work on a State-designated hazardous waste site where the driver is in direct contact with hazardous materials and when personal protective equipment is required for respiratory, skin, and eye protection: + \$3.00 per hour.
- All other designated hazardous waste sites: + \$1.00 per hour.

SHIFT DIFFERENTIALS:

- Second and Third shifts shall receive an additional \$1.50 per hour.

OVERTIME:

- Hours in excess of 8 per day, Monday through Friday, and all hours on

**NEW JERSEY DEPARTMENT OF LABOR AND WORKFORCE DEVELOPMENT
PREVAILING WAGE RATE DETERMINATION**

County - CAMDEN

Saturdays shall be paid at time and one-half the hourly rate. All hours on Sundays and holidays shall be paid at double the hourly rate.

- Four 10-hour days may be worked at straight time, Monday through Thursday, with Friday used as a make-up day. If Friday is not a make-up day, then all hours on Friday shall be paid at time and one-half the hourly rate.

RECOGNIZED HOLIDAYS: New Year's Day, President's Day, Memorial Day, July 4th, Labor Day, Presidential Election Day, Veterans' Day, Thanksgiving Day, Christmas Day. The day after Thanksgiving may be substituted for Veterans' Day.

NEW JERSEY DEPARTMENT OF LABOR AND WORKFORCE DEVELOPMENT
PREVAILING WAGE RATE DETERMINATION

County - CAMDEN

Craft: Truck Driver-Material Delivery Driver

PREVAILING WAGE RATE

	05/01/24
Driver	W37.90 B32.37 T70.27

Craft: Truck Driver-Material Delivery Driver

COMMENTS/NOTES

These rates apply to delivery of materials TO a jobsite.

SHIFT DIFFERENTIALS:

- Second and Third shifts shall receive an additional \$1.50 per hour.

OVERTIME:

- Hours in excess of 8 per day, Monday through Friday, and all hours on Saturdays shall be paid at time and one-half the hourly rate. All hours on Sundays and holidays shall be paid at double the hourly rate.
- Four 10-hour days may be worked at straight time, Monday through Thursday, with Friday used as a make-up day. If Friday is not a make-up day, then all hours on Friday shall be paid at time and one-half the hourly rate.

RECOGNIZED HOLIDAYS: New Year's Day, President's Day, Memorial Day, July 4th, Labor Day, Presidential Election Day, Veterans' Day, Thanksgiving Day, Christmas Day. The day after Thanksgiving may be substituted for Veterans' Day.

NEW JERSEY DEPARTMENT OF LABOR AND WORKFORCE DEVELOPMENT
PREVAILING WAGE RATE DETERMINATION

County - CAMDEN

Craft: Welder

PREVAILING WAGE RATE

Welder

Craft: Welder

COMMENTS/NOTES

Welders rate is the same as the craft to which the welding is incidental .

STATEWIDE RATES

OPERATING ENGINEERS Rates Expiration Date :

{For apprentice rates refer to "Operating Engineers" apprentice rates in any county rate package}

The regular workday consists of 8 hours, Monday to Friday, between 6:00 AM and 5:30 PM.

SHIFT DIFFERENTIALS:

- Shift work must be established for 5 consecutive workdays.
- Any work started outside of the allowed start time, 6:00 AM to 9:00 AM, except for * tidal work, shall be considered an irregular shift and paid at straight time, plus 15% for the first eight hours, inclusive of benefits.
- * FOR TIDAL WORK- a contractor can start their job according to tide schedules (tide schedules are the various high and low tides related to this work), providing the eight hour shift is completed between the hours of 5:00 AM and 6:30 PM.
- All time worked in excess of an established shift (an established shift is a shift that is determined at the time of the bid) shall be paid at the applicable overtime rate. When a portion of an established shift works into Saturday, Sunday or a holiday, that time worked shall be paid at the established shift rate.
- When working with other trades who receive a higher irregular shift differential, these employees shall also receive the higher differential rate.

OVERTIME:

- Hours in excess of 8 per day, or outside of the regular workday, Monday through Friday, that are not shift work, and all hours on Saturday shall be paid at time and one-half the regular rate, inclusive of benefits. All hours on Sunday and holidays shall be paid at double the regular rate, inclusive of benefits.
- Four 10-hour days may be worked, Monday through Thursday, at straight time, with all hours on Friday paid at time and one-half the regular rate, inclusive of benefits.

RECOGNIZED HOLIDAYS: New Year's Day, Presidents' Day, Memorial Day, July 4th, Labor Day, Presidential Election Day, Veterans Day, Thanksgiving Day, Christmas Day. Sunday holidays observed the following Monday. When all trades on a particular job site agree, the day after Thanksgiving may be substituted for Veterans Day.

For projects bid after April 1, 2020, on hazardous waste removal work of any kind, including a state or federally designated site, where the operating engineer is required to wear level A, B, or C personal protection, the operating engineer shall receive an hourly wage rate of his regular hourly wage plus \$5.00 per hour.

- An operating engineer working at a hazardous waste removal project or site at a task requiring hazardous waste related certification, but who is not working in a zone requiring level A, B, or C personal protection, shall receive an hourly wage rate of his regular rate plus \$1.00 per hour.

OPERATING ENGINEERS **Rates Expiration Date :**

Effective Dates:

07/01/2024			07/01/2025
Rate	Fringe	Total	Total
58.88	39.15	98.03	100.53

CLASSIFICATIONS:

A-Frame

Backhoe (combination)

Boom Attachment on loaders (Except pipehook)

Boring & Drilling Machine

Brush Chopper, Brush Shredder, Tree Shredder, Tree Shearer

Bulldozer, finish grade

Cableway

Carryall

Concrete Pump

Concrete Pumping System (Pumpcrete & similar types)

Conveyor, 125 feet or longer

Drill Doctor (Duties include dust collector and maintenance)

Front End Loader (2 cu. yds. but less than 5 cu. yds.)

Grader, finish

Groove Cutting Machine (ride-on type)

Heater Planer

Hoist: Outside Material Tower Hoist (all types including steam, gas, diesel, electric, air hydraulic, single and double drum, concrete, brick shaft caisson, snorkle roof, and other similar types, Except Chicago-boom type) * receives an additional \$1.00 per hour on 100 ft. up to 199 ft. total height, and an additional \$2.00 per hour on 200 ft. and over total height.

Hydraulic Crane (10 tons & under)

Hydraulic Dredge

Hydro-Axe

Hydro-Blaster

OPERATING ENGINEERS **Rates Expiration Date :**

Effective Dates:

07/01/2024			07/01/2025
Rate	Fringe	Total	Total
58.88	39.15	98.03	100.53

CLASSIFICATIONS:

Jack (screw, air hydraulic, power-operated unit, or console type, Except hand jack or pile load test type)

Log Skidder

Pan

Paver, concrete

Plate & Frame Filter Press

Pumpcrete (unit type)

Pumpcrete, Squeezecrete, or Concrete Pumping machine (regardless of size)

Scraper

Side Boom

Straddle Carrier (Ross and similar types)

Whiphammer

Winch Truck (hoisting)

OPERATING ENGINEERS **Rates Expiration Date :**

Effective Dates:

07/01/2024			07/01/2025
Rate	Fringe	Total	Total
56.97	39.15	96.12	98.62

CLASSIFICATIONS:

- Asphalt Curbing Machine
- Asphalt Plant Engineer
- Asphalt Spreader
- Autograde Curb Trimmer & Sidewalk Shoulder Slipform (CMI & similar types)
- Autograde Curecrete Machine (CMI & similar types)
- Autograde Tube Finisher & Texturing Machine (CMI & similar types)
- Bar Bending Machines (Power)
- Batcher, Batching Plant, & Crusher [On Site]
- Belt Conveyor System
- Boom-Type Skimmer Machine
- Bridge Deck Finisher
- Bulldozer (all sizes)
- Captain (Power Boats)
- Car Dumper (railroad)
- Compressor & Blower unit for loading/unloading of concrete, cement, fly ash, or similar type materials (used independently or truck-mounted)
- Compressor (2 or 3 battery)
- Concrete Breaking Machine
- Concrete Cleaning/Decontamination Machine
- Concrete Finishing Machine
- Concrete Saw or Cutter (ride-on type)
- Concrete Spreader (Hetzl, Rexomatic & similar types)
- Concrete Vibrator

OPERATING ENGINEERS **Rates Expiration Date :**

Effective Dates:

07/01/2024			07/01/2025
Rate	Fringe	Total	Total
56.97	39.15	96.12	98.62

CLASSIFICATIONS:

- Conveyors - under 125 feet
- Crane Signalman
- Crushing Machine
- Directional Boring Machine
- Ditching Machine - Small (Ditchwitch, Vermeer or similar types)
- Dope Pot - Mechanical (with or without pump)
- Dumpster
- Elevator
- Fireman
- Fork Lift (Economobile, Lull & similar types)
- Front End Loader (1 cu. yd. and over but less than 2 cu. yds.)
- Generator (2 or 3 battery)
- Giraffe Grinder
- Goldhofer/Hydraulic Jacking Trailer
- Grader & Motor Patrols
- Grout Pump
- Gunnite Machine (Excluding nozzle)
- Hammer - Vibratory (in conjunction with generator)
- Heavy Equipment Robotics - Operator/Technician
- Hoist (roof, tigger, aerial platform hoist, house car)
- Hopper
- Hopper Doors (power operated)
- Ladder (motorized)

OPERATING ENGINEERS **Rates Expiration Date :**

Effective Dates:

07/01/2024			07/01/2025
Rate	Fringe	Total	Total
56.97	39.15	96.12	98.62

CLASSIFICATIONS:

Laddervator

Locomotive (Dinky-type)

Maintenance Utility Man

Master Environmental Maintenance Technician

Mechanic

Mixer (Except paving mixers)

Pavement Breaker (truck-mounted or small self-propelled ride-on type)

Pavement Breaker - maintenance of compressor or hydraulic unit

Pipe Bending Machine (power)

Pitch Pump

Plaster Pump (regardless of size)

Post Hole Digger (post pounder, auger)

Rod Bending Machines

Roller (black top)

Scale (power)

Seamen Pulverizing Mixer

Shoulder Widener

Silo

Skimmer Machine (boom type)

Steel Cutting Machine (service & maintenance)

Tamrock Drill

Tractor

Transfer Machines

OPERATING ENGINEERS **Rates Expiration Date :**

Effective Dates:

07/01/2024			07/01/2025
Rate	Fringe	Total	Total
56.97	39.15	96.12	98.62

CLASSIFICATIONS:

Tug Captains

Tug Master (Power Boats)

Ultra High Pressure Waterjet Cutting Tool System -
Operator/Maintenance Technician

Vacuum Blasting Machine - Operator/Maintenance Technician

Vibrating Plant (used with unloading)

Welder & Repair Mechanic

Effective Dates:

07/01/2024			07/01/2025
Rate	Fringe	Total	Total
51.63	39.15	90.78	93.28

CLASSIFICATIONS:

Assistant Engineer/Oiler

Driller's Helper

Field Engineer - Transit man or Instrument man

Maintenance Apprentice (Deckhand)

Maintenance Apprentice (Oiler)

Mechanic's Helper

Off Road Back Dump

Tire Repair & Maintenance

Effective Dates:

07/01/2024			07/01/2025
Rate	Fringe	Total	Total
49.05	39.15	88.20	90.70

CLASSIFICATIONS:

Field Engineer - Rodman or Chainman

TERRITORY
ENTIRE STATE

NEW JERSEY DEPARTMENT OF LABOR AND WORKFORCE DEVELOPMENT
PREVAILING WAGE RATE DETERMINATION

OPERATING ENGINEERS Rates Expiration Date :

Effective Dates:

07/01/2024			07/01/2025
Rate	Fringe	Total	Total
59.21	39.15	98.36	100.86

CLASSIFICATIONS:

Lead Engineer, Foreman Engineer, Safety Engineer (minimum)

OPERATING ENGINEERS **Rates Expiration Date :**

Effective Dates:

07/01/2024			07/01/2025
Rate	Fringe	Total	Total
60.47	39.15	99.62	102.12

CLASSIFICATIONS:

- Autograde Pavement Profiler (CMI & similar types)
- Autograde Pavement Profiler - Recycle Type (CMI & similar types)
- Autograde Placer/Trimmer/Spreader Combination (CMI & similar types)
- Autograde Slipform Paver (CMI & similar types)
- Backhoe (Excavator)
- Central Power Plant
- Concrete Paving Machine
- Cranes, Derricks, Pile Drivers (all types), under 100 tons with a boom (including jib and/or leads) under 100 ft.
- Draglines
- Drill, Bauer, AMI and similar types
- Drillmaster, Quarrymaster
- Drillmaster/Quarrymaster (down-the-hole drill), rotary drill, self-propelled hydraulic drill, self-powered drill
- Elevator Grader
- Field Engineer-Chief of Party
- Front End Loader (5 cu. yards or larger)
- Gradall
- Grader, Rago
- Helicopter Co-Pilot
- Helicopter Communications Engineer
- Juntann Pile Driver
- Locomotive (large)
- Mucking Machine

OPERATING ENGINEERS **Rates Expiration Date :**

Effective Dates:

07/01/2024			07/01/2025
Rate	Fringe	Total	Total
60.47	39.15	99.62	102.12

CLASSIFICATIONS:

Pavement & Concrete Breaker (Superhammer & Hoe Ram)

Pile Driver

Prentice Truck

Roadway Surface Grinder

Scooper (loader & shovel)

Shovel (Excavator)

Trackhoe (Excavator)

Tree Chopper with boom

Trenching Machine (cable plow)

Tunnel Boring Machine

Vacuum Truck

OPERATING ENGINEERS **Rates Expiration Date :**

Effective Dates:

07/01/2024			07/01/2025
Rate	Fringe	Total	Total
55.34	39.15	94.49	96.99

CLASSIFICATIONS:

- Chipper
- Compressor (single)
- Concrete Spreader (small type)
- Conveyor Loader (Except elevator graders)
- Engines, Large Diesel (1620 HP) & Staging Pump
- Farm Tractor
- Fertilizing Equipment (operation & maintenance)
- Fine Grade Machine (small type)
- Form Line Grader (small type)
- Front End Loader (under 1 cubic yard)
- Generator (single)
- Grease, Gas, Fuel, & Oil Supply Trucks
- Heaters (Nelson or other type)
- Lights - portable generating light plant
- Mixer, Concrete (small)
- Mulching Equipment (operation & maintenance)
- Power Broom or Sweeper
- Pump (diesel engine & hydraulic - regardless of power)
- Pump (larger than 2 inch suction, including submersible pumps)
- Road Finishing Machine (small type)
- Roller - grade, fill, or stone base
- Seeding Equipment (operation & maintenance)
- Sprinkler & Water Pump Trucks

OPERATING ENGINEERS **Rates Expiration Date :**

Effective Dates:

07/01/2024			07/01/2025
Rate	Fringe	Total	Total
55.34	39.15	94.49	96.99

CLASSIFICATIONS:

Steam Generator or Boiler

Stone Spreader

Tamping Machine (vibrating ride-on type)

Temporary Heating Plant (Nelson or other type, including
proprane, natural gas, and flow-type units)

Water or Sprinkler Truck

Welding Machine (gas, diesel, or electric convertor, of any type)

Welding System - Multiple (rectifier transformer type)

Wellpoint Systems (including installation by bull gang and
maintenance)

Effective Dates:

07/01/2024			07/01/2025
Rate	Fringe	Total	Total
62.29	39.15	101.44	103.94

CLASSIFICATIONS:

Helicopter Pilot/Engineer

Effective Dates:

07/01/2024			07/01/2025
Rate	Fringe	Total	Total
66.97	39.15	106.12	108.62

CLASSIFICATIONS:

Cranes, Derricks, Pile Driver (all types), 100 tons and over and TOWER CRANE with boom (including jib and/or leads) 140 ft. and over

Effective Dates:

07/01/2024			07/01/2025
Rate	Fringe	Total	Total
65.97	39.15	105.12	107.62

CLASSIFICATIONS:

Cranes, Derricks, Pile Driver (all types), 100 tons and over and TOWER CRANE with boom (including jib and/or leads) from 100 ft. to
139 ft.

OPERATING ENGINEERS **Rates Expiration Date :**

Effective Dates:

07/01/2024			07/01/2025
Rate	Fringe	Total	Total
62.47	39.15	101.62	104.12

CLASSIFICATIONS:

Cranes, Derricks, Pile Driver (all types) , under 100 tons with a boom (including jib and/or leads) 140 ft. and over

Effective Dates:

07/01/2024			07/01/2025
Rate	Fringe	Total	Total
64.97	39.15	104.12	106.62

CLASSIFICATIONS:

Cranes, Derricks, Pile Driver (all types), 100 tons and over and TOWER CRANE with a boom (including jib and/or leads) under 100 ft.

Effective Dates:

07/01/2024			07/01/2025
Rate	Fringe	Total	Total
61.47	39.15	100.62	103.12

CLASSIFICATIONS:

Cranes, Derricks, Pile Driver (all types), under 100 tons with a boom (including jib and/or leads) from 100 ft. to 139 ft.

STRUCTURAL STEEL ERECTION Rates Expiration Date :

{For apprentice rates refer to "Operating Engineers" apprentice rates in any county rate package}

The regular workday consists of 8 hours, Monday to Friday, between 6:00 AM and 5:30 PM.

SHIFT DIFFERENTIALS:

- Shift work must be established for 5 consecutive workdays.
- Any work started outside of the allowed start time, 6:00 AM to 9:00 AM, except for * tidal work, shall be considered an irregular shift and paid at straight time, plus 15% for the first eight hours, inclusive of benefits.
- * FOR TIDAL WORK- a contractor can start their job according to tide schedules (tide schedules are the various high and low tides related to this work), providing the eight hour shift is completed between the hours of 5:00 AM and 6:30 PM.
- All time worked in excess of an established shift (an established shift is a shift that is determined at the time of the bid) shall be paid at the applicable overtime rate. When a portion of an established shift works into Saturday, Sunday or a holiday, that time worked shall be paid at the established shift rate.
- When working with other trades who receive a higher irregular shift differential, these employees shall also receive the higher differential rate.

OVERTIME:

- Hours in excess of 8 per day, or outside of the regular workday, Monday through Friday, that are not shift work, and all hours on Saturday shall be paid at time and one-half the regular rate, inclusive of benefits. All hours on Sunday and holidays shall be paid at double the regular rate, inclusive of benefits.
- Four 10-hour days may be worked, Monday through Thursday, at straight time, with all hours on Friday paid at time and one-half the regular rate, inclusive of benefits.

RECOGNIZED HOLIDAYS: New Year's Day, Presidents' Day, Memorial Day, July 4th, Labor Day, Presidential Election Day, Veterans Day, Thanksgiving Day, Christmas Day. Sunday holidays observed the following Monday. When all trades on a particular job site agree, the day after Thanksgiving may be substituted for Veterans Day.

For projects bid after April 1, 2020, on hazardous waste removal work of any kind, including a state or federally designated site, where the operating engineer is required to wear level A, B, or C personal protection, the operating engineer shall receive an hourly wage rate of his regular hourly wage plus \$5.00 per hour.

- An operating engineer working at a hazardous waste removal project or site at a task requiring hazardous waste related certification, but who is not working in a zone requiring level A, B, or C personal protection, shall receive an hourly wage rate of his regular rate plus \$1.00 per hour.

Effective Dates:

07/01/2024			07/01/2025
Rate	Fringe	Total	Total
64.10	39.15	103.25	105.75

CLASSIFICATIONS:

Helicopter Co-Pilot & Communications Engineer

TERRITORY
ENTIRE STATE

NEW JERSEY DEPARTMENT OF LABOR AND WORKFORCE DEVELOPMENT
PREVAILING WAGE RATE DETERMINATION

STRUCTURAL STEEL ERECTION Rates Expiration Date :

Effective Dates:

07/01/2024			07/01/2025
Rate	Fringe	Total	Total
60.04	39.15	99.19	101.69

CLASSIFICATIONS:

A-Frame

Cherry Picker -10 tons or less (Over 10 tons use crane rate)

Hoist (all types Except Chicago-boom)

Jack (screw, air hydraulic, power-operated unit or console type, Except hand jack or pile load test type)

Side Boom

Straddle Carrier

STRUCTURAL STEEL ERECTION **Rates Expiration Date :**

Effective Dates:

07/01/2024			07/01/2025
Rate	Fringe	Total	Total
57.38	39.15	96.53	99.03

CLASSIFICATIONS:

- Aerial Platform Used On Hoists
- Apprentice Engineer/Oiler with Compressor or Welding Machine
- Captain (Power Boats)
- Compressor (2 or 3 in battery)
- Concrete Cleaning/Decontamination Machine Operator
- Conveyor or Tugger Hoist
- Directional Boring Machine
- Elevator or House Car
- Fireman
- Forklift
- Generator (2 or 3)
- Heavy Equipment Robotics, Operator/Technician
- Maintenance Utility Man
- Master Environmental Maintenance Technician
- Tug Master (Power Boats)
- Ultra High Pressure Waterjet Cutting Tool System Operator/Maintenance Technician
- Vacuum Blasting Machine Operator/Maintenance Technician
- Welding Machines, Gas or Electric Converters on any type-2 or 3 in battery including diesels

STRUCTURAL STEEL ERECTION **Rates Expiration Date :**

Effective Dates:

07/01/2024			07/01/2025
Rate	Fringe	Total	Total
55.85	39.15	95.00	97.50

CLASSIFICATIONS:

Compressor (Single)

Generators

Welding Machines, Gas, Diesel, Or Electric Converters of any type-single

Welding System, Multiple (Rectifier Transformer Type)

Effective Dates:

07/01/2024			07/01/2025
Rate	Fringe	Total	Total
52.09	39.15	91.24	93.74

CLASSIFICATIONS:

Assistant Engineer/Oiler

Drillers Helper

Field Engineer - Transit/Instrument Man

Maintenance Apprentice (Deckhand)

Maintenance Apprentice (Oiler)

Off Road Back Dump

Effective Dates:

07/01/2024			07/01/2025
Rate	Fringe	Total	Total
59.66	39.15	98.81	101.31

CLASSIFICATIONS:

Lead Engineer, Foreman Engineer, Safety Engineer (Minimum)

Effective Dates:

07/01/2024			07/01/2025
Rate	Fringe	Total	Total
49.05	39.15	88.20	90.70

CLASSIFICATIONS:

Field Engineer - Rodman or Chainman

STRUCTURAL STEEL ERECTION **Rates Expiration Date :**

Effective Dates:

07/01/2024			07/01/2025
Rate	Fringe	Total	Total
60.80	39.15	99.95	102.45

CLASSIFICATIONS:

Field Engineer-Chief of Party

Vacuum Truck

Effective Dates:

07/01/2024			07/01/2025
Rate	Fringe	Total	Total
68.99	39.15	108.14	110.64

CLASSIFICATIONS:

Cranes (all cranes, land or floating with booms, including jib, 140 ft. and over, above ground). Derricks (all derricks, land, floating or Chicago Boom type with booms including jib, 140 ft. and over, above ground), and Pile Drivers (all types) 100 tons and over and Tower Cranes.

Effective Dates:

07/01/2024			07/01/2025
Rate	Fringe	Total	Total
67.33	39.15	106.48	108.98

CLASSIFICATIONS:

Cranes (all cranes, land or floating with booms including jib, less than 140 ft. above ground), Derricks (all derricks, land, floating or Chicago Boom type with booms including jib, less than 140 ft. above ground), Pile Drivers (all types), 100 tons and over and Tower Crane.

Effective Dates:

07/01/2024			07/01/2025
Rate	Fringe	Total	Total
64.49	39.15	103.64	106.14

CLASSIFICATIONS:

Cranes (all cranes, land or floating with booms including jib, 140 ft. and over, above ground), Derricks (all derricks, land, floating or Chicago Boom type with booms including jib, 140 ft. and over, above ground), Pile Drivers (all types), under 100 tons.

Effective Dates:

07/01/2024			07/01/2025
Rate	Fringe	Total	Total
62.83	39.15	101.98	104.48

CLASSIFICATIONS:

Cranes (all cranes, land or floating with booms including jib, less than 140 ft. above ground), Derricks (all derricks, land, floating or Chicago Boom type with booms including jib, less than 140 ft. above ground), Pile Drivers (all types), under 100 tons.

TERRITORY
ENTIRE STATE

NEW JERSEY DEPARTMENT OF LABOR AND WORKFORCE DEVELOPMENT
PREVAILING WAGE RATE DETERMINATION

STRUCTURAL STEEL ERECTION Rates Expiration Date :

Effective Dates:

07/01/2024			07/01/2025
Rate	Fringe	Total	Total
64.49	39.15	103.64	106.14

CLASSIFICATIONS:

Helicopter Pilot & Engineer

TEST BORING PRELIMINARY TO CONSTRUCTION-SOUTH/WEST Rates Expiration Date :

THESE RATES APPLY IN THE FOLLOWING COUNTIES ONLY:

Atlantic, Burlington, Camden, Cape May, Cumberland, Gloucester, Hunterdon, Mercer, Monmouth, Ocean, Salem, Sussex, Warren

The regular workday consists of 8 hours, Monday to Friday, between 6:00 AM and 5:30 PM.

SHIFT DIFFERENTIALS:

- Shift work must be established for 5 consecutive workdays.
- Any work started outside of the allowed start time, 6:00 AM to 9:00 AM, except for * tidal work, shall be considered an irregular shift and paid at straight time, plus 15% for the first eight hours, inclusive of benefits.
- * FOR TIDAL WORK- a contractor can start their job according to tide schedules (tide schedules are the various high and low tides related to this work), providing the eight hour shift is completed between the hours of 5:00 AM and 6:30 PM.
- All time worked in excess of an established shift (an established shift is a shift that is determined at the time of the bid) shall be paid at the applicable overtime rate. When a portion of an established shift works into Saturday, Sunday or a holiday, that time worked shall be paid at the established shift rate.
- When working with other trades who receive a higher irregular shift differential, these employees shall also receive the higher differential rate.

OVERTIME:

- Hours in excess of 8 per day, or outside of the regular workday, Monday through Friday, that are not shift work, and all hours on Saturday shall be paid at time and one-half the regular rate, inclusive of benefits. All hours on Sunday and holidays shall be paid at double the regular rate, inclusive of benefits.
- Four 10-hour days may be worked, Monday through Thursday, at straight time, with all hours on Friday paid at time and one-half the regular rate, inclusive of benefits.

RECOGNIZED HOLIDAYS: New Year's Day, Presidents' Day, Memorial Day, July 4th, Labor Day, Presidential Election Day, Veterans Day, Thanksgiving Day, Christmas Day. Sunday holidays observed the following Monday. When all trades on a particular job site agree, the day after Thanksgiving may be substituted for Veterans Day.

For projects bid after April 1, 2020, on hazardous waste removal work of any kind, including a state or federally designated site, where the operating engineer is required to wear level A, B, or C personal protection, the operating engineer shall receive an hourly wage rate of his regular hourly wage plus \$5.00 per hour.

- An operating engineer working at a hazardous waste removal project or site at a task requiring hazardous waste related certification, but who is not working in a zone requiring level A, B, or C personal protection, shall receive an hourly wage rate of his regular rate plus \$1.00 per hour.

Effective Dates:

07/01/2024			07/01/2025
Rate	Fringe	Total	Total
60.47	39.15	99.62	102.12

CLASSIFICATIONS:

Driller

Effective Dates:

07/01/2024			07/01/2025
Rate	Fringe	Total	Total
53.63	39.15	92.78	95.28

CLASSIFICATIONS:

Driller's Helper

FREE AIR TUNNEL JOBS **Rates Expiration Date :**

{For apprentice rates refer to "Heavy & General" apprentice rates in any county rate package}

The regular workday consists of 8 hours, starting at 7:00 AM or 8:00 AM.

SHIFT DIFFERENTIALS:

- Shifts must start at 3:00 PM, 4:00 PM, 12:00 AM, or 1:00 AM, to be considered shift work, except when the project owner mandates special hours of work in the job specifications, in which case those hours may be considered shift work.
- When such hours are mandated by the project owner, a shift that begins before midnight on Friday and ends on Saturday morning, or that begins at or after 8:00 PM on Sunday and ends on Monday morning may be paid at the shift differential rate.
- Shifts shall receive an additional \$3.00 per hour.

OVERTIME:

- Hours in excess of 8 per day, Monday through Friday, or outside of the regular workday that are not shift work, and all hours on Saturdays, shall be paid at time and one-half the hourly rate. All hours on Sundays and holidays shall be paid at double the hourly rate.
- Four 10-hour days may be worked, Monday through Thursday, at straight time, with Friday used as a make-up day for a day lost to inclement weather. If Friday is not a make-up day, all hours on Friday shall be paid at time and one-half the hourly rate.

RECOGNIZED HOLIDAYS: New Year's Day, Presidents' Day, Memorial Day, July 4th, Labor Day, Presidential Election Day, Veterans' Day, Thanksgiving Day, Christmas Day. Sunday holidays observed the following Monday. Veterans Day may be substituted for the day after Thanksgiving. However, in the trading of Veterans Day for the day after Thanksgiving, if overtime is worked on Veterans Day, it shall be paid at double the hourly rate.

Hazardous Waste Work:

- where Level A, B, or C protection is required: + \$5.00/hr
- other Hazardous Waste site: + \$1.00/hr

Traffic Control Coordinator: When either of the work classifications found below are working as a Traffic Control Coordinator they are to receive \$.75 above their current rate of pay.

Effective Dates:

	04/17/2024		03/01/2025	03/01/2026
Rate	Fringe	Total	Total	Total
65.06	37.33	102.39	106.26	109.94

CLASSIFICATIONS:

Walking Boss & Superintendent

Effective Dates:

	04/17/2024		03/01/2025	03/01/2026
Rate	Fringe	Total	Total	Total
64.69	37.33	102.02	105.88	109.57

CLASSIFICATIONS:

Heading Foreman, Shaft Foreman, Rod Foreman, Electrician Foreman, Rigging Foreman

FREE AIR TUNNEL JOBS **Rates Expiration Date :**

Effective Dates:

	04/17/2024		03/01/2025	03/01/2026
Rate	Fringe	Total	Total	Total
64.06	37.33	101.39	105.26	108.94

CLASSIFICATIONS:

Iron Foreman, Caulking Foreman, Form Foreman, Cement Finishing Foreman, Concrete Foreman, Track Foreman, Cleanup Foreman, Grout Foreman

Effective Dates:

	04/17/2024		03/01/2025	03/01/2026
Rate	Fringe	Total	Total	Total
67.19	37.33	104.52	108.38	112.07

CLASSIFICATIONS:

Blaster

Effective Dates:

	04/17/2024		03/01/2025	03/01/2026
Rate	Fringe	Total	Total	Total
63.38	37.33	100.71	104.57	108.26

CLASSIFICATIONS:

Top Labor Foreman

Effective Dates:

	04/17/2024		03/01/2025	03/01/2026
Rate	Fringe	Total	Total	Total
62.94	37.33	100.27	104.13	107.82

CLASSIFICATIONS:

Skilled Men (including Caulker, Powder Carrier, all other skilled men)

Skilled Men (including Miner, Drill Runner, Iron Man, Conveyor Man, Manintenance Man, Safety Miner, Rigger, Block Layer, Cement Finisher, Tod Man)

Effective Dates:

	04/17/2024		03/01/2025	03/01/2026
Rate	Fringe	Total	Total	Total
62.75	37.33	100.08	103.94	107.63

CLASSIFICATIONS:

Semi-Skilled Men (including Bell or Signal Man Top or Bottom, Form Worker & Mover, Concrete Worker, Shaft Man, Tunnel Laborer, Caulker's Helper, all other semi-skilled)

Semi-Skilled Men (including Miner's Helper, Chuck Tender, Track Man, Nipper, Brake Man, Derail Man, Cable Man, Hose Man, Gravel Man, Form Man)

TERRITORY
ENTIRE STATE

NEW JERSEY DEPARTMENT OF LABOR AND WORKFORCE DEVELOPMENT
PREVAILING WAGE RATE DETERMINATION

FREE AIR TUNNEL JOBS Rates Expiration Date :

Effective Dates:

	04/17/2024		03/01/2025	03/01/2026
Rate	Fringe	Total	Total	Total
62.25	37.33	99.58	103.44	107.13

CLASSIFICATIONS:

All Others (including Powder Watchman, Change House Attendant, Top Laborer)

DRILL FOR GROUND WATER SUPPLY **Rates Expiration Date :**

The well driller and/or helper may perform all work relative to the construction, finishing, and servicing of wells, pumps and borings for ground water supply. The present methods of well drilling entailing as they do, many diverse job operations calling for drilling, pump discharge, piping, and the operation of various types of related power equipment, shall all be within the job duties and functions of the well driller and/or helper. In the event that an extension of work should occur beyond water well drilling functions, into the field of general construction work, such extension of work would come under the appropriate rates listed elsewhere in this wage determination.

- For Work Hours, Shift Differentials, Overtime Rates, and Recognized Holidays see the "Operating Engineers" section of this wage determination.

Effective Dates:

07/01/2024			07/01/2025
Rate	Fringe	Total	Total
59.22	39.15	98.37	100.87

CLASSIFICATIONS:

Driller

Effective Dates:

07/01/2024			07/01/2025
Rate	Fringe	Total	Total
52.38	39.15	91.53	94.03

CLASSIFICATIONS:

Driller's Helper

OPERATING ENGINEERS MARINE-DREDGING **Rates Expiration Date :**

NOTE: These wage rates only apply to dredging and other marine construction activities occurring in navigable waters and their tributaries.

Boat crews carrying explosive material (dynamite, pourfex, and other similar materials) shall be paid at 120% of the hourly wage rate for hours engaged in handling of said materials. Employees required to possess a Hazardous Material Certification as a condition of employment shall be compensated at 120% of the hourly wage rate.

OVERTIME:

Hours in excess of 40 per week, and all hours on Saturdays and Sundays, shall be paid at time and one-half the hourly rate. All hours on holidays shall be paid at double the hourly rate.

RECOGNIZED HOLIDAYS: New Year's Day, Martin Luther King Day, Good Friday, Memorial Day, July 4th, Labor Day, Veterans Day, Thanksgiving Day, Christmas Day. Sunday holidays observed the following Monday.

Effective Dates:

10/03/2024			10/01/2025	10/01/2026
Rate	Fringe	Total	Total	Total
47.07	15.34	62.41	63.92	65.74

CLASSIFICATIONS:

Lead Dredgerman, Operator, Leverman

Licensed Tug Operator with MOTV, Deck Captain

Effective Dates:

10/03/2024			10/01/2025	10/01/2026
Rate	Fringe	Total	Total	Total
40.71	14.90	55.61	56.92	58.47

CLASSIFICATIONS:

Derrick Operator, Spider/Spill Barge Operator

Engineer, Electrician, Chief Welder, Chief Mate

Fill Placer, Operator II

Licensed Boat Operator

Maintenance Engineer

Effective Dates:

10/03/2024			10/01/2025	10/01/2026
Rate	Fringe	Total	Total	Total
38.31	14.73	53.04	54.27	55.75

CLASSIFICATIONS:

Certified Welder

OPERATING ENGINEERS MARINE-DREDGING **Rates Expiration Date :**

Effective Dates:

10/03/2024			10/01/2025	10/01/2026
Rate	Fringe	Total	Total	Total
37.26	14.66	51.92	53.12	54.54

CLASSIFICATIONS:

Mate, Drag Barge Operator, Steward, Assistant Fill Placer

Welder

Effective Dates:

10/03/2024			10/01/2025	10/01/2026
Rate	Fringe	Total	Total	Total
36.07	14.57	50.64	51.80	53.18

CLASSIFICATIONS:

Boat Operator

Effective Dates:

10/03/2024			10/01/2025	10/01/2026
Rate	Fringe	Total	Total	Total
29.96	14.15	44.11	45.07	46.22

CLASSIFICATIONS:

Shoreman, Deckhand, Rodman, Scowman

Effective Dates:

10/03/2024			10/01/2025	10/01/2026
Rate	Fringe	Total	Total	Total
41.94	14.99	56.93	58.27	59.89

CLASSIFICATIONS:

Crane Operator

MICROSURFACING/SLURRY SEAL Rates Expiration Date :

THESE RATES APPLY IN THE FOLLOWING COUNTIES ONLY:

Atlantic, Burlington, Camden, Cape May, Cumberland, Gloucester, Mercer, Ocean, Salem

IN ALL OTHER COUNTIES use the Heavy and General Laborers - North "Slurry Seal Laborer" rates.

SHIFT DIFFERENTIALS:

Any shift starting at 3:30 PM or later shall receive an additional \$0.35/hr

OVERTIME:

Hours in excess of 8 per day or 40 per week shall be paid at time and one-half the hourly rate. All hours on holidays shall be paid at double the hourly rate.

RECOGNIZED HOLIDAYS: New Year's Day, Washington's Birthday, Memorial Day, July 4th, Labor Day, Presidential Election Day, Veterans' Day, Thanksgiving Day, Christmas Day.

Effective Dates:

03/01/2017

Rate	Fringe	Total
36.50	21.27	57.77

CLASSIFICATIONS:

Foreman

Effective Dates:

03/01/2017

Rate	Fringe	Total
33.80	21.27	55.07

CLASSIFICATIONS:

Box man

Effective Dates:

03/01/2017

Rate	Fringe	Total
31.75	21.27	53.02

CLASSIFICATIONS:

Microsurface/Slurry Preparation

Effective Dates:

03/01/2017

Rate	Fringe	Total
31.75	21.27	53.02

CLASSIFICATIONS:

Squeegee man

TERRITORY
ENTIRE STATE

NEW JERSEY DEPARTMENT OF LABOR AND WORKFORCE DEVELOPMENT
PREVAILING WAGE RATE DETERMINATION

MICROSURFACING/SLURRY SEAL Rates Expiration Date :

Effective Dates:

03/01/2017

Rate	Fringe	Total
30.30	21.27	51.57

CLASSIFICATIONS:

Cleaner, Taper

ASPHALT LABORERS - SOUTH **Rates Expiration Date :**

"THESE RATES APPLY IN THE FOLLOWING COUNTIES ONLY: Atlantic, Burlington, Camden, Cape May, Cumberland, Gloucester, Mercer, Ocean, Salem

{For apprentice rates refer to "Laborer - Heavy & General" apprentice rates in any county rate package}

The regular workday consists of 8 hours, starting at 7:00 AM or 8:00 AM.

SHIFT DIFFERENTIALS:

- Shifts must start at 3:00 PM, 4:00 PM, 12:00 AM, or 1:00 AM, to be considered shift work, except when the project owner mandates special hours of work in the job specifications, in which case those hours may be considered shift work.
- When such hours are mandated by the project owner, a shift that begins before midnight on Friday and ends on Saturday morning, or that begins at or after 8:00 PM on Sunday and ends on Monday morning may be paid at the shift differential rate.
- Shifts shall receive an additional \$3.00 per hour.

OVERTIME:

- Hours in excess of 8 per day, Monday through Friday, or outside of the regular workday that are not shift work, and all hours on Saturdays, shall be paid at time and one-half the hourly rate. All hours on Sundays and holidays shall be paid at double the hourly rate.
- Four 10-hour days may be worked, Monday through Thursday, at straight time, with Friday used as a make-up day for a day lost to inclement weather. If Friday is not a make-up day, all hours on Friday shall be paid at time and one-half the hourly rate.

RECOGNIZED HOLIDAYS: New Year's Day, Presidents' Day, Memorial Day, July 4th, Labor Day, Presidential Election Day, Veterans' Day, Thanksgiving Day, Christmas Day. Sunday holidays observed the following Monday. Veterans Day may be substituted for the day after Thanksgiving. However, in the trading of Veterans Day for the day after Thanksgiving, if overtime is worked on Veterans Day, it shall be paid at double the hourly rate.

Hazardous Waste Work:

- where Level A, B, or C protection is required: + \$5.00/hr
- other Hazardous Waste site: + \$1.00/hr

FOR TIDE WORK (pertains to tidal water): A contractor can start their job according to tide schedules (tide schedules are the various high and low tides related to this work) providing the eight (8) hour shift is completed between the hours of 5:00 AM and 6:30 PM.

Effective Dates:

	03/21/2024		03/01/2025	03/01/2026
Rate	Fringe	Total	Total	Total
53.55	37.33	90.88	94.33	97.58

CLASSIFICATIONS:

Paving Foreman

Effective Dates:

	03/21/2024		03/01/2025	03/01/2026
Rate	Fringe	Total	Total	Total
50.10	37.33	87.43	90.88	94.13

CLASSIFICATIONS:

Head Raker

Effective Dates:

	03/21/2024		03/01/2025	03/01/2026
Rate	Fringe	Total	Total	Total
50.25	37.33	87.58	91.03	94.28

CLASSIFICATIONS:

Screedman

ASPHALT LABORERS - SOUTH **Rates Expiration Date :**

Effective Dates:

03/21/2024			03/01/2025	03/01/2026
Rate	Fringe	Total	Total	Total
49.70	37.33	87.03	90.48	93.73

CLASSIFICATIONS:

Tampers, Smoothers, Kettlemen,
Painters, Shovelers, Roller Boys

Effective Dates:

03/21/2024			03/01/2025	03/01/2026
Rate	Fringe	Total	Total	Total
49.80	37.33	87.13	90.58	93.83

CLASSIFICATIONS:

Milling Controller

Effective Dates:

03/21/2024			03/01/2025	03/01/2026
Rate	Fringe	Total	Total	Total
50.00	37.33	87.33	90.78	94.03

CLASSIFICATIONS:

Traffic Control Coordinator

Effective Dates:

03/21/2024			03/01/2025	03/01/2026
Rate	Fringe	Total	Total	Total
49.95	37.33	87.28	90.73	93.98

CLASSIFICATIONS:

Raker, Luteman

Effective Dates:

Rate	Fringe	Total
------	--------	-------

CLASSIFICATIONS:

Certified Paving Foreman

TEST BORING PRELIMINARY TO CONSTRUCTION-NORTH Rates Expiration Date :

THESE RATES APPLY IN THE FOLLOWING COUNTIES ONLY:
Bergen, Essex, Hudson, Middlesex, Morris, Passaic, Somerset, Union

SHIFT DIFFERENTIAL:

Employees on a shift other than between the hours of 8:00 AM and 5:00 PM shall receive an additional \$2.00 per hour.

OVERTIME:

Hours in excess of 8 per day, Monday through Friday, and all hours on Saturday shall be paid at time and one-half the regular rate. All hours on Sundays and holidays shall be paid at double the regular rate.

RECOGNIZED HOLIDAYS: New Year's Day, Memorial Day, July 4th, Labor Day, Thanksgiving Day, and Christmas Day. Sunday holidays observed the following Monday.

Hazardous Waste Pay (for Levels A, B, and C): an additional 15% of the hourly rate, per hour.

A newly hired Helper with no experience in the industry shall be paid as follows:

- 1st year on the job - 70% of Helper wage rate
- 2nd year on the job - 80% of Helper wage rate
- 3rd year on the job - 90% of Helper wage rate
- All helpers receive full fringe benefit rate.

Effective Dates:

10/18/2024

Rate	Fringe	Total
37.58	34.49	72.07

CLASSIFICATIONS:

Helper (4th year helper)

Effective Dates:

10/18/2024

Rate	Fringe	Total
47.88	34.49	82.37

CLASSIFICATIONS:

Driller

Effective Dates:

10/18/2024

Rate	Fringe	Total
54.50	34.49	88.99

CLASSIFICATIONS:

Foreman

HEAVY & GENERAL LABORERS - NORTH **Rates Expiration Date :**

THESE RATES APPLY IN THE FOLLOWING COUNTIES ONLY:

Bergen, Essex, Hudson, Hunterdon, Middlesex, Monmouth, Morris, Passaic, Somerset, Sussex, Union, Warren

{For apprentice rates refer to "Laborer - Heavy & General" apprentice rates in any county rate package}

The regular workday consists of 8 hours, starting at 7:00 AM or 8:00 AM.

SHIFT DIFFERENTIALS:

- Shifts must start at 3:00 PM, 4:00 PM, 12:00 AM, or 1:00 AM, to be considered shift work, except when the project owner mandates special hours of work in the job specifications, in which case those hours may be considered shift work.
- When such hours are mandated by the project owner, a shift that begins before midnight on Friday and ends on Saturday morning, or that begins at or after 8:00 PM on Sunday and ends on Monday morning may be paid at the shift differential rate.
- Shifts shall receive an additional \$3.00 per hour.

FOR TIDE WORK (pertains to tidal water): A contractor can start their job according to tide schedules (tide schedules are the various high and low tides related to this work) providing the eight (8) hour shift is completed between the hours of 5:00 AM and 6:30 PM.

OVERTIME:

- Hours in excess of 8 per day, Monday through Friday, or outside of the regular workday that are not shift work, and all hours on Saturdays, shall be paid at time and one-half the hourly rate. All hours on Sundays and holidays shall be paid at double the hourly rate.
- Four 10-hour days may be worked, Monday through Thursday, at straight time, with Friday used as a make-up day for a day lost to inclement weather. If Friday is not a make-up day, all hours on Friday shall be paid at time and one-half the hourly rate.

RECOGNIZED HOLIDAYS: New Year's Day, Presidents' Day, Memorial Day, July 4th, Labor Day, Presidential Election Day, Veterans' Day, Thanksgiving Day, Christmas Day. Sunday holidays observed the following Monday. Veterans Day may be substituted for the day after Thanksgiving. However, in the trading of Veterans Day for the day after Thanksgiving, if overtime is worked on Veterans Day, it shall be paid at double the hourly rate.

Hazardous Waste Work:

- where Level A, B, or C protection is required: + \$5.00/hr
- other Hazardous Waste site: + \$1.00/hr

Effective Dates:

	11/12/2024		03/01/2025	03/01/2026
Rate	Fringe	Total	Total	Total
49.30	37.33	86.63	90.08	93.33

CLASSIFICATIONS:

"D" Rate:

basic, landscape, asphalt, slurry seal, or railroad track laborer; utility meter installer; flagman; salamander tender; pitman; dumpman; rakers or tampers on cold patch work; wrappers or coaters of pipe; waterproofer; timberman; wagon drill or drill master helper; powder carrier; magazine tender; signal man; power buggy operator; tree cutter; operator of basic power tools

Effective Dates:

	11/12/2024		03/01/2025	03/01/2026
Rate	Fringe	Total	Total	Total
50.00	37.33	87.33	90.78	94.03

CLASSIFICATIONS:

"C" Rate:

pipe layer; laser man; conduit or duct line layer; operator of jack hammer, chipping hammer, pavement breaker, concrete cutter, asphalt cutter, sheet hammer, or walk-behind saw cutter; sandblaster; acetylene cutting or burning; wagon drill, directional drill, or hydraulic drill operator; drill master; core driller; asphalt raker or lute man

HEAVY & GENERAL LABORERS - NORTH **Rates Expiration Date :**

Effective Dates:

	11/12/2024		03/01/2025	03/01/2026
Rate	Fringe	Total	Total	Total
50.25	37.33	87.58	91.03	94.28

CLASSIFICATIONS:

"B" Rate:

concrete finisher; setter of brick or stone pavers; stone cutter; form setter; manhole, catch basin, or inlet builder; asphalt screedman; rammer; hardscaping; gunite nozzle man

Effective Dates:

	11/12/2024		03/01/2025	03/01/2026
Rate	Fringe	Total	Total	Total
53.80	37.33	91.13	94.58	97.83

CLASSIFICATIONS:

"A" Rate:

blaster

Effective Dates:

	11/12/2024		03/01/2025	03/01/2026
Rate	Fringe	Total	Total	Total
53.55	37.33	90.88	94.33	97.58

CLASSIFICATIONS:

"FOREMAN" Rate:

labor foreman, asphalt foreman, drill foreman, pipe foreman, grade foreman, finisher foreman, concrete foreman

Effective Dates:

	11/12/2024		03/01/2025	03/01/2026
Rate	Fringe	Total	Total	Total
54.55	37.33	91.88	95.33	98.58

CLASSIFICATIONS:

"GENERAL FOREMAN" Rate

Effective Dates:

	11/12/2024		03/01/2025	03/01/2026
Rate	Fringe	Total	Total	Total
50.75	37.33	88.08	91.53	94.78

CLASSIFICATIONS:

TRAFFIC CONTROL COORDINATOR Rate

TERRITORY
ENTIRE STATE

NEW JERSEY DEPARTMENT OF LABOR AND WORKFORCE DEVELOPMENT
PREVAILING WAGE RATE DETERMINATION

HEAVY & GENERAL LABORERS - NORTH **Rates Expiration Date :**

Effective Dates:

11/12/2024			03/01/2025	03/01/2026
Rate	Fringe	Total	Total	Total
54.05	37.33	91.38	95.83	100.08

CLASSIFICATIONS:

" CERTIFIED FOREMAN Rate" :

Effective Dates:

11/12/2024			03/01/2025	03/01/2026
Rate	Fringe	Total	Total	Total
55.05	37.33	92.38	96.83	101.08

CLASSIFICATIONS:

" CERTIFIED GENERAL FOREMAN Rate" :

HEAVY & GENERAL LABORERS - SOUTH **Rates Expiration Date :**

THESE RATES APPLY IN THE FOLLOWING COUNTIES ONLY:

Atlantic, Burlington, Camden, Cape May, Cumberland, Gloucester, Mercer, Ocean, Salem

{For apprentice rates refer to "Laborer - Heavy & General" apprentice rates in any county rate package}

The regular workday consists of 8 hours, starting at 7:00 AM or 8:00 AM.

SHIFT DIFFERENTIALS:

- Shifts must start at 3:00 PM, 4:00 PM, 12:00 AM, or 1:00 AM, to be considered shift work, except when the project owner mandates special hours of work in the job specifications, in which case those hours may be considered shift work.
- When such hours are mandated by the project owner, a shift that begins before midnight on Friday and ends on Saturday morning, or that begins at or after 8:00 PM on Sunday and ends on Monday morning may be paid at the shift differential rate.
- Shifts shall receive an additional \$3.00 per hour.

FOR TIDE WORK (pertains to tidal water): A contractor can start their job according to tide schedules (tide schedules are the various high and low tides related to this work) providing the eight (8) hour shift is completed between the hours of 5:00 AM and 6:30 PM.

OVERTIME:

- Hours in excess of 8 per day, Monday through Friday, or outside of the regular workday that are not shift work, and all hours on Saturdays, shall be paid at time and one-half the hourly rate. All hours on Sundays and holidays shall be paid at double the hourly rate.
- Four 10-hour days may be worked, Monday through Thursday, at straight time, with Friday used as a make-up day for a day lost to inclement weather. If Friday is not a make-up day, all hours on Friday shall be paid at time and one-half the hourly rate.

RECOGNIZED HOLIDAYS: New Year's Day, Presidents' Day, Memorial Day, July 4th, Labor Day, Presidential Election Day, Veterans' Day, Thanksgiving Day, Christmas Day. Sunday holidays observed the following Monday. Veterans Day may be substituted for the day after Thanksgiving. However, in the trading of Veterans Day for the day after Thanksgiving, if overtime is worked on Veterans Day, it shall be paid at double the hourly rate.

Hazardous Waste Work:

- where Level A, B, or C protection is required: + \$5.00/hr
- other Hazardous Waste site: + \$1.00/hr

Effective Dates:

	12/31/2024		03/01/2025	03/01/2026
Rate	Fringe	Total	Total	Total
49.30	37.33	86.63	90.08	93.33

CLASSIFICATIONS:

"D" Rate:

basic, landscape, asphalt, slurry seal, or railroad track laborer; utility meter installer; flagman; salamander tender; pitman; dumpman; rakers or tampers on cold patch work; wrappers or coaters of pipe; waterproofer; timberman; wagon drill or drill master helper; powder carrier; magazine tender; signal man; power buggy operator; tree cutter; operator of basic power tools

Effective Dates:

	12/31/2024		03/01/2025	03/01/2026
Rate	Fringe	Total	Total	Total
50.00	37.33	87.33	90.78	94.03

CLASSIFICATIONS:

"C" Rate:

pipe layer; laser man; conduit or duct line layer; operator of jack hammer, chipping hammer, pavement breaker, concrete cutter, asphalt cutter, sheet hammer, or walk-behind saw cutter; sandblaster; acetylene cutting or burning; wagon drill, directional drill, or hydraulic drill operator; drill master; core driller; asphalt raker or lute man

HEAVY & GENERAL LABORERS - SOUTH **Rates Expiration Date :**

Effective Dates:

12/31/2024			03/01/2025	03/01/2026
Rate	Fringe	Total	Total	Total
53.80	37.33	91.13	94.58	97.83

CLASSIFICATIONS:

"A" Rate:
blaster

Effective Dates:

12/31/2024			03/01/2025	03/01/2026
Rate	Fringe	Total	Total	Total
53.55	37.33	90.88	94.33	97.58

CLASSIFICATIONS:

"FOREMAN" Rate:
labor foreman, asphalt foreman, drill foreman, pipe foreman, grade foreman, finisher foreman, concrete foreman

Effective Dates:

12/31/2024			03/01/2025	03/01/2026
Rate	Fringe	Total	Total	Total
54.55	37.33	91.88	95.33	98.58

CLASSIFICATIONS:

"GENERAL FOREMAN" Rate

Effective Dates:

12/31/2024			03/01/2025	03/01/2026
Rate	Fringe	Total	Total	Total
50.75	37.33	88.08	91.53	94.78

CLASSIFICATIONS:

TRAFFIC CONTROL COORDINATOR Rate

Effective Dates:

12/31/2024			03/01/2025	03/01/2026
Rate	Fringe	Total	Total	Total
55.05	37.33	92.38	96.83	101.08

CLASSIFICATIONS:

" CERTIFIED GENERAL FOREMAN Rate" :

TERRITORY
ENTIRE STATE

NEW JERSEY DEPARTMENT OF LABOR AND WORKFORCE DEVELOPMENT
PREVAILING WAGE RATE DETERMINATION

HEAVY & GENERAL LABORERS - SOUTH **Rates Expiration Date :**

Effective Dates:

12/31/2024			03/01/2025	03/03/2026
Rate	Fringe	Total	Total	Total
54.05	37.33	91.38	95.83	100.08

CLASSIFICATIONS:

" CERTIFIED FOREMAN Rate" :

Effective Dates:

12/31/2024			03/01/2025	03/01/2026
Rate	Fringe	Total	Total	Total
50.25	37.33	87.58	91.03	94.28

CLASSIFICATIONS:

"B" Rate:

concrete finisher; setter of brick or stone pavers; stone cutter; form setter; manhole, catch basin, or inlet builder; asphalt screedman; rammer; hardscaping; gunite nozzle man

PIPELINE - MAINLINE TRANSMISSION Rates Expiration Date :

These rates apply to the following: welding on Transportation Mainline pipe lines (cross-country pipe lines, or any segments thereof, transporting coal, gas, oil, water or other transportable materials, vapors or liquids, including portions of such pipe lines within private property boundaries up to the final metering station or connection - the point where a valve, consumer connection, or town border station divides mainline transmission lines or higher pressure lateral and branch lines from lower pressure distribution systems).

PER DIEM PAYMENT:

In addition to the total wage rate paid for each craft, the following per diem (per day) amounts must also be paid - Pipeline Journeyman: \$80.50; Pipeline Journeyman Welder: \$140.50; and Pipeline Helper: \$64.50. Note: in order to receive the per diem payment an employee must work a minimum of 8 hours in a 24 hour period.

NOTES:

- Journeymen employed as "stringer bead" welders and journeymen who are regularly employed as "hot-pass" welders shall receive \$1.00 per hour more than other journeymen.
- Welders running "stringer bead" or "hot-pass" on "cutouts" or "tie-ins" on a production basis shall be paid \$1.00 per hour above the journeymen rate.
- Whenever a welder helper is employed using a power buffer or power grinder immediately behind the stringer bead and/or hot-pass welders, and the pipe gang is set on a production basis, the helper shall be paid \$2.00 per hour above the helper rate.
- If back welding is performed inside a pipe under either or both of the following conditions, the welder engaged in the welding will receive \$3.00 per hour above the regular rate for the job only for the days on which such back welding is performed:
 - The employer elects, as a regular procedure, to back weld each line-up. This condition is not intended to apply to occasional back welding performed by the pipe gang to repair a bead, to rectify a "high-lo" condition or wall thickness, etc.
 - A welder is required to back weld a completed weld behind the firing line.
- If the welder helper is required to go inside the pipe for the purpose of brushing, buffing and grinding the weld, they shall receive a wage rate \$1.00 per hour above the regular helper rate for the days involved.
- Welders working on "hot work" shall be paid \$2.00 per hour above the regular rate for each day engaged in such work. "Hot work" is defined as work on lines in service where there is the danger of fire or explosion.

The regular workday shall be 8 hours, between 8:00 AM and 4:30 PM.

OVERTIME:

Hours in excess of 8 per day, and all hours on Sundays shall be paid at time and one-half the regular rate, inclusive of benefits. All hours on holidays shall be paid at double the regular rate, inclusive of benefits.

RECOGNIZED HOLIDAYS: New Year's Day, July 4th, Labor Day, Thanksgiving Day, and Christmas Day. Sunday holidays observed the following Monday.

Effective Dates:

06/13/2024

Rate	Fringe	Total
57.34	35.90	93.24

CLASSIFICATIONS:

Pipeline Journeyman Welder

TERRITORY
ENTIRE STATE

NEW JERSEY DEPARTMENT OF LABOR AND WORKFORCE DEVELOPMENT
PREVAILING WAGE RATE DETERMINATION

PIPELINE - MAINLINE TRANSMISSION Rates Expiration Date :

Effective Dates:

06/13/2024

Rate	Fringe	Total
57.34	35.90	93.24

CLASSIFICATIONS:

Pipeline Journeyman

Effective Dates:

06/13/2024

Rate	Fringe	Total
33.84	25.02	58.86

CLASSIFICATIONS:

Pipeline Helper

PIPELINE - GAS DISTRIBUTION **Rates Expiration Date :**

These rates apply to the following: welding on gas line distribution systems (that portion of the gas distribution system placed in streets, roads, subways, tunnels, viaducts, highways and easements which serves the users of gas).

SHIFT DIFFERENTIALS:

An "irregular" shift may start any time from 5:00 PM to 12:00 AM, Monday through Friday, and shall receive an additional 15% of the regular rate per hour, inclusive of benefits.

OVERTIME:

Hours in excess of forty per week, and all hours on Saturdays shall be paid at time and one-half the regular rate, inclusive of benefits. All hours on Sundays and holidays shall be paid at double the regular rate, inclusive of benefits.

RECOGNIZED HOLIDAYS: New Year's Day, Memorial Day, July 4th, Labor Day, Thanksgiving Day, and Christmas Day. Sunday holidays observed the following Monday.

Effective Dates:

11/04/2024

Rate	Fringe	Total
64.70	34.74	99.44

CLASSIFICATIONS:

Pipeline Journeyman Welder

Effective Dates:

11/04/2024

Rate	Fringe	Total
64.70	34.74	99.44

CLASSIFICATIONS:

Pipeline Journeyman

Effective Dates:

11/04/2024

Rate	Fringe	Total
41.73	24.77	66.50

CLASSIFICATIONS:

Pipeline Helper

ASPHALT LABORERS- NORTH **Rates Expiration Date :**

THESE RATES APPLY IN THE FOLLOWING COUNTIES ONLY:

Bergen, Essex, Hudson, Hunterdon, Middlesex, Monmouth, Morris, Passaic, Somerset, Sussex, Union, Warren

{For apprentice rates refer to "Laborer - Heavy & General" apprentice rates in any county rate package}

The regular workday consists of 8 hours, starting at 7:00 AM or 8:00 AM.

SHIFT DIFFERENTIALS:

- Shifts must start at 3:00 PM, 4:00 PM, 12:00 AM, or 1:00 AM, to be considered shift work, except when the project owner mandates special hours of work in the job specifications, in which case those hours may be considered shift work.
- When such hours are mandated by the project owner, a shift that begins before midnight on Friday and ends on Saturday morning, or that begins at or after 8:00 PM on Sunday and ends on Monday morning may be paid at the shift differential rate.
- Shifts shall receive an additional \$3.00 per hour.

OVERTIME:

- Hours in excess of 8 per day, Monday through Friday, or outside of the regular workday that are not shift work, and all hours on Saturdays, shall be paid at time and one-half the hourly rate. All hours on Sundays and holidays shall be paid at double the hourly rate.
- Four 10-hour days may be worked, Monday through Thursday, at straight time, with Friday used as a make-up day for a day lost to inclement weather. If Friday is not a make-up day, all hours on Friday shall be paid at time and one-half the hourly rate.

RECOGNIZED HOLIDAYS: New Year's Day, Presidents' Day, Memorial Day, July 4th, Labor Day, Presidential Election Day, Veterans' Day, Thanksgiving Day, Christmas Day. Sunday holidays observed the following Monday. Veterans Day may be substituted for the day after Thanksgiving. However, in the trading of Veterans Day for the day after Thanksgiving, if overtime is worked on Veterans Day, it shall be paid at double the hourly rate.

Hazardous Waste Work:

- where Level A, B, or C protection is required: + \$5.00/hr
- other Hazardous Waste site: + \$1.00/hr

FOR TIDE WORK (pertains to tidal water): A contractor can start their job according to tide schedules (tide schedules are the various high and low tides related to this work) providing the eight (8) hour shift is completed between the hours of 5:00 AM and 6:30 PM.

Effective Dates:

	11/20/2024		03/01/2025	03/01/2026
Rate	Fringe	Total	Total	Total
53.55	37.33	90.88	94.33	97.58

CLASSIFICATIONS:

Asphalt Foreman

Effective Dates:

	11/20/2024		03/01/2025	03/01/2026
Rate	Fringe	Total	Total	Total
50.25	37.33	87.58	91.03	94.28

CLASSIFICATIONS:

Asphalt Screedman

Effective Dates:

	11/20/2024		03/01/2025	03/01/2026
Rate	Fringe	Total	Total	Total
50.00	37.33	87.33	90.78	94.03

CLASSIFICATIONS:

Asphalt Raker or Lute Man

TERRITORY
ENTIRE STATE

NEW JERSEY DEPARTMENT OF LABOR AND WORKFORCE DEVELOPMENT
PREVAILING WAGE RATE DETERMINATION

ASPHALT LABORERS- NORTH Rates Expiration Date :

Effective Dates:

11/20/2024			03/01/2025	03/01/2026
Rate	Fringe	Total	Total	Total
49.30	37.33	86.63	90.08	93.33

CLASSIFICATIONS:

Asphalt Laborer

Effective Dates:

11/20/2024			03/01/2025	03/01/2026
Rate	Fringe	Total	Total	Total
54.05	37.33	91.38	95.83	100.08

CLASSIFICATIONS:

Certified Asphalt Foreman

ELECTRICIAN- UTILITY WORK (NORTH) **Rates Expiration Date :**

Electrician-Utility Work (North)

(For apprentice rates refer to Electrician-Utility Work (North) in any county rate package).

These rates apply to work contracted for by the following utility companies:

Public Service Electric & Gas Co. of NJ, GPU Energy, Borough of Madison Electric Department, Sussex Rural Electric Cooperative, Rockland Utilities, and Butler Municipal Electric Co.

These rates do not apply to work on substations or switching stations.

For Utility work contracted for by a utility company other than those listed above or those listed under "Electrician-Utility Work (South), see the "Outside Commercial Rates" for the county in which the jobsite is located.

* FOR OUTSIDE COMMERCIAL RATES PLEASE SEE COUNTY RATES

The regular workday is 8 hours, between 6:00 AM and 6:00 PM.

FOR EMERGENCY WORK ONLY: (emergency work is defined as work caused by storm, catastrophe, act of god, and circumstances beyond the control of the employer)-all hours of work shall be paid at double the hourly rate.

SHIFT DIFFERENTIALS:

Shift work must run for a minimum of 5 consecutive workdays.

2nd shift (between the hours of 4:30 PM and 1:00 AM): 8 hours of work + 17.3% of the regular rate, inclusive of benefits.

3rd shift (between the hours of 12:30 AM and 9:00 AM): 8 hours of work + 31.4% of the regular rate per hour, inclusive of benefits.

OVERTIME:

Hours in excess of 8 per day, or before or after the regular workday Monday through Friday, that is not shift work, and all hours on Saturday shall be paid at time and one-half the regular rate, inclusive of benefits. All hours on Sundays and holidays shall be paid at double the hourly rate, inclusive of benefits.

Four 10-hour days may worked, at straight time, between 6:00 AM and 6:00 PM, Monday through Thursday.

RECOGNIZED HOLIDAYS:

New Year's Day, Presidents' Day, Memorial Day, July 4th, Labor Day, Presidential Election Day, Veterans' Day, Thanksgiving Day and Christmas Day, or day on which they are legally observed.

Effective Dates:

12/01/2024

Rate	Fringe	Total
64.83	44.73	109.56

CLASSIFICATIONS:

Chief Lineman

Effective Dates:

12/01/2024

Rate	Fringe	Total
61.16	42.20	103.36

CLASSIFICATIONS:

Journeyman Lineman

ELECTRICIAN- UTILITY WORK (NORTH) Rates Expiration Date :

Effective Dates:

12/01/2024

Rate	Fringe	Total
61.16	42.20	103.36

CLASSIFICATIONS:

Special License Operator

Effective Dates:

12/01/2024

Rate	Fringe	Total
60.55	41.77	102.32

CLASSIFICATIONS:

Transit Man

Effective Dates:

12/01/2024

Rate	Fringe	Total
58.71	40.50	99.21

CLASSIFICATIONS:

Line Equipment Operator

Effective Dates:

12/01/2024

Rate	Fringe	Total
51.37	35.44	86.81

CLASSIFICATIONS:

Dynamite Man

Effective Dates:

12/01/2024

Rate	Fringe	Total
76.45	52.75	129.20

CLASSIFICATIONS:

General Foreman

Effective Dates:

12/01/2024

Rate	Fringe	Total
70.33	48.52	118.85

CLASSIFICATIONS:

Assistant General Foreman

ELECTRICIAN- UTILITY WORK (NORTH) **Rates Expiration Date :**

Effective Dates:

12/01/2024

Rate	Fringe	Total
68.50	47.26	115.76

CLASSIFICATIONS:

Line Foreman

Effective Dates:

12/01/2024

Rate	Fringe	Total
49.54	34.18	83.72

CLASSIFICATIONS:

Street Light Mechanical Leader

Effective Dates:

12/01/2024

Rate	Fringe	Total
47.09	32.49	79.58

CLASSIFICATIONS:

Groundman Winch Operator

Effective Dates:

12/01/2024

Rate	Fringe	Total
47.09	32.49	79.58

CLASSIFICATIONS:

Groundman Truck Operator

Effective Dates:

12/01/2024

Rate	Fringe	Total
46.48	32.07	78.55

CLASSIFICATIONS:

Street Light Mechanic

Effective Dates:

12/01/2024

Rate	Fringe	Total
46.48	32.07	78.55

CLASSIFICATIONS:

Line Equipment Mechanic

TERRITORY
ENTIRE STATE

NEW JERSEY DEPARTMENT OF LABOR AND WORKFORCE DEVELOPMENT
PREVAILING WAGE RATE DETERMINATION

ELECTRICIAN- UTILITY WORK (NORTH) Rates Expiration Date :

Effective Dates:

12/01/2024

Rate	Fringe	Total
39.75	27.42	67.17

CLASSIFICATIONS:

Groundman 2nd Year

Effective Dates:

12/01/2024

Rate	Fringe	Total
36.70	25.32	62.02

CLASSIFICATIONS:

Groundman 1st Year

Effective Dates:

12/01/2024

Rate	Fringe	Total
60.55	41.77	102.32

CLASSIFICATIONS:

Line Equipment Foreman

ELECTRICIAN- UTILITY WORK (SOUTH) **Rates Expiration Date :**

Electrician-Utility Work (South)

(For apprentice rates refer to Electrician-Utility Work (South) in any county rate package).

These rates apply to work contracted for by the following utility company:

Atlantic City Electric.

These rates do not apply to work on substations or switching stations.

For utility work contracted for by a utility company other than the one listed above or those listed under "Electrician-Utility Work (North), see the "Outside Commercial Rates" for the county in which the jobsite is located.

* FOR OUTSIDE COMMERCIAL RATES PLEASE SEE COUNTY RATES

The regular workday is 8 hours, between 7:00 AM and 4:30 PM.

FOR EMERGENCY WORK ONLY: (emergency work is defined as work caused by storm, catastrophe, act of god, and circumstances beyond the control of the employer)- all hours of work shall be paid at double the hourly rate.

SHIFT DIFFERENTIALS:

Shift work must run for a minimum of 5 consecutive workdays.

When two (2) or three (3) shifts are worked the following shall apply:

1st shift (between the hours of 8:00 AM and 4:30 PM)

2nd shift (between the hours of 4:30 PM and 12:30 AM): 8 hours of work + 10% of the regular rate of pay for 7.5 hours worked.

3rd shift (between the hours of 12:30 AM and 8:00 AM): 8 hours of work + 15% of the regular rate of pay for 7 hours worked.

OVERTIME:

Hours in excess of 8 per day, or before or after the regular workday Monday through Friday, that is not shift work, and all hours on Saturday shall be paid at time and one-half the regular rate. All hours on Sundays and Holidays shall be paid double the hourly rate.

Four 10-hour days may be worked, at straight time, between 6:00 AM and 6:00 PM, Monday through Thursday with Friday used as a make-up day.

RECOGNIZED HOLIDAYS:

New Year's Day, Memorial Day, July 4th, Labor Day, Veterans' Day, Thanksgiving Day and Christmas Day or on days celebrated.

WORKING RULES:

There shall be a Foreman in charge of each work crew. No crews are to exceed twelve (12) men, including Foremen.

There shall be a General Foreman designated for transmission work when three (3) or more crews are on the same job and for distribution work where there are more than twenty (20) employees on site.

A small job crew shall consist of five (5) or less employees, one (1) of the Journeyman Linemen in the crew shall be designated as a Small Job Foreman.

Work performed from ladders and/or mechanical lift equipment shall be the work of Linemen and/or Apprentices.

On new construction, fitting and framing poles, towers or structures may be done by Journeymen and/or Apprentices. Groundmen may assist, but may not perform any work which would be performed by Linemen if assembled in the air.

There shall be a Journeyman Lineman in each pole setting, erection, grounding, wire and cable-pulling crew of more than three (3) men.

Effective Dates:

12/01/2024

Rate	Fringe	Total
71.87	59.12	130.99

CLASSIFICATIONS:

General Foreman

ELECTRICIAN- UTILITY WORK (SOUTH) Rates Expiration Date :

Effective Dates:

12/01/2024

Rate	Fringe	Total
64.01	54.22	118.23

CLASSIFICATIONS:

Foreman

Effective Dates:

12/01/2024

Rate	Fringe	Total
60.64	52.12	112.76

CLASSIFICATIONS:

Small Job Foreman

Effective Dates:

12/01/2024

Rate	Fringe	Total
56.15	49.33	105.48

CLASSIFICATIONS:

Heavy Equipment Operator

Effective Dates:

12/01/2024

Rate	Fringe	Total
56.15	49.33	105.48

CLASSIFICATIONS:

Cable Splicer

Effective Dates:

12/01/2024

Rate	Fringe	Total
56.15	49.33	105.48

CLASSIFICATIONS:

Journeyman Lineman

Effective Dates:

12/01/2024

Rate	Fringe	Total
56.15	49.33	105.48

CLASSIFICATIONS:

Journeyman Welder

ELECTRICIAN- UTILITY WORK (SOUTH) Rates Expiration Date :

Effective Dates:

12/01/2024

Rate	Fringe	Total
56.15	49.33	105.48

CLASSIFICATIONS:

Journeyman Painter

Effective Dates:

12/01/2024

Rate	Fringe	Total
44.92	42.36	87.28

CLASSIFICATIONS:

Light Equipment Operator

Effective Dates:

12/01/2024

Rate	Fringe	Total
39.31	38.86	78.17

CLASSIFICATIONS:

Groundman Truck Driver

Effective Dates:

12/01/2024

Rate	Fringe	Total
36.50	37.12	73.62

CLASSIFICATIONS:

Groundman 3rd Year

Effective Dates:

12/01/2024

Rate	Fringe	Total
33.69	35.37	69.06

CLASSIFICATIONS:

Groundman 2nd Year

Effective Dates:

12/01/2024

Rate	Fringe	Total
30.88	33.62	64.50

CLASSIFICATIONS:

Groundman 1st Year

TERRITORY
ENTIRE STATE

NEW JERSEY DEPARTMENT OF LABOR AND WORKFORCE DEVELOPMENT
PREVAILING WAGE RATE DETERMINATION

ELECTRICIAN- UTILITY WORK (SOUTH) Rates Expiration Date :

Effective Dates:

12/01/2024

Rate	Fringe	Total
24.71	29.80	54.51

CLASSIFICATIONS:

Flagman

HEAVY & GENERAL LABORERS- NEW TRANS HUDSON TUNNELS Rates Expiration Date :

****THESE RATES APPLY TO CONSTRUCTION ON NEW TRANS HUDSON TUNNELS ONLY****

{For apprentice rates refer to "Laborer - Heavy & General" apprentice rates in any county rate package}

The regular workday consists of 8 hours, starting at 7:00 AM or 8:00 AM.

SHIFT DIFFERENTIALS:

- Shifts must start at 3:00 PM, 4:00 PM, 12:00 AM, or 1:00 AM, to be considered shift work, except when the project owner mandates special hours of work in the job specifications, in which case those hours may be considered shift work.
- When such hours are mandated by the project owner, a shift that begins before midnight on Friday and ends on Saturday morning, or that begins at or after 8:00 PM on Sunday and ends on Monday morning may be paid at the shift differential rate.
- Shifts shall receive an additional \$3.00 per hour.

OVERTIME:

- Hours in excess of 8 per day, Monday through Friday, or outside of the regular workday that are not shift work, and all hours on Saturdays, shall be paid at time and one-half the hourly rate. All hours on Sundays and holidays shall be paid at double the hourly rate.
- Four 10-hour days may be worked, Monday through Thursday, at straight time, with Friday used as a make-up day for a day lost to inclement weather. If Friday is not a make-up day, all hours on Friday shall be paid at time and one-half the hourly rate.

RECOGNIZED HOLIDAYS: New Year's Day, Presidents' Day, Memorial Day, July 4th, Labor Day, Presidential Election Day, Veterans' Day, Thanksgiving Day, Christmas Day. Sunday holidays observed the following Monday. Veterans Day may be substituted for the day after Thanksgiving. However, in the trading of Veterans Day for the day after Thanksgiving, if overtime is worked on Veterans Day, it shall be paid at double the hourly rate.

Hazardous Waste Work:

- where Level A, B, or C protection is required: + \$5.00/hr
- other Hazardous Waste site: + \$1.00/hr

Traffic Control Coordinator: When either of the work classifications found below are working as a Traffic Control Coordinator they are to receive \$.75 above their current rate of pay.

Effective Dates:

	04/17/2024		03/01/2025	03/01/2026
Rate	Fringe	Total	Total	Total
78.08	37.33	115.41	119.68	123.81

CLASSIFICATIONS:

Walking Boss & Superintendent

Effective Dates:

	04/17/2024		03/01/2025	03/01/2026
Rate	Fringe	Total	Total	Total
77.63	37.33	114.96	119.23	123.36

CLASSIFICATIONS:

Heading Foreman, Shaft Foreman, Rod Foreman, Electrical Foreman, Rigging Foreman

HEAVY & GENERAL LABORERS- NEW TRANS HUDSON TUNNELS **Rates Expiration Date :**

Effective Dates:

	04/17/2024		03/01/2025	03/01/2026
Rate	Fringe	Total	Total	Total
76.88	37.33	114.21	118.48	122.61

CLASSIFICATIONS:

Iron Foreman, Caulking Foreman, Form Foreman, Cement Finishing Foreman, Concrete Foreman, Track Foreman, Clean-up Foreman, Grout Foreman

Effective Dates:

	04/17/2024		03/01/2025	03/01/2026
Rate	Fringe	Total	Total	Total
80.63	37.33	117.96	122.23	126.36

CLASSIFICATIONS:

Blaster

Effective Dates:

	04/17/2024		03/01/2025	03/01/2026
Rate	Fringe	Total	Total	Total
76.05	37.33	113.38	117.66	121.78

CLASSIFICATIONS:

Top Labor Foreman

Effective Dates:

	04/17/2024		03/01/2025	03/01/2026
Rate	Fringe	Total	Total	Total
75.53	37.33	112.86	117.13	121.26

CLASSIFICATIONS:

Skilled Men (including Caulker, Powder Carrier, all other skilled men)

Skilled Men (including Miner, Drill Runner, Iron Man, Conveyor Man, Maintenance Man, Safety Miner, Rigger, Block Layer, Cement Finisher, Rod Man)

Effective Dates:

	04/17/2024		03/01/2025	03/01/2026
Rate	Fringe	Total	Total	Total
75.30	37.33	112.63	116.91	121.03

CLASSIFICATIONS:

Semi-Skilled Men (including Bell or Signal Man top or bottom, Form Worker & Mover, Concrete Worker, Shaft Man, Tunnel Laborer, Caulker's Helper, all other semi-skilled)

Semi-Skilled Men (including Miner's Helper, Chuck Tender, Track Man, Nipper, Brake Man, Derail Man, Cable Man, Hose Man, Gravel Man, Form Man)

TERRITORY
ENTIRE STATE

NEW JERSEY DEPARTMENT OF LABOR AND WORKFORCE DEVELOPMENT
PREVAILING WAGE RATE DETERMINATION

HEAVY & GENERAL LABORERS- NEW TRANS HUDSON TUNNELS Rates Expiration Date :

Effective Dates:

	04/17/2024		03/01/2025	03/01/2026
Rate	Fringe	Total	Total	Total
74.70	37.33	112.03	116.31	120.43

CLASSIFICATIONS:

All others (including Powder Watchman, Change House Attendant, Top Laborer, Job Steward)